

DATE: _____ BY: _____
 SURVEYED: _____ PLOTTED: _____ CHECKED: _____
 NOTE BOOK: _____ INT. OF WAY: _____
 NO. _____ PLOTTED FILE NAME: _____

DATE: _____ BY: _____
 SURVEYED: _____ PLOTTED: _____ CHECKED: _____
 NOTE BOOK: _____ INT. OF WAY: _____
 NO. _____ PLOTTED FILE NAME: _____

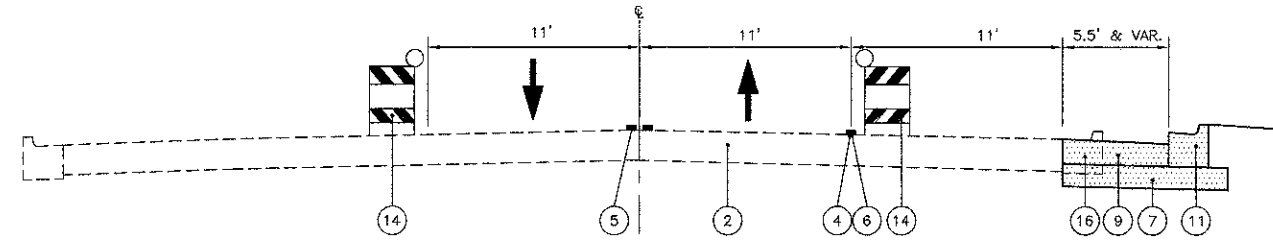

U.S. ROUTE 14 - STAGE 1A

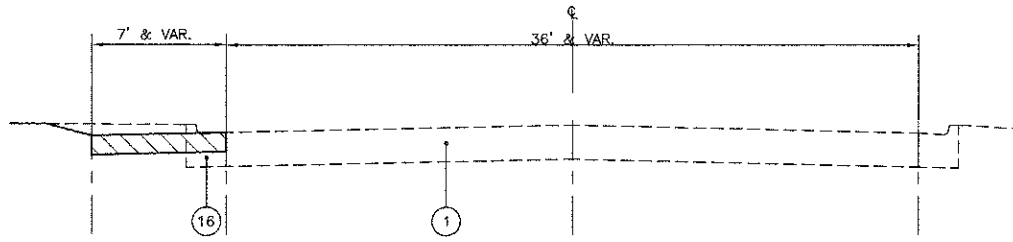

DAVIS ST. & ARTHUR AVE. - PRE-STAGE 1

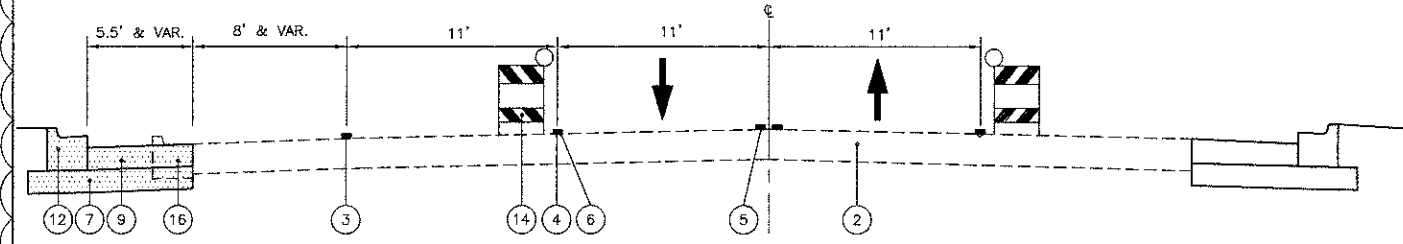

U.S. ROUTE 14 - STAGE 1B

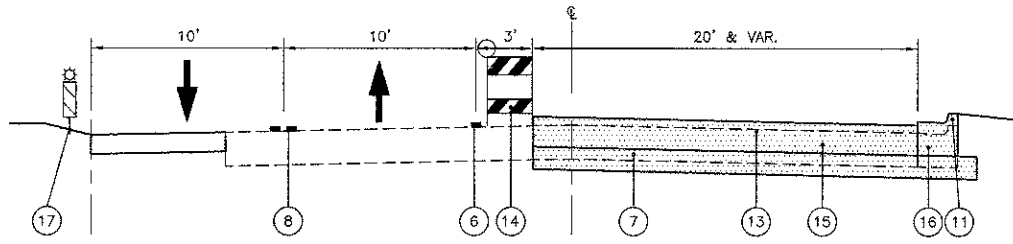

DAVIS ST. & ARTHUR AVE. - STAGE 1

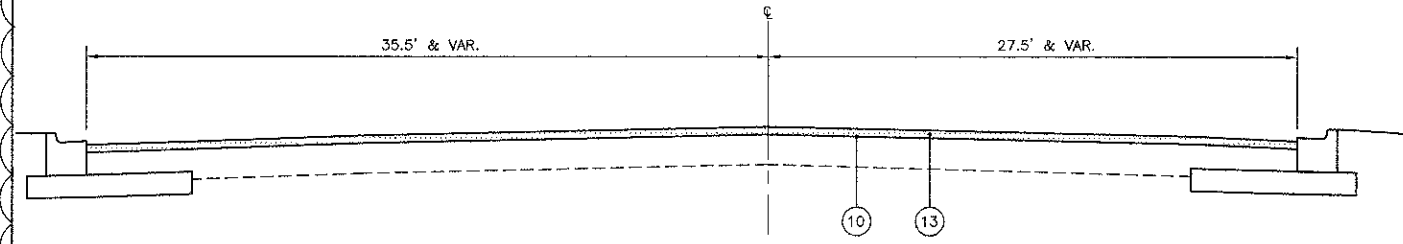

U.S. ROUTE 14 - STAGE 2

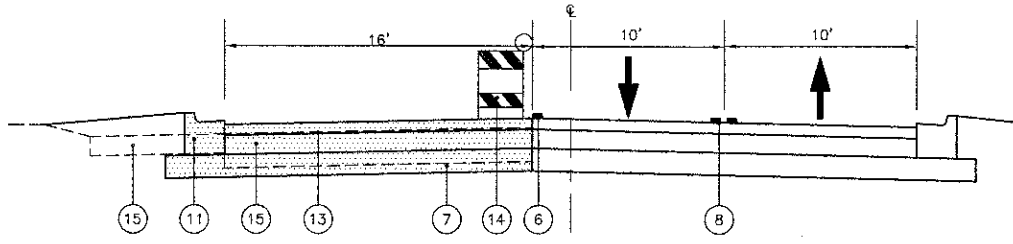

DAVIS ST. & ARTHUR AVE. - STAGE 2

LEGEND

- ① EXISTING BITUMINOUS PAVEMENT
- ② EXISTING CONCRETE PAVEMENT
- ③ EXISTING PAVEMENT MARKING (WHITE SOLID LINE)
- ④ EXISTING PAVEMENT MARKING (WHITE SKIP-DASH LINE)
- ⑤ EXISTING PAVEMENT MARKING (DOUBLE YELLOW LINE)
- ⑥ PROP. TEMPORARY PAVEMENT MARKING 4" WHITE (LINE)
- ⑦ PROP. AGGREGATE SUBGRADE IMPROVEMENT 12"
- ⑧ PROP. TEMPORARY PAVEMENT MARKING 4" YELLOW (DOUBLE LINE)
- ⑨ PROP. P.C. CONCRETE BASE COURSE, 10"
- ⑩ PROP. LEVELING BINDER, (MACHINE METHOD) N70 VAR. THICKNESS
- ⑪ PROP. COMB. CONCRETE CURB & GUTTER, TYPE B-6.18
- ⑫ PROP. COMB. CONCRETE CURB & GUTTER, TYPE M-4.1B
- ⑬ PROP. HOT-MIX ASPHALT BINDER COURSE, IL-19, N70 (6 1/4")
- ⑭ TYPE II BARRICADE (NON-METALLIC) W/ STEADY-BURN LIGHT
- ⑮ PAVEMENT REMOVAL
- ⑯ COMBINATION CURB & GUTTER REMOVAL
- ⑰ DOUBLE VERTICAL PANELS AND BI-DIRECTIONAL LIGHTING

- ➔ DIRECTION OF SINGLE LANE OF THRU TRAFFIC DURING STAGE
- ▨ TEMPORARY PAVEMENT WIDENING
- ▩ PERMANENT CONSTRUCTION DURING STAGE
- *HOT-MIX ASPHALT BINDER COURSE, 8" WITH NO SURFACE COURSE.
- **SEE TYPICAL SECTIONS AND PLAN AND PROFILE SHEETS

NOTE "A": CROSSING SHALL BE CLOSED AT THE DIRECTION OF THE UNION PACIFIC RAILROAD AND ENGINEER, AND REMAIN CLOSED DURING CONSTRUCTION UNTIL COMPLETED FULL-WIDTH ACROSS THE TRACKS, TO INCLUDE ALL PERMANENT LANE CONFIGURATIONS AND THE ASSOCIATED PERMANENT SIGNAL AND RAILROAD WARNING DEVICE SYSTEMS HAVE BEEN COMPLETED. AT LEAST ONE WEEK PRIOR TO CLOSING, TEMPORARY INFORMATION SIGNS SHALL BE ERRECTED AT LOCATIONS DESIGNATED BY THE ENGINEER. OPENING OF THE CROSSING SHALL NOT OCCUR UNTIL THE PERMANENT TRAFFIC SIGNAL AND RAILROAD WARNING DEVICES HAVE BEEN INSPECTED BY APPROPRIATE AGENCIES. (SEE DETAIL "A"). WHEN A GRADE CROSSING EXISTS EITHER WITHIN OR IN THE VICINITY OF A TEMPORARY TRAFFIC CONTROL ZONE, LANE RESTRICTIONS, FLAGGING, OR OTHER OPERATIONS SHALL NOT BE PERFORMED IN A MANNER THAT WOULD CAUSE HIGHWAY VEHICLES TO STOP ON THE RAILROAD OR LRT TRACKS, UNLESS A FLAGGER OR UNIFORMED LAW ENFORCEMENT OFFICER IS PROVIDED AT THE GRADE CROSSING TO MINIMIZE THE POSSIBILITY OF HIGHWAY VEHICLES STOPPING ON THE TRACKS, EVEN IF AUTOMATIC WARNING DEVICES ARE IN PLACE.

NOTE "B": THE CONTRACTOR'S ATTENTION IS DIRECTED TO THE DEPARTMENT'S INTENT TO KEEP US ROUTE 14 OPEN FOR ALL TRAFFIC AT ALL TIMES, EXCEPT DURING CONSTRUCTION OPERATIONS.

DURING CONSTRUCTION OPERATIONS, AT LEAST ONE THROUGH LANE FOR EACH DIRECTION OF TRAFFIC SHALL BE MAINTAINED ALONG THE ROADWAYS AT ALL TIMES, AND US ROUTE 14 LEFT TURN LANES SHALL BE MAINTAINED FOR APPROACHES AT THE INTERSECTION OF PRINDLE AVENUE AND ARTHUR AVENUE. ANY SHORT TERM CONSTRUCTION ACTIVITY THAT REQUIRES ENCROACHMENT ON THE LANES OPEN FOR TRAFFIC SHALL BE RESTRICTED TO WITHIN THE HOURS OF 9:00 A.M. TO 3:00 P.M. LANE CLOSURES SHALL BE IN ACCORDANCE WITH THE APPLICABLE I.D.O.T. TRAFFIC CONTROL STANDARDS.

CONSTRUCTION SEQUENCE

THE CONTRACTOR SHALL CONTACT THE DISTRICT ONE TRAFFIC CONTROL SUPERVISOR @ (847) 705-4470 A MINIMUM OF 72 HOURS IN ADVANCE OF BEGINNING WORK.

- PRE-STAGE 1**
1. ERECT ALL ADVANCED CONSTRUCTION SIGNING.
 2. ERECT DETOUR SIGNS AND ACTIVATE DETOUR. (SEE NOTE "A")
 3. ERECT TYPE II BARRICADES AND CLOSE ARTHUR AVENUE R.R. CROSSING. (SEE NOTE "A")
 4. TURN OFF AND COVER TRAFFIC SIGNALS AT ARTHUR AVENUE INTERSECTIONS WITH U.S. ROUTE 14 AND DAVIS STREET, MOVE FIRE HYDRANT AND INSTALL TEMPORARY SIGNALS AND LIGHTING.
 5. REMOVE CURB AND GUTTER, MOVE FIRE HYDRANTS, AND CONSTRUCT TEMPORARY PAVEMENT WIDENING ON NORTH SIDE OF DAVIS STREET AND WEST SIDE OF ARTHUR AVENUE.
 6. REMOVE RAISED REFLECTIVE PAVEMENT MARKERS ON U.S. ROUTE 14
 7. REMOVE CONFLICTING PAVEMENT MARKINGS AND PLACE TEMPORARY MARKINGS. ERECT BARRICADES AND TEMPORARY TRAFFIC SIGNS AND SHIFT TRAFFIC. (SEE NOTE "B")

- STAGE 1A AND B**
1. INSTALL DRAINAGE STRUCTURES AND CONSTRUCT PAVEMENT WIDENING AND MEDIAN REPLACEMENT, CURB AND GUTTER AND SIDEWALKS ON U.S. ROUTE 14.
 2. INSTALL DRAINAGE STRUCTURES AND CONSTRUCT BASE COURSE, BINDER COURSE, CURB AND GUTTER, DRIVEWAYS AND SIDEWALKS ON SOUTH SIDE OF DAVIS STREET AND EAST SIDE OF ARTHUR AVENUE.
 3. CONSTRUCT TEMPORARY PAVEMENT WIDENING AT TWO LOCATIONS ON SOUTH SIDE OF DAVIS STREET.
 4. BEGIN TRAFFIC SIGNAL WORK AT ARTHUR AVENUE INTERSECTIONS WITH U.S. ROUTE 14 AND DAVIS STREET (WEST).
 5. REMOVE CONFLICTING PAVEMENT MARKINGS, BARRICADES AND TEMPORARY SIGNS ON U.S. ROUTE 14. PLACE TEMPORARY PAVEMENT MARKINGS AS DIRECTED BY THE ENGINEER AND RE-OPEN ALL LANES TO TRAFFIC.
 6. REMOVE CONFLICTING PAVEMENT MARKINGS AND PLACE TEMPORARY MARKINGS, RELOCATE BARRICADES, ADJUST TEMPORARY SIGNING AND SHIFT TRAFFIC ON DAVIS STREET AND ARTHUR AVENUE.

- STAGE 2**
1. PLACE LEVELING BINDER AND BINDER COURSE ON U.S. ROUTE 14, MAINTAINING TRAFFIC AS PER STANDARD 701427, AND PLACE TEMPORARY PAVEMENT MARKING TAPE AS REQUIRED (NOT ILLUSTRATED).
 2. INSTALL DRAINAGE STRUCTURES AND CONSTRUCT BASE COURSE AND BINDER COURSE, CURB AND GUTTER, DRIVEWAYS AND SIDEWALK ON NORTH SIDE OF DAVIS STREET AND WEST SIDE OF ARTHUR AVENUE.
 3. REMOVE TEMPORARY PAVEMENT WIDENING AND REPLACE CURB AND GUTTER ON WEST SIDE OF ARTHUR AVENUE SOUTH OF STA. 904+75.
 4. REMOVE CONFLICTING PAVEMENT MARKINGS, BARRICADES AND TEMPORARY SIGNS ON DAVIS STREET AND ARTHUR AVENUE, PLACE TEMPORARY PAVEMENT MARKINGS AS DIRECTED BY THE ENGINEER AND RE-OPEN ALL LANES TO TRAFFIC. (NOTE: ARTHUR AVENUE R.R. CROSSING SHALL REMAIN CLOSED.)

- STAGE 3 (NOT ILLUSTRATED)**
1. PLACE SURFACE COURSE TO FINISHED GRADE ON U.S. ROUTE 14, MAINTAINING TRAFFIC AS PER STANDARD 701427, AND PLACE TEMPORARY PAVEMENT MARKING TAPE AS REQUIRED.
 2. CONSTRUCT REMAINING BASE COURSE AND BINDER COURSE AT EASTERLY INTERSECTION OF DAVIS STREET AND ARTHUR AVENUE.
 3. REMOVE TEMPORARY PAVEMENT WIDENING AND REPLACE CURB AND GUTTER AT TWO LOCATIONS ON SOUTH SIDE OF DAVIS STREET.
 4. PLACE SURFACE COURSE TO FINISHED GRADE ON DAVIS STREET AND ARTHUR AVENUE, MAINTAINING TRAFFIC AS PER STANDARD 701501, AND PLACE TEMPORARY PAVEMENT MARKING TAPE AS REQUIRED.
 5. COMPLETE TRAFFIC SIGNAL INSTALLATION AT ARTHUR AVENUE INTERSECTIONS WITH U.S. ROUTE 14 AND DAVIS AVENUE (WEST).
 6. INSTALL ALL PERMANENT PAVEMENT MARKINGS AND RAISED REFLECTIVE PAVEMENT MARKERS.
 7. REMOVE BARRICADES AND ACTIVATE TRAFFIC SIGNALS AT ARTHUR AVENUE INTERSECTIONS WITH U.S. ROUTE 14 AND DAVIS STREET (WEST), AND RE-OPEN R.R. CROSSING. (NOTE: THIS STEP IS CONTINGENT UPON COMPLETION OF ALL CONSTRUCTION WORK BY THE U.P.R.R., AND REQUIRES CLOSE COORDINATION WITH THE RAILROAD.)
 8. COMPLETE PROPOSED STREET LIGHTING WORK.
 9. REMOVE DETOUR SIGNS AND ALL TEMPORARY PAVEMENT MARKINGS AND CONSTRUCTION SIGNS.
 10. COMPLETE ALL LANDSCAPING AND CLEAN-UP WORK.



DESIGNED - RTM	REVISED - 42/28/2012
DRAWN - JRR	REVISED -
CHECKED - RTM	REVISED -
DATE - 10/22/12	REVISED -

STATE OF ILLINOIS
DEPARTMENT OF TRANSPORTATION

NOT TO SCALE

SUGGESTED CONSTRUCTION PROCEDURE
TYPICAL SECTIONS

F.A.D. RTE.	SECTION	COUNTY	TOTAL SHEETS	SHEET NO.
3512	02-00177-00 WR	COOK	142	36
PROJECT NO. M-80031426		CONTRACT NO. 63514		
FED. ROAD DIST. NO. 1 ILLINOIS FED. AID PROJECT				

SHEET NO. 1 OF 1 SHEETS