

PLAN	DATE
BY	
CHECKED	
NOTES	
NO.	
FILE NAME	

PROFILE	DATE
BY	
CHECKED	
NOTES	
NO.	
FILE NAME	

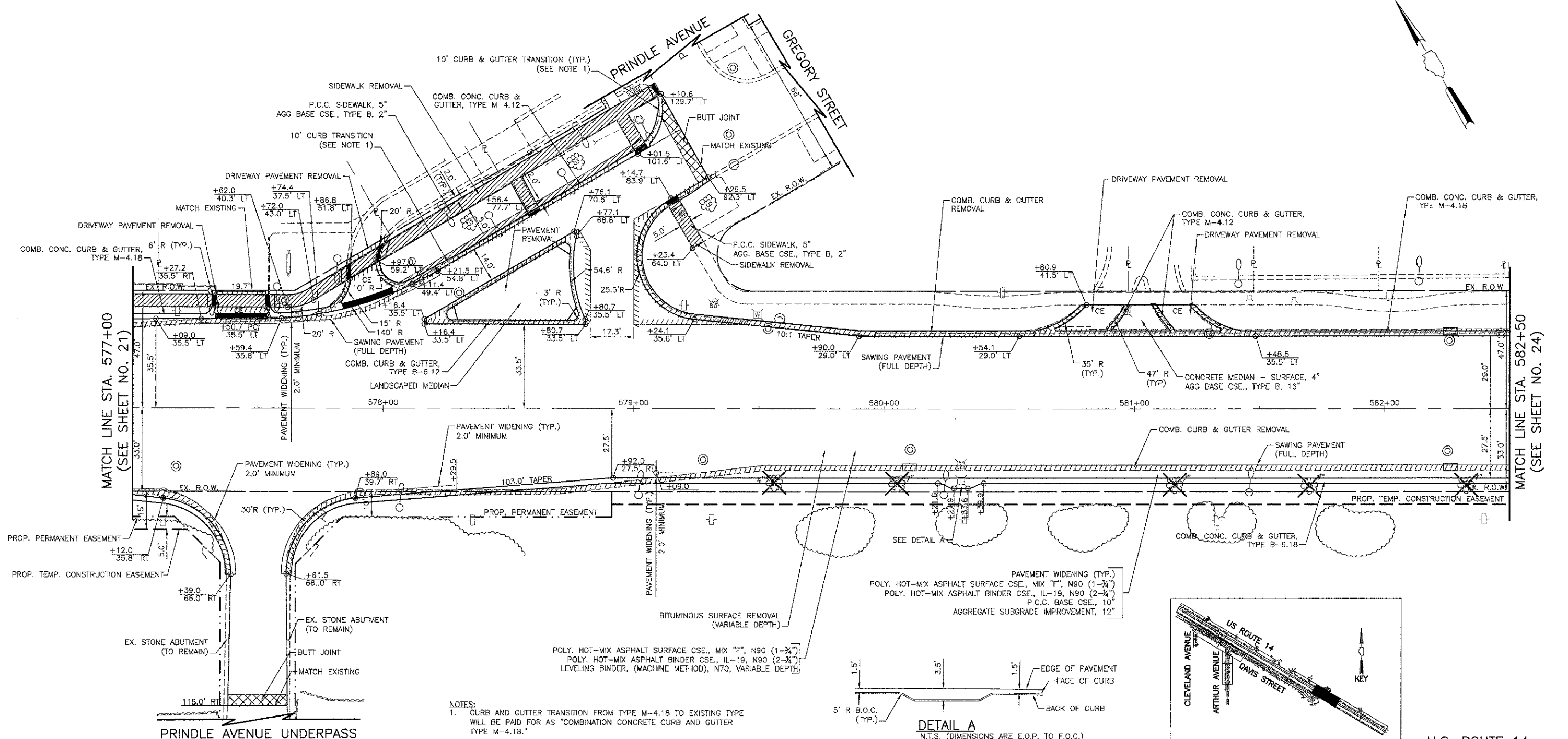

NOTES:
 1. CURB AND GUTTER TRANSITION FROM TYPE M-4.18 TO EXISTING TYPE WILL BE PAID FOR AS "COMBINATION CONCRETE CURB AND GUTTER TYPE M-4.18."

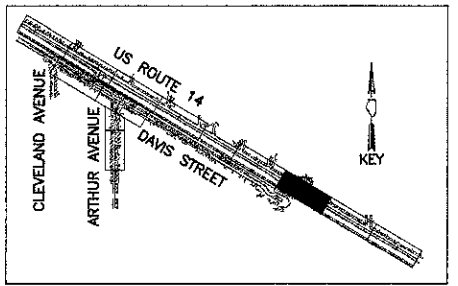
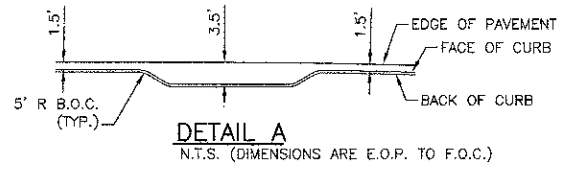

675	670	665	577+00	+25	+50	+75	578+00	+25	+50	+75	579+00	+25	+50	580+00	+50	+75	581+00	+25	+50	+75	582+00	+25	+50	582+50		
EXISTING BASELINE ELEVATION			PROPOSED P.G.L. ELEVATION																							
MATCH LINE STA. 577+00 (SEE SHEET NO. 21)			MATCH LINE STA. 582+50 (SEE SHEET NO. 24)																							
670.79			670.79																							
670.99			670.99																							
671.00			671.00																							
670.80			670.80																							
671.06			671.06																							
671.12			671.12																							
671.13			671.13																							
671.12			671.12																							
670.73			670.73																							
671.06			671.06																							
671.00			671.00																							
670.71			670.71																							
670.98			670.98																							
671.00			671.00																							
670.84			670.84																							
671.06			671.06																							
670.85			670.85																							
671.21			671.21																							
670.90			670.90																							
671.36			671.36																							
671.43			671.43																							
671.16			671.16																							
671.53			671.53																							
671.68			671.68																							
671.58			671.58																							
671.87			671.87																							
672.11			672.11																							
672.16			672.16																							
672.40			672.40																							
672.73			672.73																							
672.81			672.81																							



USER NAME = #USER#
 DESIGNED - RTM
 DRAWN - JRR
 CHECKED - RTM
 DATE - 10/22/12

REVISOR -
 REVISED -
 REVISOR -
 REVISED -

STATE OF ILLINOIS
 DEPARTMENT OF TRANSPORTATION

VERT. 0 5 10
 HORIZ. 0 20 40
 SCALE IN FEET

PLAN AND PROFILE - U.S. ROUTE 14 EAST

F.A.U. RTE.	SECTION	COUNTY	TOTAL SHEETS	SHEET NO.
3512	02-00177-00 WR	COOK	142	23
PROJECT NO. M-8003(426)		CONTRACT NO. 63514		
FED. ROAD DIST. NO. 1 ILLINOIS FED. AID PROJECT				

SHEET NO. 6 OF 12 SHEETS STA. 577+00 TO STA. 582+50