

15 STA. 576+06.5, 25.2' RT.  
INLET TA T23F&G  
RIM EL. = 670.56  
INV. EL. = 667.22

14 4" - STORM SEW CL A 1, 12" @ 5.00%  
T.B.F. = 2 CU. YD.

16 STA. 574+80.0, 23.5' RT.  
INLET TA T23F&G  
RIM EL. = 671.20  
INV. EL. = 668.62

15 42" - STORM SEW CL A 1, 12" @ 3.00%  
10" - STORM SEW WM REQ, 12" @ 3.00%  
T.B.F. = 12 CU. YD.

17 STA. 574+80.0, 31.5' LT.  
CB ADJ NEW T23F&G  
RIM EL. = 670.16  
INV. EL. = 668.80 (E)  
INV. EL. = 667.06 (SW)

NOTES:

1. THE WATERMAIN SHALL BE RELOCATED IF A CONFLICT EXISTS WITH A PROPOSED STORM SEWER. PAID FOR AS "REMOVE AND RELOCATE WATERMAIN".

DATE	
BY	
REVISIONS	
NO.	DESCRIPTION
1	AS SHOWN

DATE	
BY	
REVISIONS	
NO.	DESCRIPTION
1	AS SHOWN

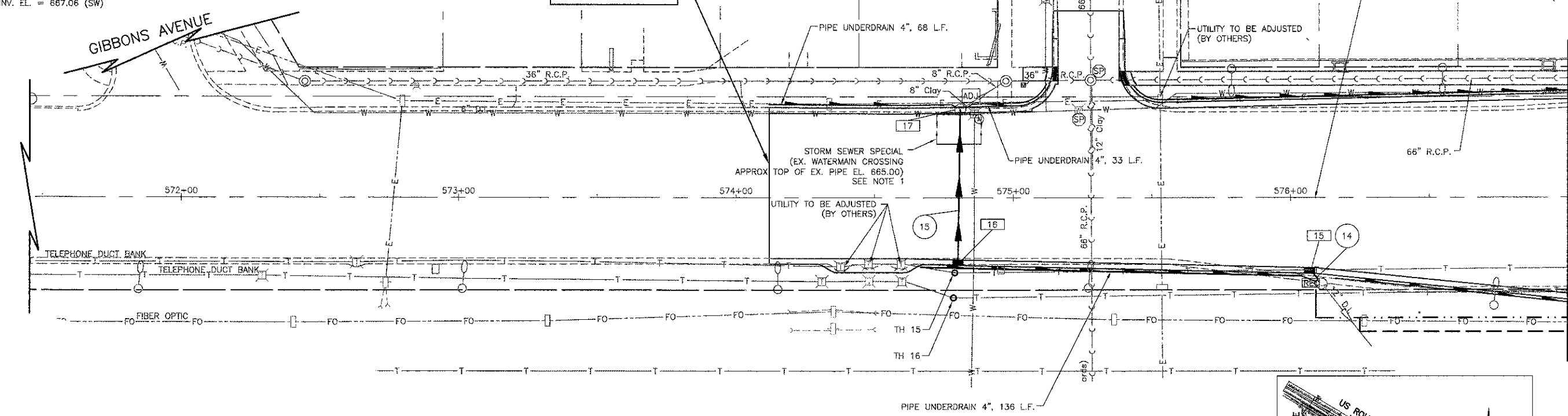

TEST HOLES (TH)

TH	STATION	OFFSET	TOP OF UTILITY ELEV.
15	574+78.90	27.05 RT	666.92
16	574+78.40	36.05 RT	667.09

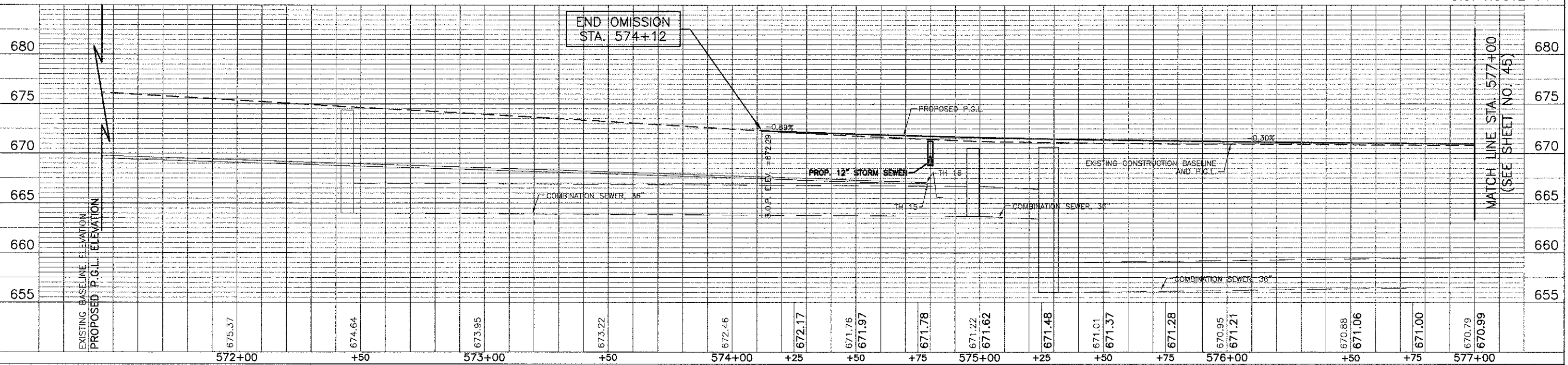
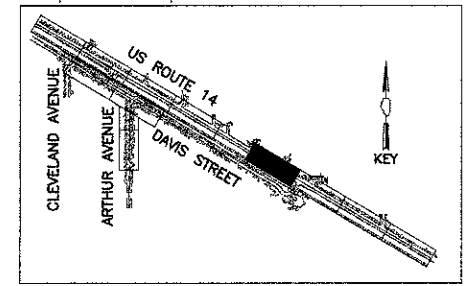

USER NAME = #USER#	DESIGNED - RTM	REVISED -
PLOT SCALE = #SCALE#	DRAWN - JRR	REVISED -
PLOT DATE = #DATE#	CHECKED - RTM	REVISED -
	DATE - 10/22/12	REVISED -

STATE OF ILLINOIS  
DEPARTMENT OF TRANSPORTATION

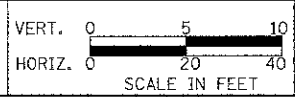

DRAINAGE AND UTILITIES - U.S. ROUTE 14 EAST  
SHEET NO. 5 OF 12 SHEETS | STA. 574+12 TO STA. 577+00

F.A.I.D. RTE. 3512	SECTION 02-00177-00 WR	COUNTY COOK	TOTAL SHEETS 142	SHEET NO. 44
PROJECT NO. M-8003(426)		CONTRACT NO. 63514		
FED. ROAD DIST. NO. 1   ILLINOIS FED. AID PROJECT				