

- NOTES:
- CONNECT/EXTEND BOTH EXISTING 6" UNDERDRAIN PIPES TO STRUCTURE S-10. WORK TO BE PAID FOR AS PIPE UNDERDRAINS 6" (FOOT).
 - EXPOSE EXISTING GAS LINES AT LOCATIONS WHERE THEY CROSS PROPOSED STORM SEWER, PRIOR TO INSTALLING STORM SEWER PIPE. WORK TO BE PAID FOR AS EXPLORATION TRENCH 52" (FOOT).
 - STRUCTURE NO. 22 IS A 5' CATCH BASIN IN ORDER TO PROVIDE SPACE BETWEEN THE STORM SEWER AND PROPOSED LIGHT POLE AT STA. 69+87, 23.5' RT. STRUCTURE NO. 22 AND PROPOSED STORM SEWER SHALL BE INSTALLED SO THERE IS A MINIMUM OF 0.5' BETWEEN THE EDGE OF THE LIGHTING FOUNDATION AND OUTSIDE OF PIPE.

SEE SHEET 35
MATCHLINE STA. 72+00.00

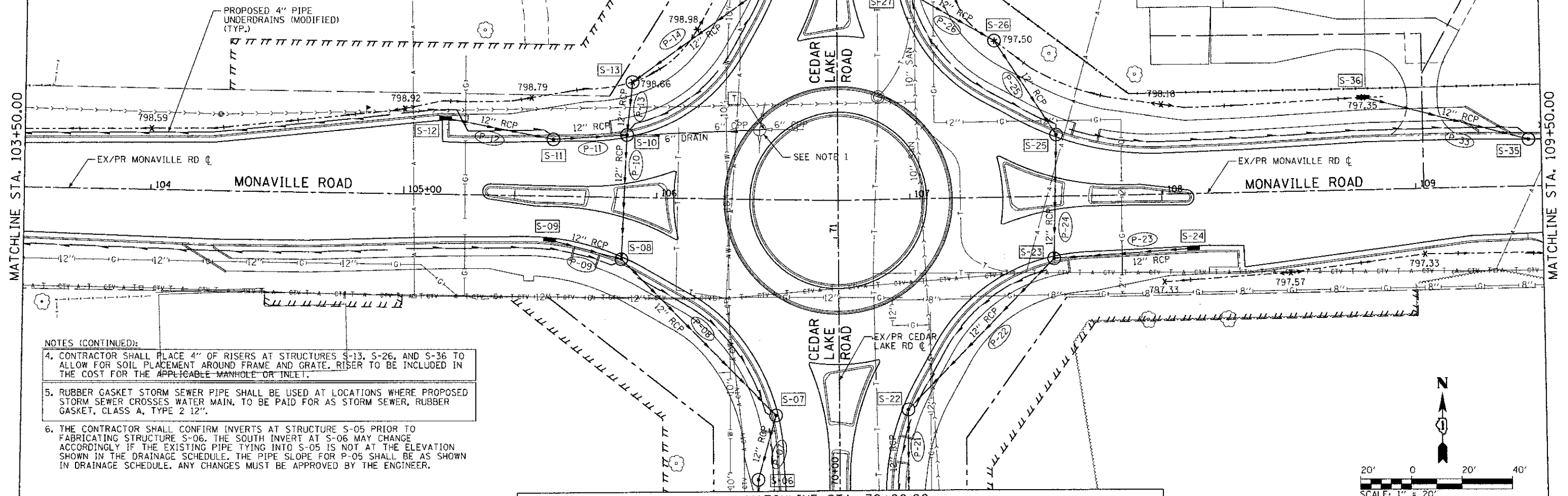

- NOTES (CONTINUED):
- CONTRACTOR SHALL PLACE 4" OF RISERS AT STRUCTURES S-13, S-26, AND S-36 TO ALLOW FOR SOIL PLACEMENT AROUND FRAME AND GRATE. RISER TO BE INCLUDED IN THE COST FOR THE APPLICABLE MANHOLE OR INLET.
 - RUBBER GASKET STORM SEWER PIPE SHALL BE USED AT LOCATIONS WHERE PROPOSED STORM SEWER CROSSES WATER MAIN. TO BE PAID FOR AS STORM SEWER, RUBBER GASKET, CLASS A, TYPE 2 12".
 - THE CONTRACTOR SHALL CONFIRM INVERTS AT STRUCTURE S-05 PRIOR TO FABRICATING STRUCTURE S-06. THE SOUTH INVERT AT S-06 MAY CHANGE ACCORDINGLY IF THE EXISTING PIPE TYING INTO S-05 IS NOT AT THE ELEVATION SHOWN IN THE DRAINAGE SCHEDULE. THE PIPE SLOPE FOR P-05 SHALL BE AS SHOWN IN DRAINAGE SCHEDULE. ANY CHANGES MUST BE APPROVED BY THE ENGINEER.

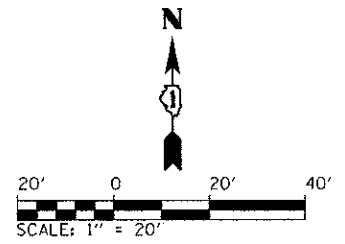

MATCHLINE STA. 70+00.00
SEE SHEET 34

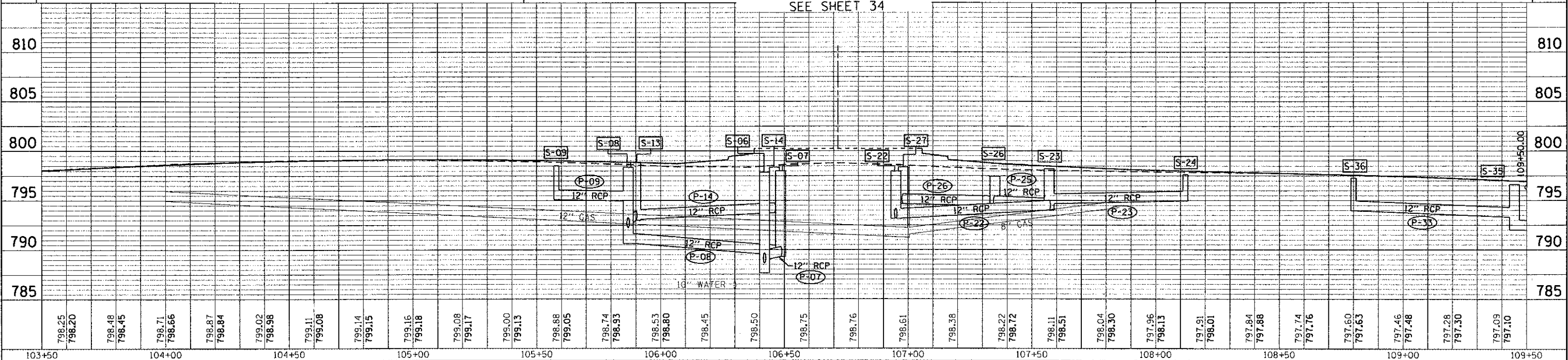

DATE	
BY	
REVIEWED	
PLANNED	
NOTE BOOK	
NO.	
CHECKED	
FILE NAME	

DATE	
BY	
REVIEWED	
PLANNED	
NOTE BOOK	
NO.	
CHECKED	
FILE NAME	

FILE NAME = L:\L\REC01122481\DWG\CADD_Sheets\Sheet_2.dwg

CMT CRAWFORD, MURPHY & TILLY, INC. CONSULTING ENGINEERS License No. 184-000613	USER NAME = Jeff Sedig DESIGNED - DRAWN - CHECKED - DATE -	REVISED - REVISED - REVISED - REVISED -	STATE OF ILLINOIS DEPARTMENT OF TRANSPORTATION	PROPOSED DRAINAGE PLAN & PROFILE	F.A.U. RT. 0192 SECTION 06-00153-07-CH COUNTY LAKE TOTAL SHEETS 120 SHEET NO. 32	CONTRACT NO. 63682 ILLINOIS FED. AID PROJECT
	PLOT SCALE = 40,0000' / in. PLOT DATE = 11/12/2012	SCALE: 20H:5V SHEET NO. 2 OF 5 SHEETS STA. 103+50.00 TO STA. 109+50.00			FED. ROAD DIST. NO.	