

THRU LANE TO TURN LANE CONVERSION

TYPICAL PAVEMENT MARKINGS AND RAISED PAVEMENT MARKERS

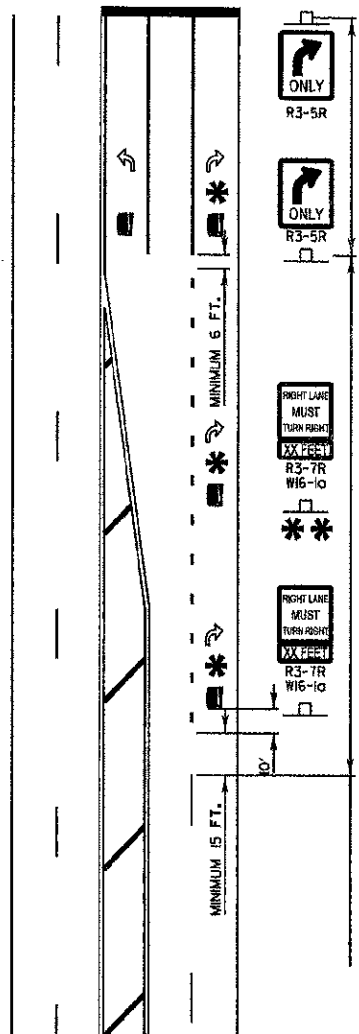

TURN BAY
6" WHITE LINE
(ADDITIONAL PAV'T MARKINGS AS SHOWN ON SHEET ONE OF THE L.C.D.O.T PAV'T MARKINGS DETAIL SHEETS)

TRANSITION ZONE
6" WHITE 3/12' SKIP DASH LANE LINE

THRU LANE
4" WHITE 10/30' SKIP DASH LANE LINE

MINIMUM TRANSITION ZONE LENGTH

POSTED SPEED	LENGTH
25 M.P.H.	255 FT.
30 M.P.H.	330 FT.
35 M.P.H.	405 FT.
40 M.P.H.	480 FT.
45 M.P.H.	555 FT.
50 M.P.H.	630 FT.
55 M.P.H.	705 FT.

LOCATION OF PAV'T MARKINGS (MEASURED FROM BEGINNING OF TRANSITION ZONE)

POSTED SPEED	LOCATION OF PAV'T MARKINGS
25 M.P.H.	10 FT., 260 FT.
30 M.P.H.	10 FT., 170 FT., 340 FT.
35 M.P.H.	10 FT., 210 FT., 40 FT.
40 M.P.H.	10 FT., 170 FT., 330 FT., 490 FT.
45 M.P.H.	10 FT., 190 FT., 370 FT., 560 FT.
50 M.P.H.	10 FT., 170 FT., 330 FT., 490 FT., 640 FT.
55 M.P.H.	10 FT., 180 FT., 350 FT., 520 FT., 710 FT.

FOR POSTED SPEEDS 40 M.P.H. OR GREATER A SECOND R3-7/W16-1a SIGN INSTALLATION SHALL BE LOCATED HALFWAY BETWEEN THE BEGINNING OF THE TRANSITION ZONE AND THE BEGINNING OF THE TURN LANE

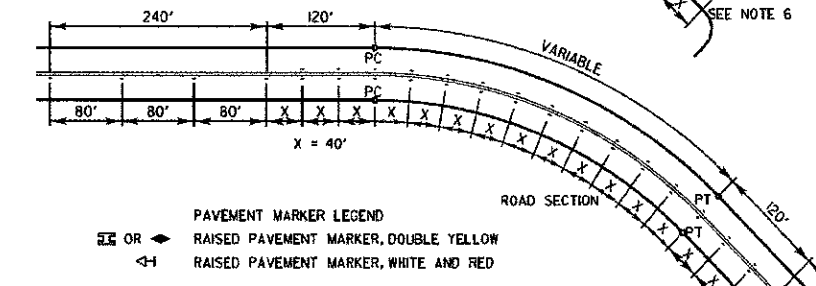
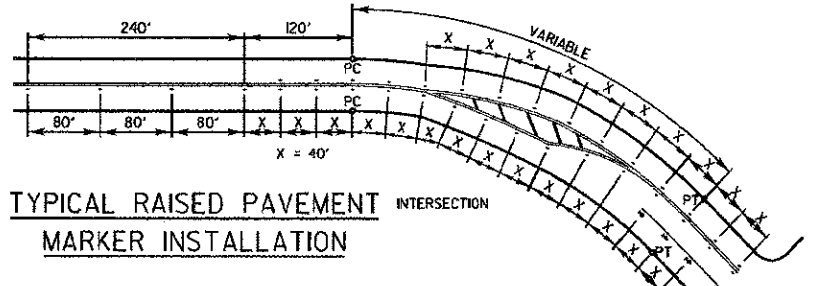

PAVEMENT MARKER LEGEND
 RAISED PAVEMENT MARKER, DOUBLE YELLOW
 RAISED PAVEMENT MARKER, WHITE AND RED

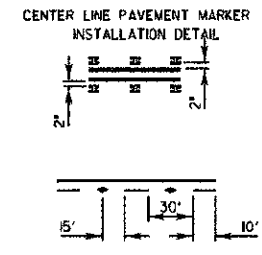
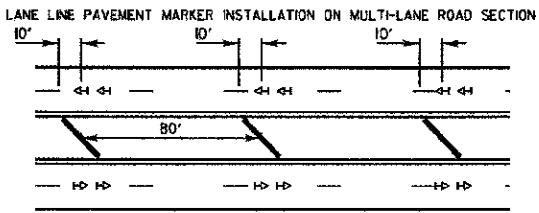

- NOTES:
- CENTERLINE RAISED PAVEMENT MARKERS (RPM's) SHALL BE PLACED ON ALL CURVES OVER 3 1/2 DEGREES ON ALL TWO AND THREE LANE HIGHWAYS, UNLESS DIRECTED OTHERWISE BY THE ENGINEER.
 - SPACING = 40' FOR CENTERLINE MARKERS.
 - ALL RPM'S ON CENTERLINE ARE 2-WAY YELLOW. LANE LINE MARKERS ARE WHITE/RED.
 - MARKERS SHALL BE INSTALLED IN ACCORDANCE WITH F.H.W.A. MEMORANDUM HO-21.
 - MARKERS SHALL BE FIELD ADJUSTED TO BE LOCATED IN CENTER OF THE 30' GAP OF A 30'/10' SKIP/DASH CENTERLINE.
 - RPM'S WHICH ARE TO BE LOCATED WITHIN THE INTERSECTION OF A CROSS STREET, SHALL NOT BE INSTALLED.
 - A MINIMUM OF 4 WHITE/RED MARKERS SHALL BE INSTALLED ALONG THE TURN LANE LINE.
 - RPM'S INSTALLED ON MULTI-LANE ROAD SECTIONS SHALL BE INSTALLED ON THE WHITE SKIP-DASH LANE LINE ONLY. THESE RPM'S SHALL BE INSTALLED IN PAIRS AND SHALL BE 80' CENTER TO CENTER. SPACING WITHIN EACH PAIR SHALL BE 10', CENTERED WITHIN THE 30' SKIP.

CROSSWALKS

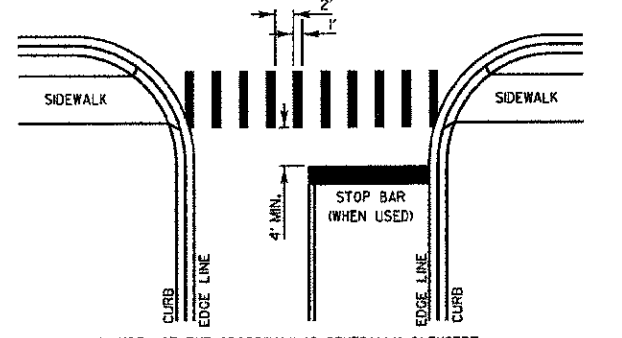

- WIDTH OF THE CROSSWALK IS GENERALLY 6' EXCEPT AT SCHOOL CROSSINGS AND BICYCLE CROSSINGS, WHICH CAN BE 8'.
- THE STOP BAR SHOULD BE INSTALLED A MINIMUM OF 4' IN ADVANCE OF THE CROSSWALK.

CURB MARKING

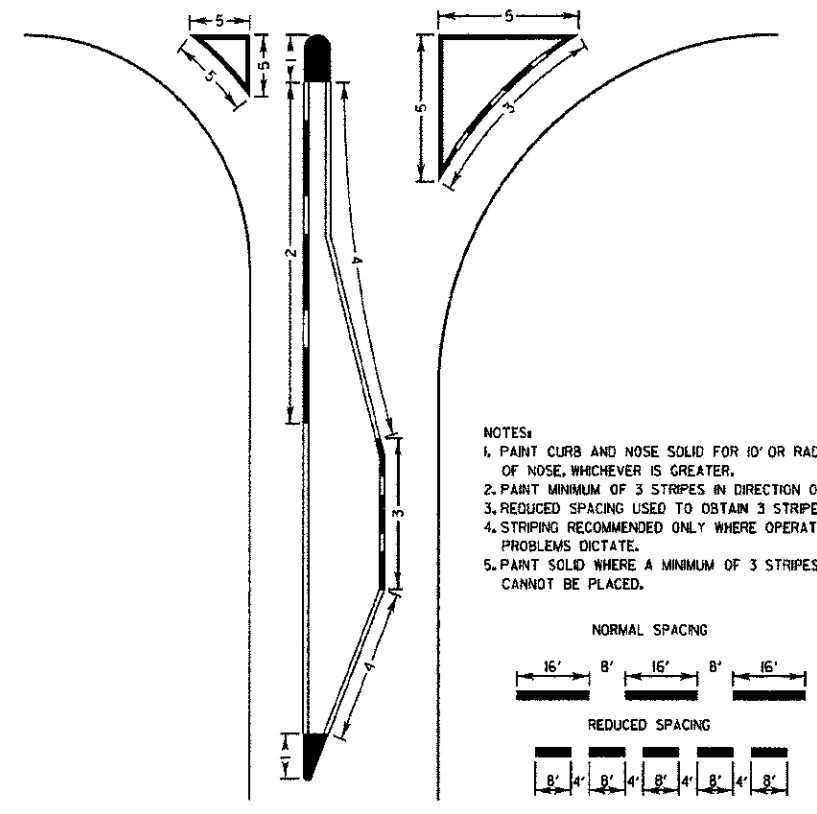

- NOTES:
- PAINT CURB AND NOSE SOLID FOR 10' OR RADIUS OF NOSE, WHICHEVER IS GREATER.
 - PAINT MINIMUM OF 3 STRIPES IN DIRECTION OF TRAFFIC.
 - REDUCED SPACING USED TO OBTAIN 3 STRIPE MINIMUM.
 - STRIPING RECOMMENDED ONLY WHERE OPERATIONAL PROBLEMS DICTATE.
 - PAINT SOLID WHERE A MINIMUM OF 3 STRIPES CANNOT BE PLACED.

PAVEMENT CROSS SECTION SHOWING TYPICAL PAVEMENT MARKINGS (2-LANE ROADWAY)

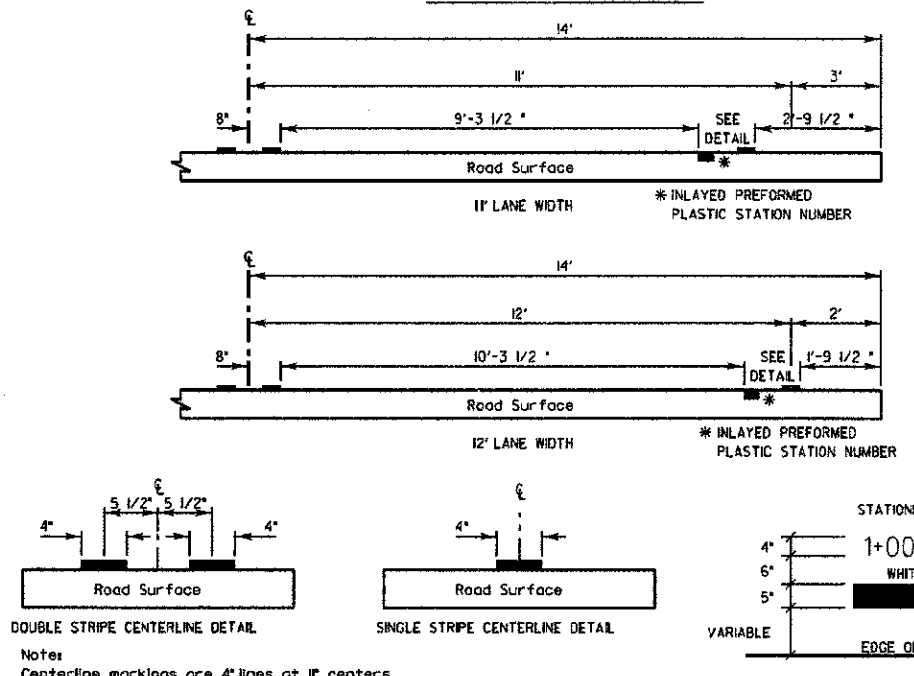

PAVEMENT MARKING GUIDELINES				
TYPE OF MARKING	WIDTH OF LINE	PATTERN	COLOR	SPACING / REMARKS
CENTERLINE OF 2 LANE PAVEMENT	4 IN.	SKIP-DASH	YELLOW	10 FT. LINE WITH 30 FT. SPACE
NO PASSING ZONE LINES FOR ONE DIRECTION FOR BOTH DIRECTIONS	4 IN. 2 @ 4 IN.	SOLID	YELLOW	5 1/2 IN. C.C. FROM SKIP-DASH CENTERLINE 11 IN. C.C. (LIMIT SKIP-DASH CENTERLINE BETWEEN)
CENTERLINE ON MULTI-LANE UNDIVIDED	2 @ 4 IN.	SOLID	YELLOW	11 IN. C.C.
LANE LINES	4 IN.	SKIP-DASH	WHITE	10 FT. LINE WITH 30 FT. SPACE
DOTTED LINES (EXTENSIONS OF CENTERLINE OR TURN LANE MARKINGS)	SAME AS LINE BEING EXTENDED	SKIP-DASH	SAME AS LINE BEING EXTENDED	2 FT. LINE WITH 6 FT. SPACE
EDGE LINES	5 IN. WHITE 4 IN. YELLOW	SOLID	WHITE - RIGHT YELLOW - LEFT	OUTLINE RAISED MEDIANS IN YELLOW
TURN LANE MARKINGS	6 IN. LINE FULL SIZE LETTERS AND SYMBOLS (8 FT.)	SOLID	WHITE	TURN ARROW 156 SQ. FT. STRAIGHT ARROW 115 SQ. FT. ONLY 208 SQ. FT. COMB. ARROW 260 SQ. FT.
TWO WAY LEFT TURN MARKING	2 @ 4 IN. EACH DIRECTION 8 FT. LEFT ARROW	SKIP-DASH AND SOLID	YELLOW	10 FT. LINE WITH 30 FT. SPACE FOR SKIP-DASH 5 1/2 IN. C.C. BETWEEN SKIP-DASH LINE AND SOLID LINE
CROSSWALK	12 IN. @ 30'	SOLID	WHITE	12 IN. LONGITUDINAL BAR WITH 24 IN. SPACE 8 FT. TO 12 FT. WIDE SEE TYPICAL CROSSWALK MARKING DETAIL
STOP BARS	24 IN.	SOLID	WHITE	PLACE 4 FT. IN ADVANCE OF AND PARALLEL TO CROSSWALK. IF PRESENT OTHERWISE PLACE AT DESIRED STOPPING POINT.
PAINTED MEDIANS	2 @ 4 IN. WITH 11 IN. DIAGONALS @ 45' NO DIAGONALS USED FOR 4 FT. WIDE MEDIAN	SOLID	YELLOW - 2-WAY TRAFFIC WHITE - HWY TRAFFIC	11 IN. C.C. FOR THE DOUBLE LINE SEE TYPICAL PAINTED MEDIAN MARKING DETAIL MINIMUM OF 5 DIAGONALS
GORE MARKING AND CHANNELIZING LINES	8 IN. WITH 12 IN. DIAGONALS @ 45'	SOLID	WHITE	DIAGONALS 15 FT. C.C. (LESS THAN 30 M.P.H.) 20 FT. C.C. (30 TO 45 M.P.H.) 30 FT. C.C. (OVER 45 M.P.H.) MINIMUM OF 5 DIAGONALS
R.R. CROSSING	24 IN. TRANSVERSE LINES RR IS 6 FT. LETTER 16 IN. LINE FOR "X"	SOLID	WHITE	SEE TYPICAL RR CROSSING MARKING DETAIL SOFT AREA OF 7' x 36 SQ. FT. / 7' x 540 SQ. FT.
SHOULDER DIAGONALS	12 IN. @ 45'	SOLID	WHITE - RIGHT YELLOW - LEFT	50 FT. C.C. (LESS THAN 30 M.P.H.) 75 FT. C.C. (30 TO 45 M.P.H.) 100 FT. C.C. (OVER 45 M.P.H.) MINIMUM OF 5 DIAGONALS

FOR FURTHER DETAILS ON PAVEMENT MARKING REFER TO PART 11 MARKINGS IN THE ILLINOIS MANUAL ON UNIFORM TRAFFIC CONTROL DEVICES, THE STANDARD SPECIFICATIONS FOR ROAD AND BRIDGE CONSTRUCTION AND ILLINOIS HIGHWAY STANDARD 78000 EFFECTIVE JAN. 9, 1998.

REVISIONS	DATE	 Lake County Division of Transportation	APPROVED BY: A. KHAWAJA DATE: APRIL 1, 2007
Separated Railroad Sheet	06/02/08		
TYPICAL PAVEMENT MARKINGS FOR COUNTY HIGHWAYS		SHEET 2 OF 2	