

FINAL SURVEY	DATE
SURVEYED	BY
PLOTTED	
NOTE BOOK	
AREAS CHECKED	
NO.	

ORIGINAL SURVEY	DATE
SURVEYED	BY
PLOTTED	
NOTE BOOK	
AREAS CHECKED	
NO.	

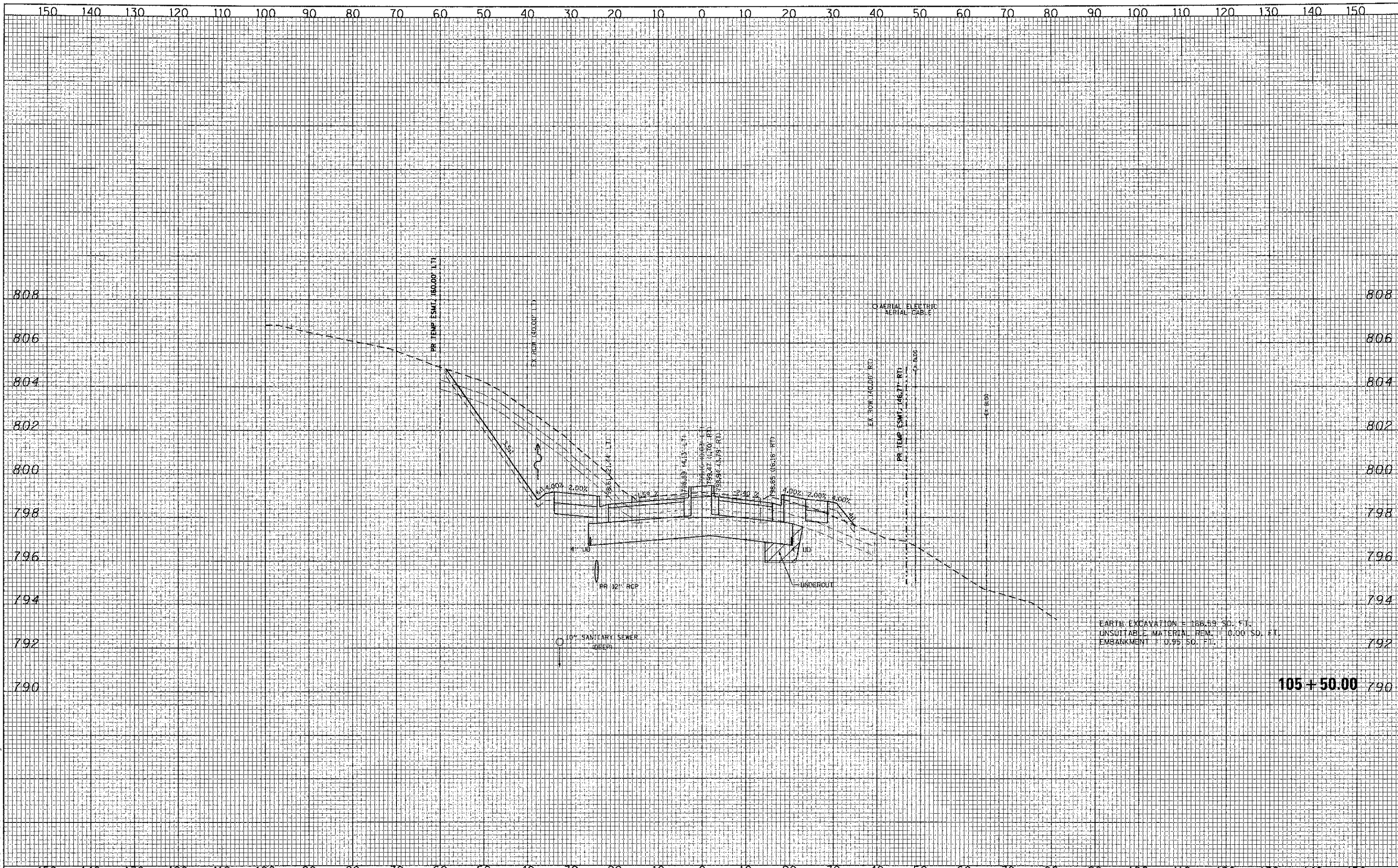

EARTH EXCAVATION = 188.59 SQ. FT.
 UNSUITABLE MATERIAL REM. = 10.00 SQ. FT.
 EMBANKMENT = 0.95 SQ. FT.

FILE NAME = L:\LAKEDVD\122481\Draw\CADD\Sheets\shesheer_monev13a.dgn



USER NAME = Jeff Sadiq	DESIGNED - CMC	REVISED -
PLOT SCALE = 20.0000' / 1"	DRAWN - ERD	REVISED -
PLOT DATE = *PLOTDATE*	CHECKED - KDN	REVISED -
	DATE - 10/22/2012	REVISED -

STATE OF ILLINOIS
 DEPARTMENT OF TRANSPORTATION

MONAVILLE ROAD - CROSS SECTIONS
 SCALE: 10H:2V SHEET NO. OF SHEETS STA. 105+50.00 TO STA. 105+50.00

F.A. RTE. 0192	SECTION 06-00153-07-CH	COUNTY LAKE	TOTAL SHEETS 120	SHEET NO. 110
FED. ROAD DIST. NO. 1 (ILLINOIS) FED. AID PROJECT				
CONTRACT NO. 63682				