

REMOVAL LEGEND

- DENOTES HOT-MIX ASPHALT SURFACE REMOVAL--BUTT JOINT
- DENOTES DRIVEWAY PAVEMENT REMOVAL
- DENOTES SIDEWALK REMOVAL
- DENOTES COMBINATION CURB AND GUTTER REMOVAL
- "A"** DENOTES EXISTING VALVE VAULTS, VALVE BOXES, INLETS, CATCH BASINS AND MANHOLES TO BE CLEANED, GROUTED, AND ADJUSTED TO GRADE WITH NEW ADJUSTING RINGS. (ALL TOP BANDS OF FALLEN COMMON OR PCC BRICK TO BE REPLACED WITH PRECAST PCC ADJUSTING RINGS)
- "S"** DENOTES EXISTING FRAMES AND LIDS TO BE ADJUSTED (SPECIAL)

PROPOSED PAVEMENT LEGEND

- DENOTES PORTLAND CEMENT CONCRETE DRIVEWAY PAVEMENT, 6 INCH (PE) OR PORTLAND CEMENT CONCRETE DRIVEWAY PAVEMENT, 8 INCH (CE)
- DENOTES PORTLAND CEMENT CONCRETE SIDEWALK, 6 INCH (8" THICKNESS AT CE DRIVEWAYS)
- DENOTES POLYMERIZED LEVELING BINDER (MACHINE METHOD), IL-4.75, NSD, 2-1/4 INCH AVG. AND HOT-MIX ASPHALT SURFACE COURSE, MIX D, NSD, 2 INCH. SEE TYPICAL SECTION SHEET 4
- DENOTES COMBINATION CONCRETE CURB AND GUTTER, TYPE B-6.18
- DENOTES PORTLAND CEMENT CONCRETE SIDEWALK, 6 INCH WITH DETECTABLE WARNINGS PER I.D.O.T. STANDARDS FOR HANDICAP RAMPS (WHERE APPLICABLE) SEE CONSTRUCTION HIGHWAY STANDARDS
- PE DENOTES PRIVATE ENTRANCE
- CE DENOTES COMMERCIAL ENTRANCE

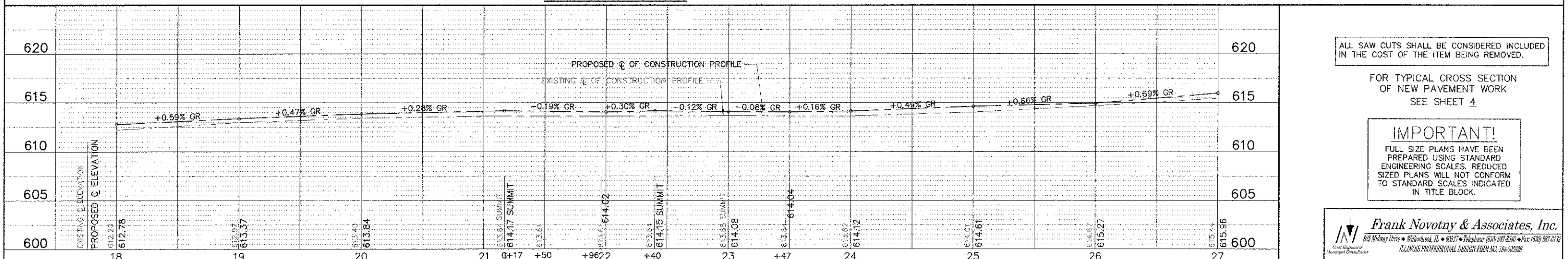
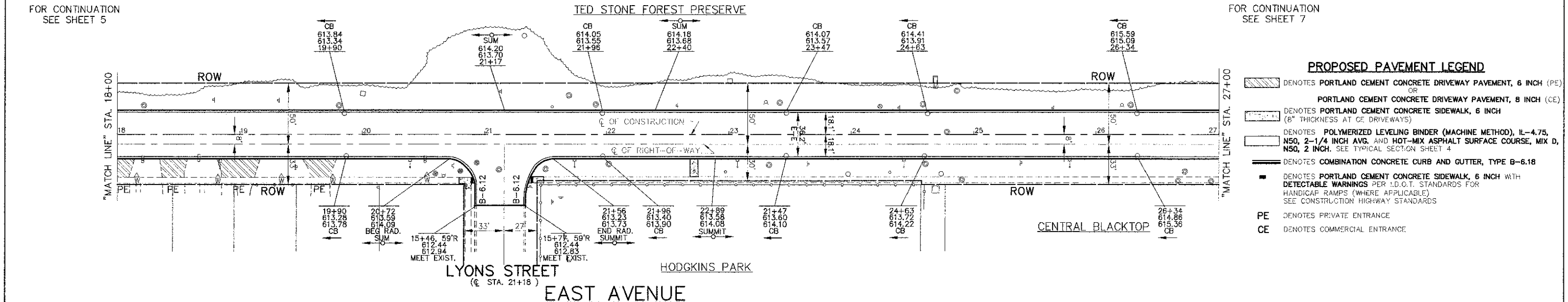
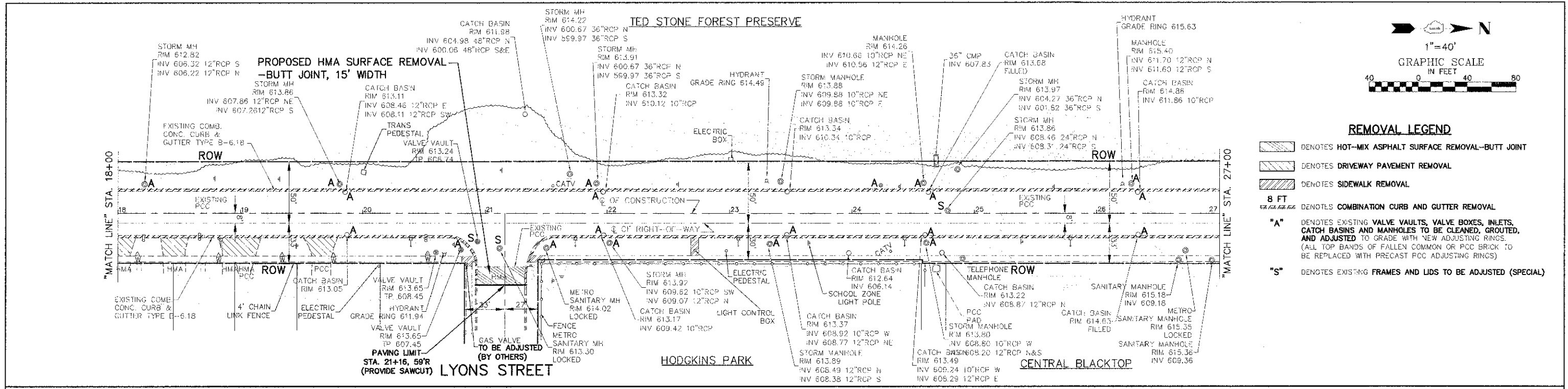

ALL SAW CUTS SHALL BE CONSIDERED INCLUDED IN THE COST OF THE ITEM BEING REMOVED.

FOR TYPICAL CROSS SECTION OF NEW PAVEMENT WORK SEE SHEET 4

IMPORTANT!
FULL SIZE PLANS HAVE BEEN PREPARED USING STANDARD ENGINEERING SCALES. REDUCED SIZED PLANS WILL NOT CONFORM TO STANDARD SCALES INDICATED IN TITLE BLOCK.

Frank Novotny & Associates, Inc.
805 Midway Drive • Wheeling, IL • 60091 • Telephone: (815) 897-8540 • Fax: (815) 897-0132
ILLINOIS PROFESSIONAL DESIGN FIRM NO. 184-00008

FILE NAME VILLAGE OF HODKINS EAST AVENUE 67TH ST. TO JOULET RD. RESURFACING	USER NAME DESIGNED - THK DRAWN - JJP CHECKED - JLC DATE - 4/12	REVISIONS REVISED - JLC 10-15-12 REVISED - REVISED - REVISED -	STATE OF ILLINOIS DEPARTMENT OF TRANSPORTATION	PLAN & PROFILE: EAST AVENUE - STA. 18+00 TO 27+00 (RESURFACING) SCALE: 1" = 40' SHEET NO. OF SHEETS STA. TO STA.	P.A.U. NO. 2719 SECTION 11-00019-00-RS COUNTY COOK TOTAL SHEETS 29 SHEET NO. 7 CONTRACT NO. 63736 FLD. ROAD DIST. NO. ILLINOIS FED. AID PROJECT M-9003 (868)
---	--	--	---	--	--