

REMOVAL LEGEND

- DENOTES HOT-MIX ASPHALT SURFACE REMOVAL--BUTT JOINT
- DENOTES HOT-MIX ASPHALT SURFACE REMOVAL, 3 INCH OR HOT-MIX ASPHALT SURFACE REMOVAL, VARIABLE DEPTH* 0" AT STA. 52+69 TO 3" AT STA. 53+39
- DENOTES HOT-MIX ASPHALT SURFACE REMOVAL, VARIABLE DEPTH
- DENOTES SIDEWALK REMOVAL
- 8 FT DENOTES COMBINATION CURB AND GUTTER REMOVAL
- "A"** DENOTES EXISTING VALVE VAULTS, VALVE BOXES, INLETS, CATCH BASINS AND MANHOLES TO BE CLEANED, GROUTED, AND ADJUSTED TO GRADE WITH NEW ADJUSTING RINGS. (ALL TOP BANDS OF FALLEN COMMON OR PCC BRICK TO BE REPLACED WITH PRECAST PCC ADJUSTING RINGS)
- "S"** DENOTES EXISTING FRAMES AND LIDS TO BE ADJUSTED (SPECIAL)

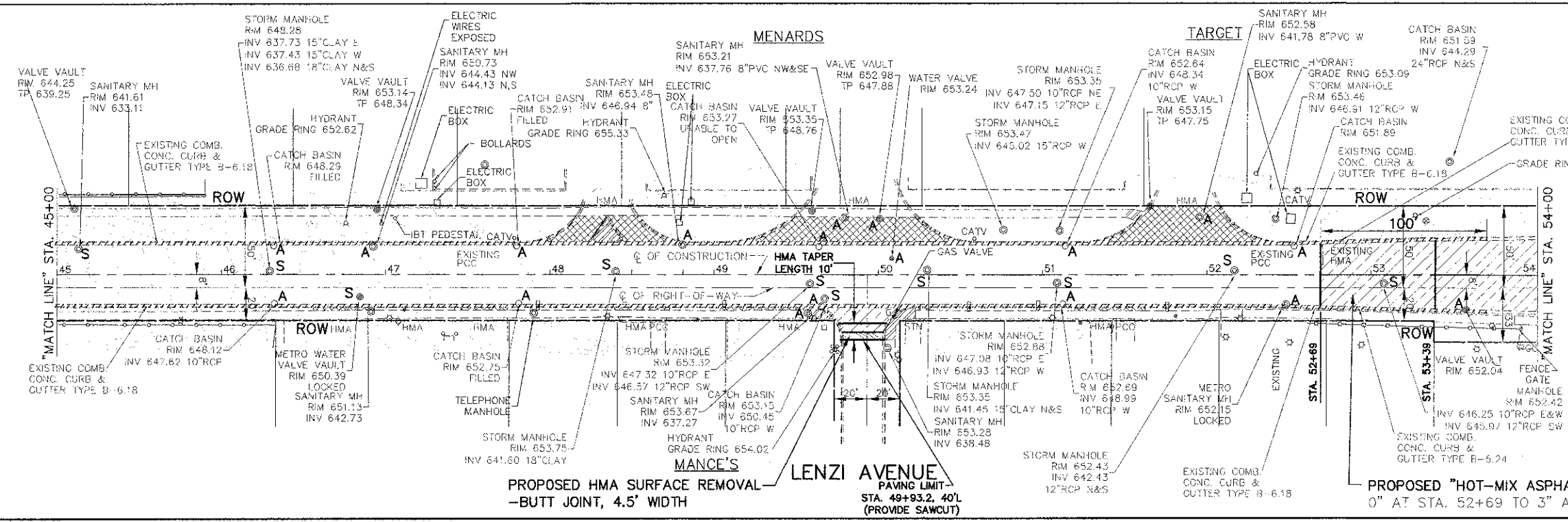

PROPOSED HMA SURFACE REMOVAL--BUTT JOINT, 4.5' WIDTH
 LENZI AVENUE PAVING LIMIT STA. 49+93.2, 40'L (PROVIDE SAWCUT)
 PROPOSED "HOT-MIX ASPHALT SURFACE REMOVAL, VARIABLE DEPTH", 0" AT STA. 52+69 TO 3" AT STA. 53+39

FOR CONTINUATION SEE SHEET 8

FOR CONTINUATION SEE SHEET 10

PROPOSED PAVEMENT LEGEND

- DENOTES HOT-MIX ASPHALT SURFACE COURSE, MIX "D", N50, IN TWO LIFTS
- DENOTES PORTLAND CEMENT CONCRETE SIDEWALK, 6 INCH (8" THICKNESS AT GE DRIVEWAYS)
- DENOTES POLYMERIZED LEVELING BINDER (MACHINE METHOD), IL-4.75, N50, 2-1/4 INCH AVG. AND HOT-MIX ASPHALT SURFACE COURSE, MIX D, N50, 2 INCH. SEE TYPICAL SECTION SHEET 4
- DENOTES POLYMERIZED LEVELING BINDER (MACHINE METHOD), IL-4.75, N50, 1 INCH AVG. AND HOT-MIX ASPHALT SURFACE COURSE, MIX D, N50, 2 INCH. SEE TYPICAL SECTION SHEET 4
- DENOTES COMBINATION CONCRETE CURB AND GUTTER, TYPE B-6.18
- DENOTES PORTLAND CEMENT CONCRETE SIDEWALK, 6 INCH WITH DETECTABLE WARNINGS PER I.D.O.T. STANDARDS FOR HANDICAP RAMPS (WHERE APPLICABLE) SEE CONSTRUCTION HIGHWAY STANDARDS
- PE DENOTES PRIVATE ENTRANCE
- CE DENOTES COMMERCIAL ENTRANCE

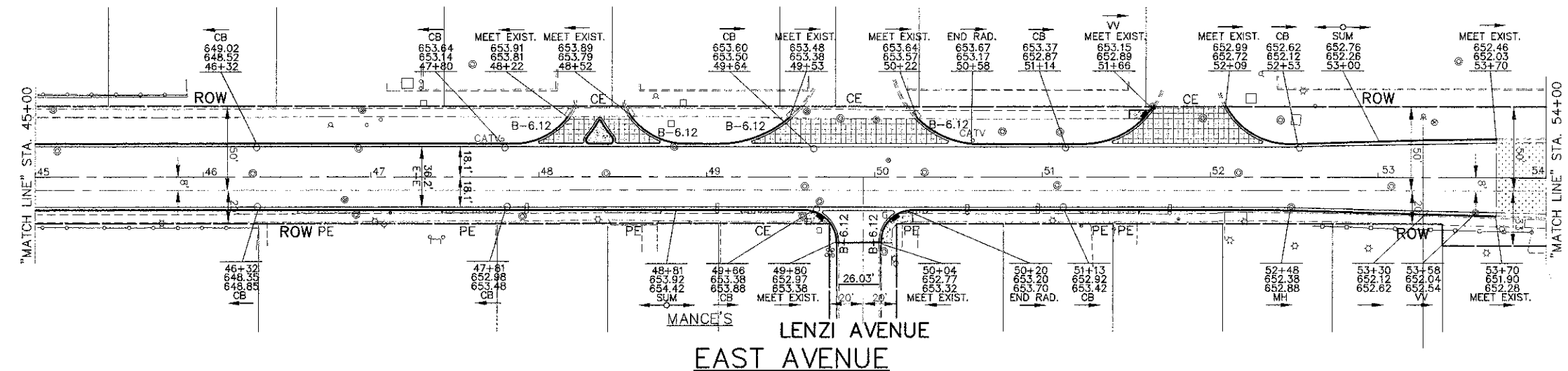

LENZI AVENUE EAST AVENUE

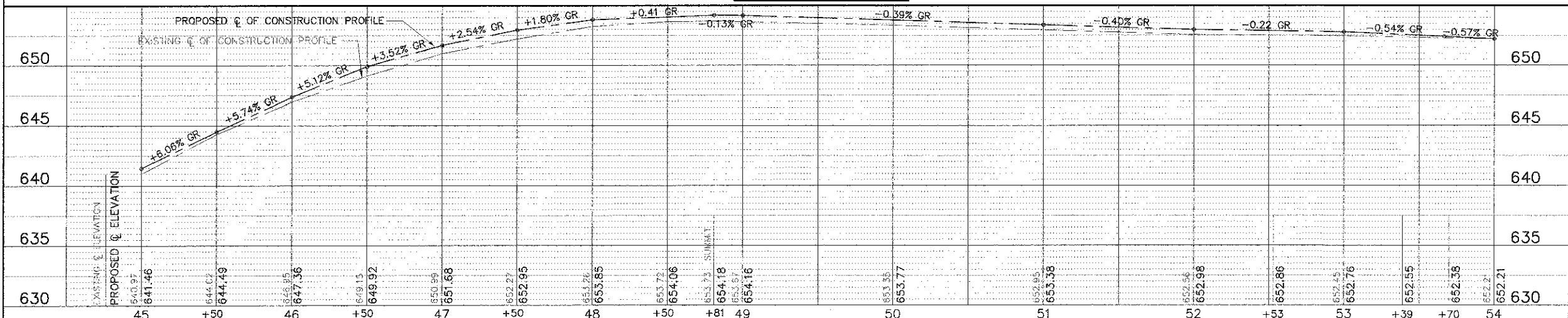

ALL SAW CUTS SHALL BE CONSIDERED INCLUDED IN THE COST OF THE ITEM BEING REMOVED.

FOR TYPICAL CROSS SECTION OF NEW PAVEMENT WORK SEE SHEET 4 & 5

IMPORTANT!
 FULL SIZE PLANS HAVE BEEN PREPARED USING STANDARD ENGINEERING SCALES. REDUCED SIZED PLANS WILL NOT CONFORM TO STANDARD SCALES INDICATED IN TITLE BLOCK.

Frank Novotny & Associates, Inc.
 635 Midway Drive • Wheeling, IL • 60557 • Telephone: (815) 937-8810 • Fax: (815) 937-0138
 ILLINOIS PROFESSIONAL DESIGN FIRM NO. 184-066028

FILE NAME: VILLAGE OF HODGKINS EAST AVENUE 67TH ST. TO JOLIET RD. RESURFACING	USER NAME: ---	DESIGNED: --- THK	REVISED: --- JLC 10-15-12
PLOT SCALE: ---	CHECKED: --- JLC	DRAWN: --- JFP	REVISED: ---
PLOT DATE: ---	DATE: --- 4/12		REVISED: ---

STATE OF ILLINOIS DEPARTMENT OF TRANSPORTATION

PLAN & PROFILE: EAST AVENUE - STA. 45+00 TO STA. 54+00 (RESURFACING)
 SCALE: 1"=40' SHEET NO. OF SHEETS: 1 STA. TO STA.:

SECTION: 11-00019-00-RS	COUNTY: COOK	TOTAL SHEETS: 29	SHEET NO.: 10
CONTRACT NO. 63736		FED. ROAD DIST. NO. ILLINOIS (I.D.) AID PROJECT M-9003 (868)	