

DATE	
BY	
REVISION	
NO.	
DATE	
BY	
REVISION	
NO.	
DATE	
BY	
REVISION	
NO.	

DATE	
BY	
REVISION	
NO.	
DATE	
BY	
REVISION	
NO.	
DATE	
BY	
REVISION	
NO.	

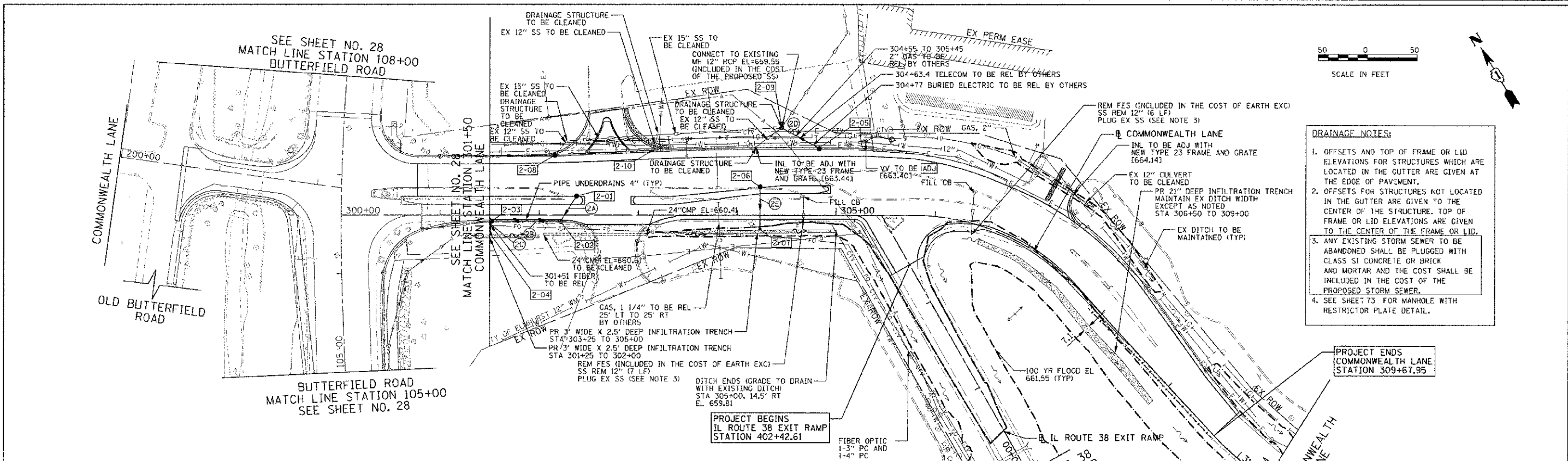

- DRAINAGE NOTES:**
1. OFFSETS AND TOP OF FRAME OR LID ELEVATIONS FOR STRUCTURES WHICH ARE LOCATED IN THE CUTTER ARE GIVEN AT THE EDGE OF PAVEMENT.
 2. OFFSETS FOR STRUCTURES NOT LOCATED IN THE CUTTER ARE GIVEN TO THE CENTER OF THE STRUCTURE. TOP OF FRAME OR LID ELEVATIONS ARE GIVEN TO THE CENTER OF THE FRAME OR LID.
 3. ANY EXISTING STORM SEWER TO BE ABANDONED SHALL BE PLUGGED WITH CLASS SI CONCRETE OR BRICK AND MORTAR AND THE COST SHALL BE INCLUDED IN THE COST OF THE PROPOSED STORM SEWER.
 4. SEE SHEET 73 FOR MANHOLE WITH RESTRICTOR PLATE DETAIL.

STR NO.	STATION	OFFSET	TYPE	FRAME & GRATE	RIM EL	INVERT ELEVATIONS						
						NORTH	NORTHEAST	EAST	SOUTHEAST	SOUTH	SOUTHWEST	WEST
2-01	302+37.7	19.4'LT	CB, TYPE C	TYPE 23 FRAME AND GRATE	864.45					861.43		
2-02	302+21.6	5.0'RT	MH, TYPE A, 4'-DIAMETER	TYPE 23 FRAME AND GRATE	863.71		661.29			661.29		
2-03	301+51.0	5.0'RT	MH, TYPE A, 4'-DIAMETER	TYPE 23 FRAME AND GRATE	864.00				660.95	660.95		660.95
2-04	301+51.0	20.3'RT	PRC FES 15"	NONE						660.90		
2-05	304+83.0	66.7'LT	CB, TYPE C	TYPE 23 FRAME AND GRATE	863.23	660.81						
2-06	304+23.0	28.5'LT	CB, TYPE C	TYPE 23 FRAME AND GRATE	864.06					660.82		
2-07	304+23.0	15.4'RT	PRC FES 12"	NONE						660.40		
2-08	302+15.9	60.8'LT	CB, TYPE A, 4'-DIAMETER	TYPE 1 FRAME OPEN LID	864.04		661.23					661.50
2-09	304+44.9	88.8'LT	EX-MH	EX TYPE 8 FRAME AND GRATE	862.75		659.35		660.43	659.55	659.35	
2-10	303+13.5	64.1'LT	INLET, TYPE A	TYPE 1 FRAME OPEN LID	863.74		660.31					

PIPE NO.	STRUCTURE		DESCRIPTION	CLASS	TYPE	SIZE (IN)	LENGTH (FT)	SLOPE (%)	TBF (CU YD)
	FROM	TO							
2A	2-01	2-02	STORM SEWERS	A	1	12	27.4	0.50%	4.1
2B	2-02	2-03	STORM SEWERS	A	1	12	67.4	0.50%	10.2
2C	2-03	2-04	STORM SEWERS	A	1	15	10.0	0.50%	0.8
2D	2-05	EX-MH	STORM SEWERS	WM REQ	1	12	38.3	1.00%	1.4
2E	2-06	2-07	STORM SEWERS	A	1	12	43.0	0.50%	9.2

- LEGEND**
- STRUCTURE NUMBER
 - PIPE NUMBER
 - RIPRAP

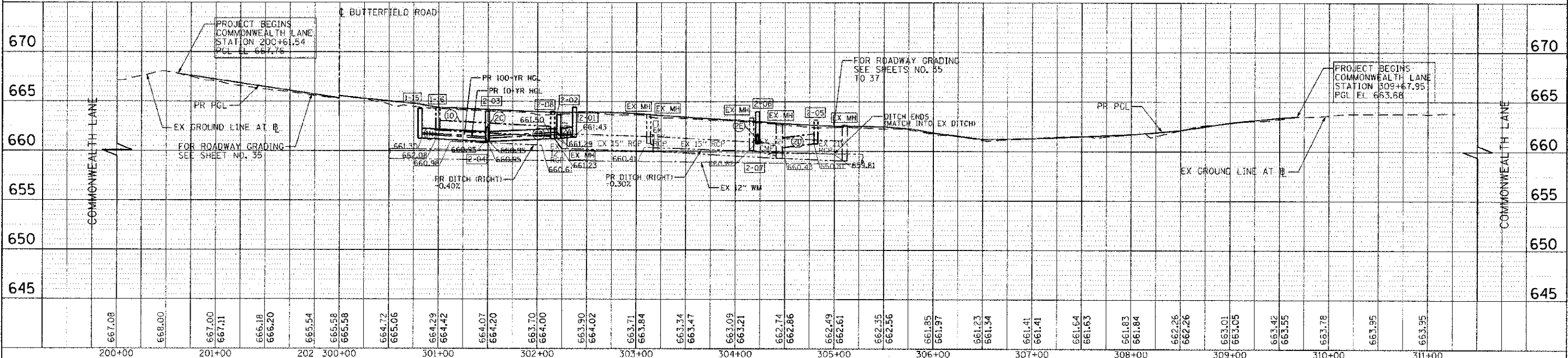

FILE NAME = 6:\CH08\0908\RoadPhase 2\Sheet\01X0808.dgn	USER NAME = kalorenz	DESIGNED = TKS	REVISED =	STATE OF ILLINOIS DEPARTMENT OF TRANSPORTATION	BUTTERFIELD ROAD AT COMMONWEALTH LANE DRAINAGE AND UTILITY PLAN AND PROFILE	F.A.I. R/E = 3545	SECTION = 09-00170-00-CH	COUNTY = DUPAGE	TOTAL SHEETS NO. = 108	SHEET NO. = 29
PILOT SCALE = 50.0000 ft / in.	DATE = 10/22/2012	DRAWN = TKS	REVISED =			SHEET NO. 29 OF 108 SHEETS	STA. 301+50 TO STA. 310+38	CONTRACT NO. = 63742		
PILOT DATE = 12/4/2012	DATE = 10/22/2012	CHECKED = JMG	REVISED =			SCALE: HORIZ. 1"=50'		FED. ROAD DIST. NO. 7 (ILLINOIS) FED. AID PROJECT		
PILOT DATE = 12/4/2012	DATE = 10/22/2012	DATE = 10/22/2012	REVISED =			SCALE: VERT. 1"=5'				