

STATE OF ILLINOIS
DEPARTMENT OF TRANSPORTATION
DIVISION OF HIGHWAYS
**PLANS FOR PROPOSED
FEDERAL AID HIGHWAY**
FAU 1295 (KENSINGTON ROAD)
FOREST AVENUE TO IL 83 (ELMHURST ROAD)
ROADWAY RECONSTRUCTION
SECTION: 09-00154-00-PV
PROJECT M-9003 (435)
VILLAGE OF MOUNT PROSPECT
COOK COUNTY
C-91-875-09

FAU RTE	SECTION	COUNTY	TOTAL SHEETS	SHEET NO.
1295	09-00154-00-PV	COOK	119	1
				CONTRACT # 63746
ILLINOIS FED. AID PROJECT				

FOR INDEX OF SHEETS, SEE SHEET NO. 2

THIS PROJECT IS LOCATED IN THE
VILLAGE OF MOUNT PROSPECT

KENSINGTON ROAD
DESIGN DESIGNATION
FUNCTIONAL CLASSIFICATION: URBAN COLLECTOR
POSTED SPEED LIMIT: 30 mph
DESIGN SPEED LIMIT: 35 mph
2030 TRAFFIC: 8,000

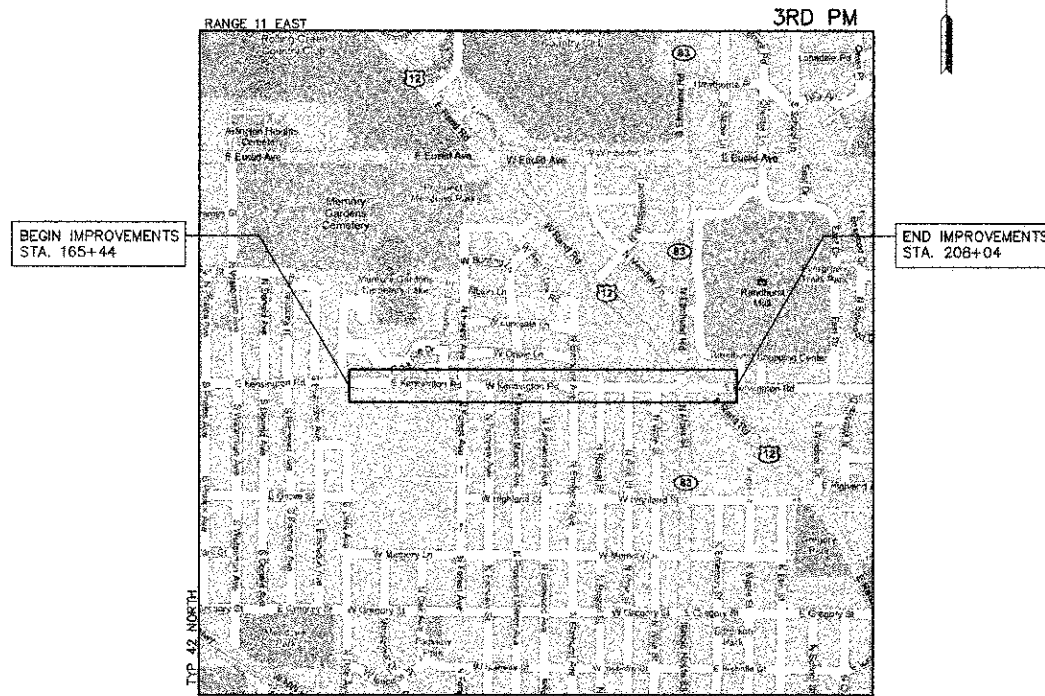

LOCATION MAP
(NOT TO SCALE)

GROSS AND NET LENGTH OF PROJECT = 4,260 FEET (0.807 MILES)



LOCATION OF SECTION INDICATED THIS:

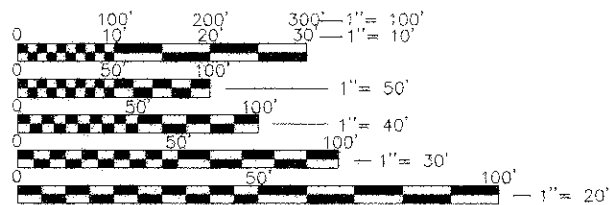

FULL SIZE PLANS HAVE BEEN PREPARED USING STANDARD ENGINEERING SCALES. REDUCED SIZED PLANS WILL NOT CONFORM TO STANDARD SCALES. IN MAKING MEASUREMENTS ON REDUCED PLANS, THE ABOVE SCALES MAY BE USED.

JULIE
JOINT
UTILITY
LOCATION
INFORMATION FOR
EXCAVATION
CALL 811

Know what's below.
Call before you dig.

CONTRACT NO. 63746

STATE OF ILLINOIS	
APPROVED: <i>November 15, 2012</i>	2012
<i>John A. Mulvihill</i> VILLAGE OF MOUNT PROSPECT	
STATE OF ILLINOIS DEPARTMENT OF TRANSPORTATION	
PASSED: <i>November 19, 2012</i>	2012
<i>Charles C. Hart</i> DISTRICT ONE ENGINEER OF LOCAL ROADS AND STREETS	
RELEASED FOR BID BASED ON LIMITED REVIEW: <i>November 15, 2012</i>	2012
<i>John C. Peterson</i> DEPUTY DIRECTOR OF HIGHWAYS, REGION ONE ENGINEER	
PROFESSIONAL ENGINEER'S SIGNATURE & SEAL	
<i>Kevin L. Belgrave</i> KEVIN L. BELGRAVE, P.E.	<i>11/08/12</i> DATE EXPIRES: 11/30/13 SEAL
PROFESSIONAL ELECTRICAL ENGINEER'S SIGNATURE & SEAL	
<i>Arthur J. Penn</i> ARTHUR J. PENN, P.E.	<i>11/08/12</i> DATE EXPIRES: 11/30/13 SEAL
PRINTED BY THE AUTHORITY OF THE STATE OF ILLINOIS	

**GHA GEWALT HAMILTON
ASSOCIATES, INC.**
850 Forest Edge Drive • Vernon Hills, IL 60061
Phone: 847-478-9700 Fax: 847-478-9701

PROGRAM AND OFFICE ENGINEER: CHARLES F. RIDDLE, P.E. (847) 705-4406 SCHAUMBURG, IL