

LEGEND:

- HMA PAVEMENT (SEE TYPICAL SECTION)
- HMA RESURFACING (SEE TYPICAL SECTION)
- PCC SIDEWALK (SEE TYPICAL SECTION)
- HMA BIKE PATH (SEE TYPICAL SECTION)
- PCC DRIVEWAY (SEE TYPICAL SECTION)
- HMA DRIVEWAY (SEE TYPICAL SECTION)
- PAVEMENT PATCH (SEE DETAIL)
- B6.12 CURB & GUTTER - REGULAR
- B6.12 CURB & GUTTER - DEPRESSED
- DETECTABLE WARNING
- PROPOSED SIGN
- PROPOSED MAIL BOX
- PROPOSED POWER/LIGHT POLE
- STREET ADDRESS

NOTE:
WHEN PAVEMENT WIDENING IS LESS THAN 6' WIDE,
PCC BASE COURSE 9" SHALL BE USED.

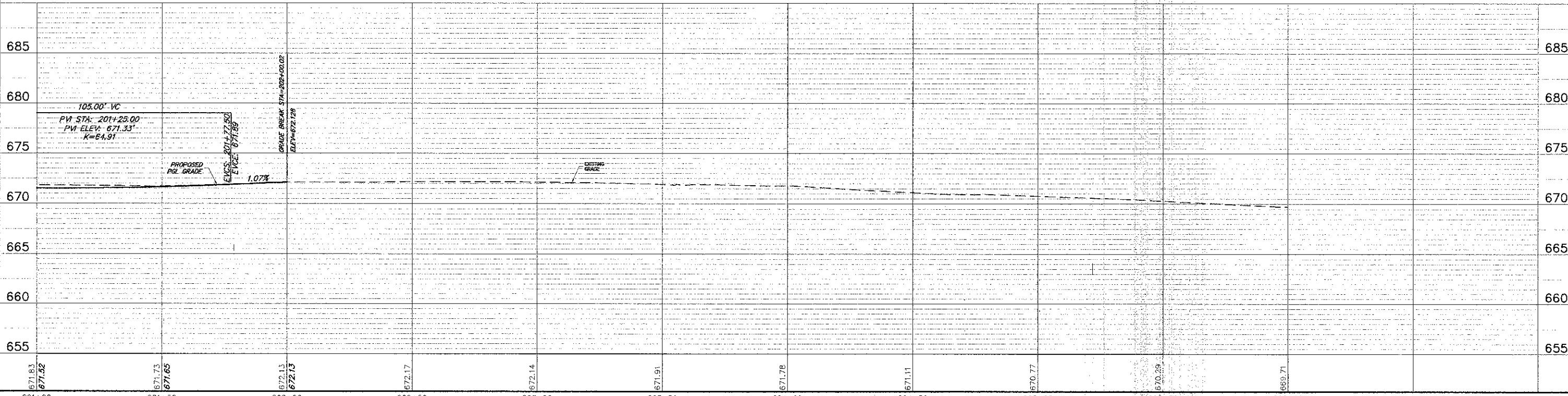

| | | | | | | | | | | | |
|------------------------------|-------------------------|-----------------|-----------|---|--|--------------------|---------------------------|----------------------------|---------------------|-----------------|---------------------------|
| FILE NAME = 4185.800-PR3.dwg | USER NAME = PAUL SWATEK | DESIGNED - BVS | REVISED - | STATE OF ILLINOIS DEPARTMENT OF TRANSPORTATION | ROADWAY PLAN & PROFILE - KENSINGTON ROAD KENSINGTON ROAD IMPROVEMENTS | FAU RTE 1295 | SECTION 09-00154-00-PV | COUNTY COOK | TOTAL SHEETS 119 | SHEET NO. 30 | |
| PLOT SCALE = 1" = .08' | PLOT DATE = 10/17/2012 | CHECKED - KLB | REVISED - | | | SCALE 1"=20' | SHEET NO. OF SHEETS | STA. 201+00 TO STA. 206+00 | CONTRACT # 63746 | | ILLINOIS FED. AID PROJECT |
| | | DATE - 10/17/12 | REVISED - | | | | | | | | |