



REGRADE EXISTING DITCHES
FROM STA. 6+50 TO STA. 33+30 LT

CONSTRUCT NEW ACCESS CULVERT
15" RCP
STA. 10+38, 40' LT
U.S. \bar{E} = 859.35
D.S. \bar{E} = 859.25

MAINTAIN EXISTING OUTLET #3
STA. 11+10 LT
36" CMP

INSTALL 12 LF
15" RCP
INSTALL 2
15" RCP FES

INSTALL 20 LF
18" RCP
INSTALL
18" RCP FES

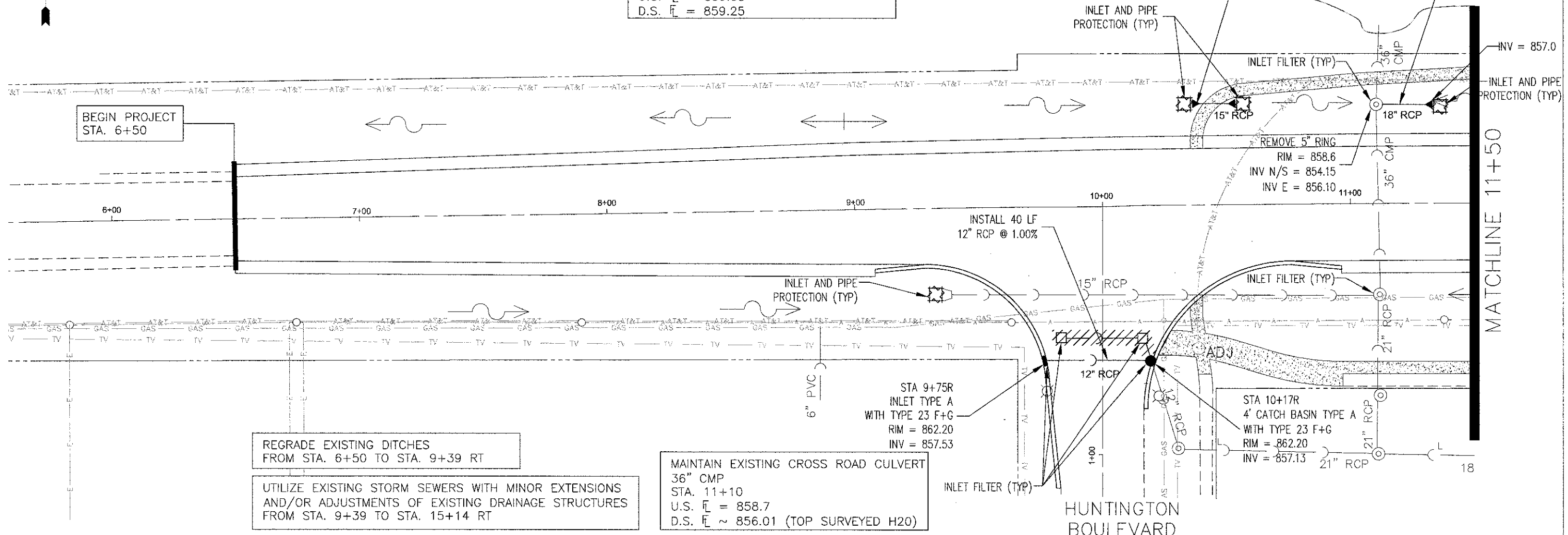

REGRADE EXISTING DITCHES
FROM STA. 6+50 TO STA. 9+39 RT

UTILIZE EXISTING STORM SEWERS WITH MINOR EXTENSIONS
AND/OR ADJUSTMENTS OF EXISTING DRAINAGE STRUCTURES
FROM STA. 9+39 TO STA. 15+14 RT

MAINTAIN EXISTING CROSS ROAD CULVERT
36" CMP
STA. 11+10
U.S. \bar{E} = 858.7
D.S. \bar{E} ~ 856.01 (TOP SURVEYED H20)

STA 9+75R
INLET TYPE A
WITH TYPE 23 F+G
RIM = 862.20
INV = 857.53

STA 10+17R
4' CATCH BASIN TYPE A
WITH TYPE 23 F+G
RIM = 862.20
INV = 857.13

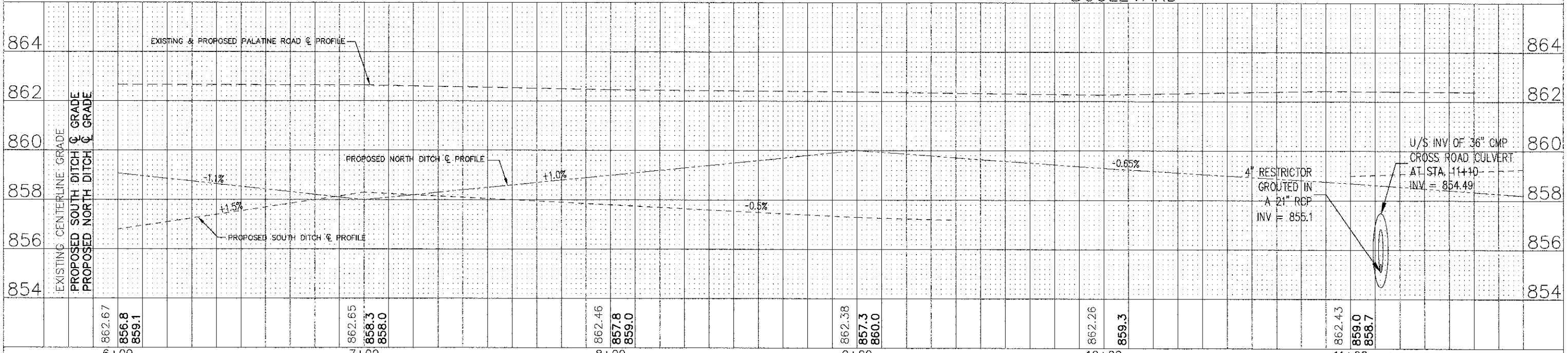

PLAN	SURVEYED	DATE	BY
	NOTED		
	CHECKED		
	BY		
	NO.		

PROFILE	SURVEYED	DATE	BY
	NOTED		
	CHECKED		
	BY		
	NO.		

FILE NAME =
Palatine Plan and Profile.dwg

DESIGNED - NMP
DRAWN - NMP
CHECKED - CJM
DATE - 02-07-11

REVISED -
REVISED -
REVISED -
REVISED -

STATE OF ILLINOIS
DEPARTMENT OF TRANSPORTATION

Palatine Road Widening STP Project
Drainage, Utilities, Erosion & Sediment Control Plan
SCALE: 1" = 20'
SHEET NO. 1 OF 11 SHEETS
STA. 6+00 TO STA. 11+50

F.A.U. RTE.	SECTION	COUNTY	TOTAL SHEETS	SHEET NO.
1285	09-00082-00-CH	Cook	97	38
CONTRACT NO. 63749				ILLINOIS FED. AID PROJECT CMM 9003(492)