

DEMOLITION PLAN NOTES

1. ALL FIRE HYDRANTS SHOWN SHALL BE PROTECTED DURING CONSTRUCTION.
2. CONTRACTOR SHALL PROVIDE AND MAINTAIN POSITIVE DRAINAGE AWAY FROM THE PROPOSED AGGREGATE SUBGRADE DURING CONSTRUCTION. THIS WORK IS CONSIDERED INCLUDED IN THE COST OF THE CONTRACT.

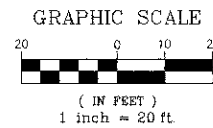

MATCH LINE STATION 14+00 (SEE SHEET 6)

MATCH LINE STATION 20+00 (SEE ABOVE)

MATCH LINE STATION 20+00 (SEE BELOW)

MATCH LINE STATION 26+00 (SEE SHEET 8)

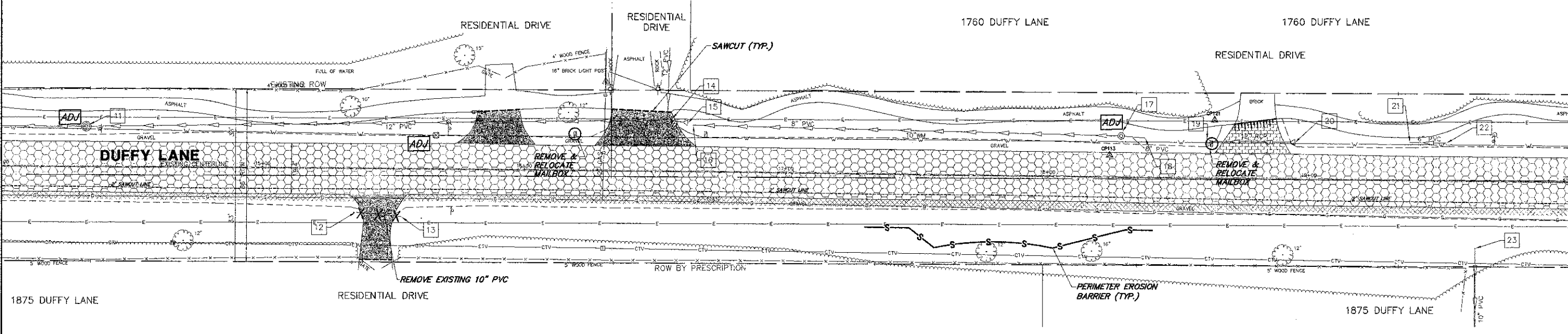

DEMOLITION CONDITIONS LEGEND

- HOT-MIX ASPHALT SURFACE REMOVAL, 2 1/2"
- DRIVEWAY PAVEMENT REMOVAL
- BRICK DRIVEWAY REMOVAL & REPLACEMENT (SPECIAL)
- EARTH EXCAVATION
- STORM STRUCTURE TO BE REMOVED
- TREE TO BE REMOVED
- STORM SEWER TO BE REMOVED
- PERIMETER EROSION BARRIER

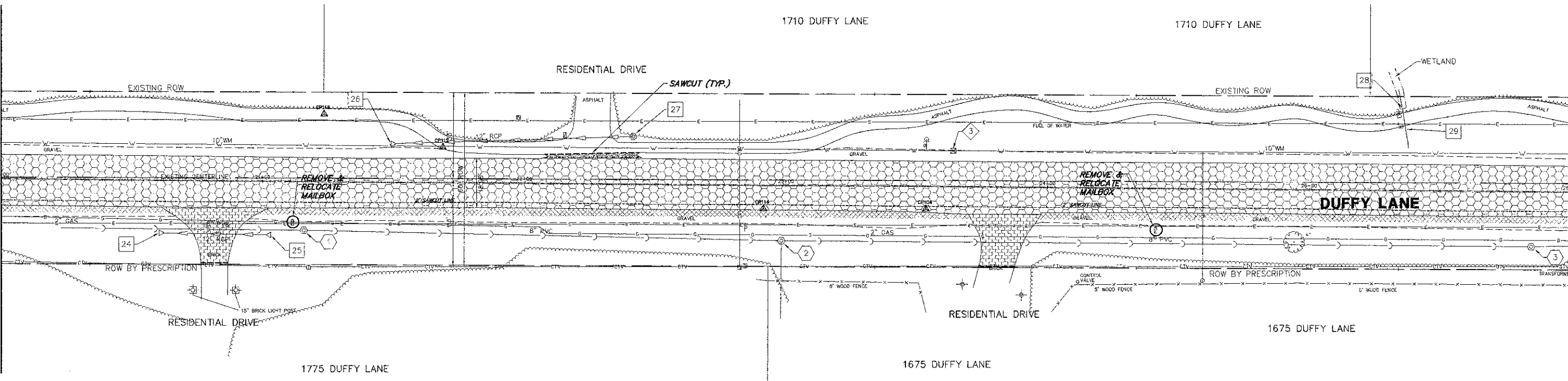

FILE NAME = 8101-057 PR8.dwg	USER NAME = GW3	DESIGNED - DJG	REVISED -	STATE OF ILLINOIS DEPARTMENT OF TRANSPORTATION	DEMOLITION PLAN			FA R.T.E. 1254	SECTION 12-00013-00-RS	COUNTY LAKE	TOTAL SHEETS 32	SHEET NO. 7
	PLOT SCALE = 1:1	DRAWN - GW3	REVISED -		SCALE: 1"=20'	SHEET NO. 7 OF 32 SHEETS	STA. 14+00 TO STA. 26+00					
	PLOT DATE = 08.10.2012	CHECKED - DJG	REVISED -									
		DATE - 08.10.2012	REVISED -		ILLINOIS FED. AID PROJECT M-4003(095) CONTRACT # 63751							