

**PRE-STAGE**

1. CONSTRUCT TEMPORARY PAVEMENT WIDENING ADJACENT TO EXISTING NORTH EOP FROM STA. 90+70 TO 105+78.
2. COMPLETE THE NORTH SIDE EROSION CONTROL MEASURES.
3. COMPLETE THE NORTH STORM SEWER SYSTEM. USE DAILY SINGLE LANE CLOSURES TO INSTALL DRAINAGE ACROSS 143RD STREET. EMBANKMENT SHALL BE CONSTRUCTED ACCORDING TO ART. 542.04 (b) AS REQUIRED.
4. UTILIZE IDOT STANDARD 701326 FOR TEMPORARY LANE CLOSURE AND TEMPORARY PAVEMENT WIDENING.

**STAGE 1**

1. REMOVE EXISTING PAVEMENT MARKINGS AND RAISED PAVEMENT MARKERS IN CONFLICT WITH TEMPORARY STRIPING.
2. COMPLETE EROSION CONTROL, INCLUDING SILT FENCE INSTALLATIONS, INLET PROTECTION, AND SEDIMENT CONTROL MEASURES.
3. COMPLETE THE SOUTH STORM SEWER SYSTEM.
4. COMPLETE WIDENING AND RECONSTRUCTION OF THE SOUTH HALF OF 143RD STREET, EXCEPT SURFACE COURSE.
5. COMPLETE DRIVEWAY RECONSTRUCTION, MAILBOX RELOCATION AND GRADING AND FINAL RESTORATION OF THE SOUTH HALF OF 143RD STREET.

**MAINTENANCE OF TRAFFIC GENERAL NOTES**

1. ANY DROP OFF GREATER THAN THREE INCHES WITHIN EIGHT FEET OF THE PAVEMENT EDGE, SHALL BE PROTECTED BY TYPE II BARRICADES (OR DRUMS) EQUIPPED WITH MONO- DIRECTIONAL STEADY-BURN LIGHTS SPACED AT 25 FOOT CENTERS. BARRICADES THAT MUST BE PLACED IN EXCAVATED AREAS SHALL HAVE LEG EXTENSIONS INSTALLED SUCH THAT THE TOP OF THE BARRICADE IS IN COMPLIANCE WITH THE HEIGHT REQUIREMENTS OF THE IDOT HIGHWAY STANDARD.
2. ARROW BOARDS WILL BE REQUIRED WHEN IMPLEMENTING ALL LANE CLOSURES.
3. PRIOR TO THE START OF CONSTRUCTION, REQUIRED TRAFFIC CONTROL DEVICES SHALL BE IN PLACE.
4. IDOT TRAFFIC CONTROL STANDARDS LISTED BY REFERENCE ON THE SHEET 2 SHALL BE USED AS GUIDES IN IMPLEMENTING THE TRAFFIC CONTROL, INCLUDING SIGN LOCATIONS, FOR THIS PROJECT.
5. THE CONTRACTOR SHALL MAINTAIN ACCESS TO ALL PROPERTIES DURING CONSTRUCTION OPERATIONS.
6. DEPICTED TRAFFIC CONTROL IS A MINIMUM REQUIREMENT, AND OTHER WORK OR SIGNING MAY BE REQUIRED AS PER THE INSTRUCTION OF THE ENGINEER IN CHARGE. THE COST INCURRED TO COMPLY WILL BE INCLUDED IN THE PAY ITEMS "TRAFFIC CONTROL AND PROTECTION, (SPECIAL)".
7. THE CONTRACTOR SHALL PROVIDE THE ENGINEER WITH THE NAMES AND PHONE NUMBERS OF HIS REPRESENTATIVES ON THE CONSTRUCTION SITE PRIOR TO THE START OF WORK.
8. THE CONTRACTOR SHALL BE RESPONSIBLE FOR THE FIELD LOCATION OF ALL DETOUR AND CONSTRUCTION SIGNING. THE CONTRACTOR MAY REQUEST THE ENGINEER TO FIELD VERIFY THE POSITIONS OF ANY SIGNS.
9. TWO-WAY TRAFFIC WILL BE MAINTAINED ON 143RD STREET AT ALL TIMES.
10. ONE ADVANCED CLOSURE SIGN (CHANGEABLE MESSAGE SIGN) SHALL BE ERECTED AT EACH PROJECT LIMIT OR AS DIRECTED BY THE ENGINEER AT LEAST 7 DAYS PRIOR TO START OF WORK AND SHALL REMAIN IN PLACE THROUGHOUT THE TERM OF ROADWAY CONSTRUCTION.
11. THE CONTRACTOR SHALL CONTACT THE WILL COUNTY DEPARTMENT OF HIGHWAYS 2 WORKING DAYS PRIOR TO THE PLACEMENT OF ANY TEMPORARY TRAFFIC CONTROL DEVICES.
12. WORKERS SIGNS (W21-10(0)-4B) SHALL BE TAKEN DOWN OR COVERED AT THE END OF EACH WORKING DAY.

**STAGE 1A**

1. USE DAILY SINGLE LANE CLOSURES TO REMOVE 2 INCH SURFACE COURSE FOR THOSE AREAS THAT WILL BE OPEN TO TRAFFIC IN STAGE 2 AT WEST END.

**STAGE 2**

1. REMOVE EXISTING PAVEMENT MARKINGS AND RAISED PAVEMENT MARKERS IN CONFLICT WITH TEMPORARY STRIPING.
2. INSTALL ANY NEW EROSION CONTROL, INCLUDING SILT FENCE INSTALLATIONS, INLET PROTECTION, AND SEDIMENT CONTROL MEASURES.
3. COMPLETE WIDENING AND RECONSTRUCTION OF THE NORTH HALF OF 143RD STREET, EXCEPT SURFACE COURSE.
4. COMPLETE DRIVEWAY RECONSTRUCTION, MAILBOX RELOCATION AND GRADING AND FINAL RESTORATION OF THE NORTH HALF OF 143RD STREET.

**STAGE 3**

1. UTILIZE SHORT-TERM PAVEMENT MARKING TO DESIGNATE THE MEDIAN AND LANE LINES FROM STA 83+49 TO 102+80.
2. CONSTRUCT TEMPORARY PAVEMENT WIDENING ADJACENT TO EXISTING NORTH AND SOUTH EOP FROM STA 105+50 TO 107+30
3. COMPLETE RECONSTRUCTION OF CENTER TRIANGLE AT EAST END THAT WAS INACCESSIBLE IN STAGE 1 AND 2.

**STAGE 3A**

1. INSTALL MINIMUM 2 UNEVEN LANE SIGNS IN EACH DIRECTION.
2. UTILIZE IDOT STANDARD 701201 TO COMPLETE HMA SURFACE COURSE ACCORDING TO CHECK SHEET #14.
3. INSTALL PERMANENT STRIPING/SIGNING.

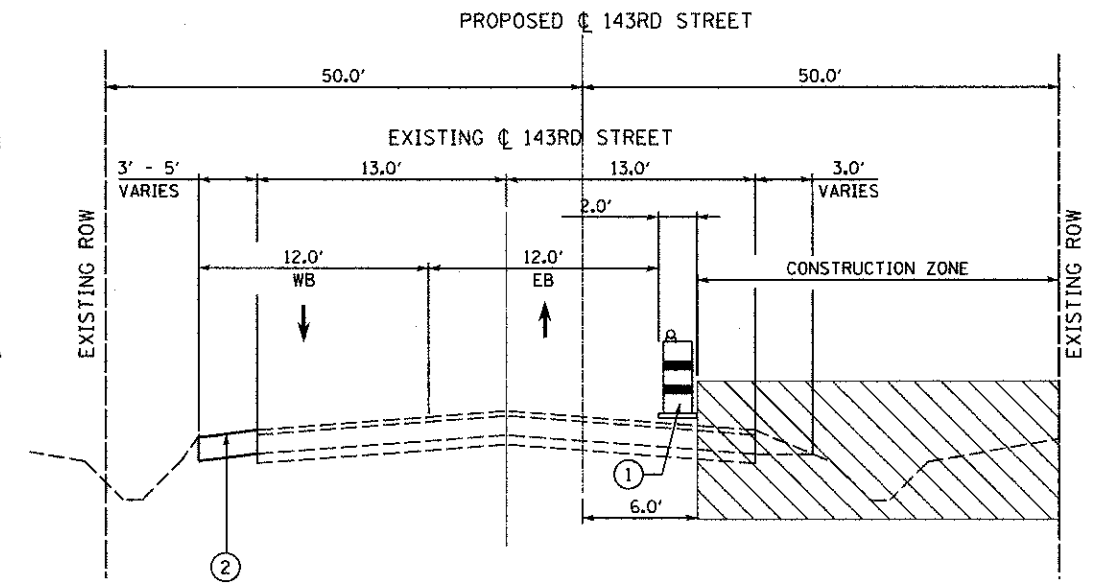

**STAGING SECTION - STAGE 1**

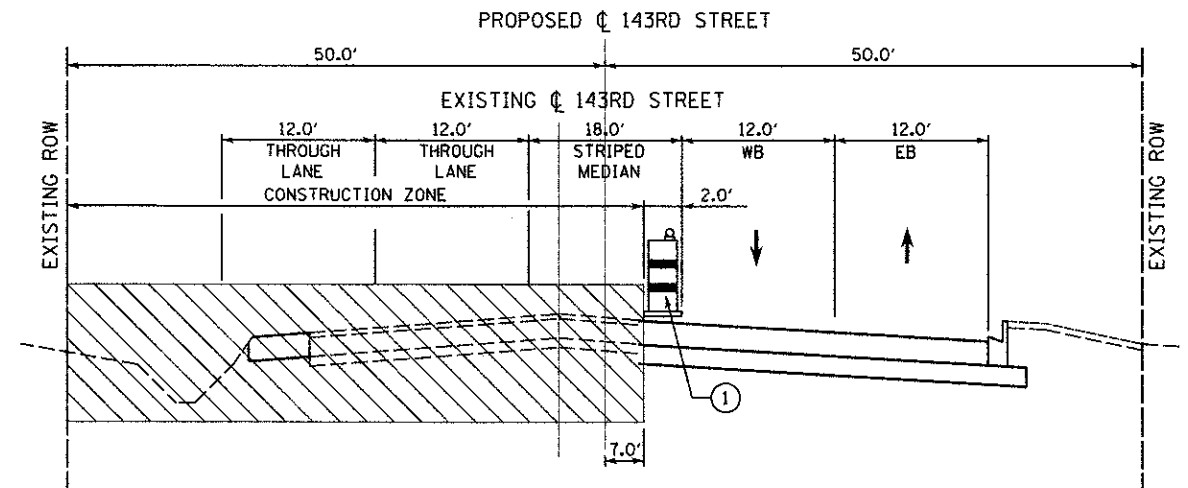

**STAGING SECTION - STAGE 2**

**SCHEDULE OF QUANTITIES**

	PRE-STAGE	STAGE I	STAGE II	STAGE III	STAGE IIIA	TOTAL
SHORT-TERM PAVEMENT MARKING (FOOT)				1201		1201
TEMPORARY PAVEMENT MARKING LINE, 4" (FT)		9237	7887	1577		18,701
WORK ZONE PAVEMENT MARKING REMOVAL (SQ FT)		3079	2629	526		6234
PAVEMENT MARKING REMOVAL (SQ FT)		2935	106	53		3094
TEMPORARY PAVEMENT (SQ YD)	669			88		757

**KEY**

- CONSTRUCTION ZONE
- DRUM OR TYPE II BARRICADE
- TEMPORARY WIDENING, HMA BINDER COURSE, IL-19.0, N50, 9"