

F.A.U. R.T.E. NO. 1726	SECTION 10-00059-00-BR	COUNTY COOK	TOTAL SHEETS 20	SHEET NO. 6
HANOVER PARK		ILLINOIS	CONTRACT NO. 63754	

METROPOLITAN WATER RECLAMATION DISTRICT

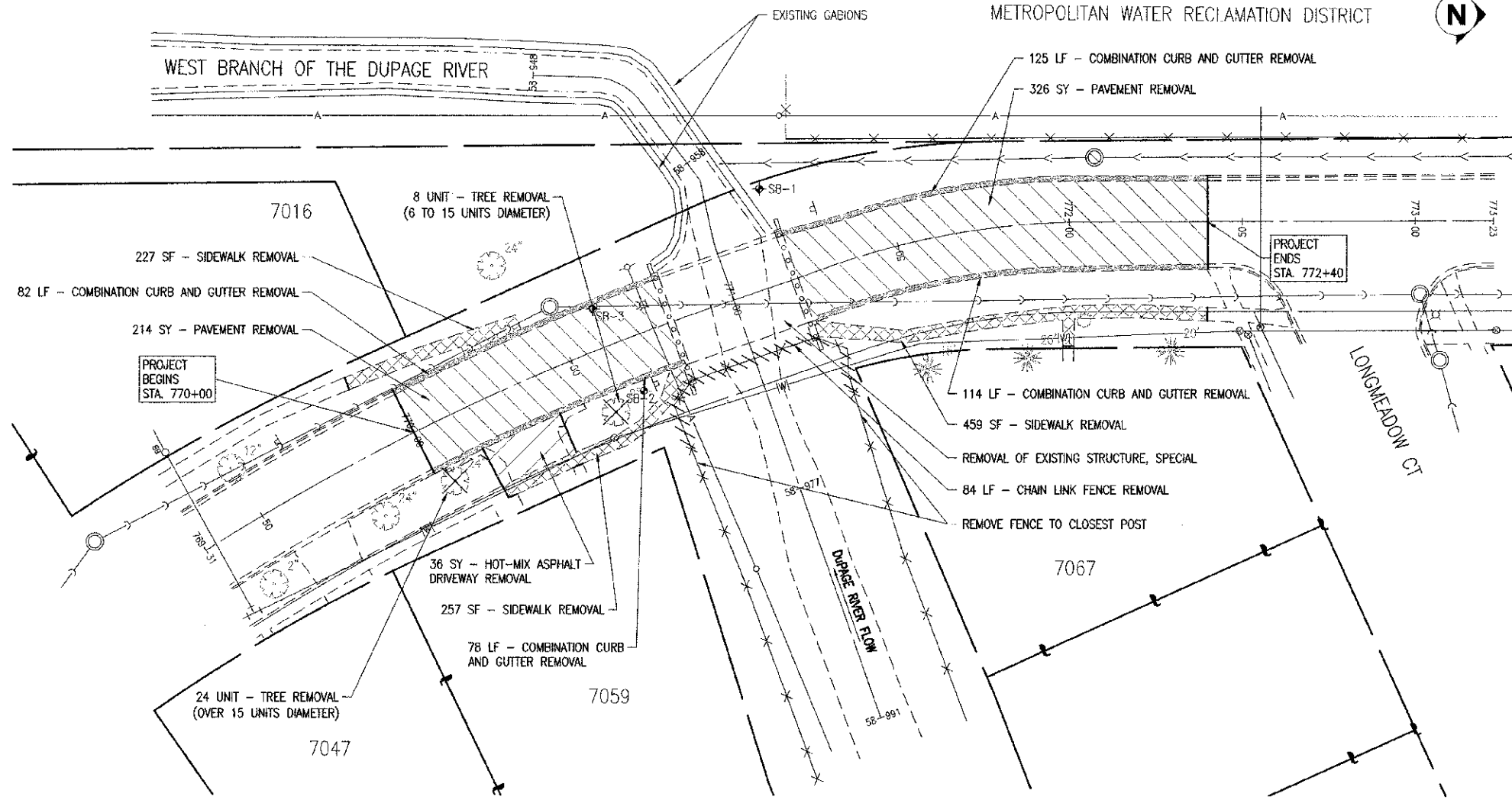

LEGEND

- PAVEMENT REMOVAL
- SIDEWALK REMOVAL
- CURB & GUTTER REMOVAL
- DRIVEWAY PAVEMENT REMOVAL
- TREE REMOVAL
- REMOVE ITEM
- SAWCUTTING

DEMOLITION NOTES

1. ALL ITEMS RELATED TO THE REMOVAL OF THE EXISTING BRIDGE STRUCTURE, INCLUDING THE DECK BEAM REMOVAL, ABUTMENT REMOVAL, SAW CUTTING OF PILES, GUARDRAIL REMOVAL, AND WINGWALL REMOVAL, SHALL BE PAID FOR AS REMOVAL OF EXISTING STRUCTURE, SPECIAL.
2. THE REMOVAL OF THE PAVEMENT AND SIDEWALK OVER THE BRIDGE STRUCTURE, FROM ABUTMENT TO ABUTMENT, SHALL NOT BE PAID FOR SEPARATELY AS PAVEMENT REMOVAL OR SIDEWALK REMOVAL, BUT SHALL BE INCLUDED IN THE PAY ITEM 'REMOVAL OF EXISTING STRUCTURE, SPECIAL'.
3. SAWCUTS TO SEPARATE REMOVED PORTIONS OF AN ITEM FROM THE REMAINING PORTION OF AN ITEM SHALL BE COMPLETELY THROUGH SAID ITEM. THE CONTRACTOR SHALL DETERMINE IF AN ITEM CONTAINS REINFORCING STEEL AND SHALL MAKE THE APPROPRIATE ACCOMMODATIONS TO SAW THROUGH THE STEEL. THE COST FOR SAWCUTTING SHALL BE INCLUDED IN THE UNIT PRICE OF THE ITEM SAWED.

DEMOLITION PLAN
SCALE: 1"=20'

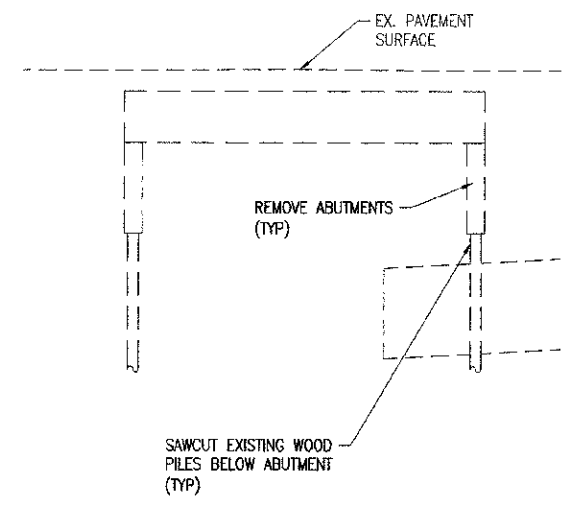

SECTION VIEW THROUGH BRIDGE CENTER
SCALE: 1"=10'

Nov 08, 2012 - 4:15pm \\systems\cadd\02841.DS\02841.DS-06 - Demolition Plan.dwg

REVISIONS:		DATE	BY	DESCRIPTION	DATE	BY	DESCRIPTION
10-22-12	JR			REVISED PLANS PER COMMENTS FROM IDOT, HANOVER PARK, & NORTH COOK SWCD.			
11-08-12	JR			REVISED PLANS PER COMMENTS FROM IDOT DATED 11-02-12.			

PLOTTED BY:	AMR
CHECKED BY:	JR
DRAWN BY:	AMR
CHECKED BY:	JR
APPROVED BY:	DWM

	Pavia-Marting & Co.
	910 W. Lake St.
	Roselle, IL 60172
	630-529-8090 Fax: 630-894-4910

TITLE:	LONGMEADOW LANE BOX CULVERT REPLACEMENT HANOVER PARK, IL DEMOLITION PLAN
SCALE:	AS NOTED
DATE:	8/6/2012
JOB NO.:	02841.DS
SHEET:	6 OF 20