

STORM STRUCTURES						
NO.	STATION	OFFSET	TYPE	FRAME	RIM/EP	INVERTS
CB-1	209+76	23' RT	CATCH BASIN, TYPE C	TY 24 F&G	638.82 EP	636.81 12" W
CB-2	203+76	23.5' LT	CATCH BASIN, TYPE A, 4' DIA	TY 24 F&G	638.71 EP	633.12 18" E (EX); 633.12 18" W
CB-3	205+52	27.6' RT	CATCH BASIN, TYPE C	TY 24 F&G	639.89 EP	636.65 12" SE
CB-4	205+09	26.6' LT	CATCH BASIN, TYPE C	TY 24 F&G	639.46 EP	635.31 12" SE
CB-5	206+35	29.5' RT	CATCH BASIN, TYPE C	TY 24 F&G	640.16 EP	636.18 12" NE
CB-6	206+45	29.5' RT	CATCH BASIN, TYPE C	TY 24 F&G	640.35 EP	636.90 12" W
EX CB-1	205+04	22.9' LT	EX CATCH BASIN	TY 1 FR, CLID	-	635.62 12" W (EX); 633.63 18" E & SW (EX); 635.13 12" NW
EX CB-2	206+42	23.3' LT	EX CATCH BASIN	TY 1 FR, CLID	-	636.00 12" E (EX); 635.80 12" W (EX); 636.00 12" SW
EX CB-3	206+45	19.1' RT	EX CATCH BASIN	TY 1 FR, CLID	-	638.14 12" NE (EX); 636.59 12" W (EX); 636.70 12" E
EX MH-2	205+27	42.8' RT	EX MANHOLE	TY 24 F&G	640.03 EP	635.256 10" W (PLUG); 635.16 12" E (EX); 635.26 10" (x2) SW (EX); 636.05 12" NW
MH-1	203+76	31.4' LT	MANHOLE, TYPE A, 4'-DIA	TY 1 FR, CLID	638.90 RIM	633.08 18" E & S
MH-2	202+25	34.3' LT	MANHOLE, TYPE A, 4'-DIA	TY 1 FR, CLID	638.25 RIM	632.32 18" SW & N
CB-2A	202+07	42.6' LT	CATCH BASIN, TYPE A, 5'-DIA	TY 1 FR, CLID	638.19 RIM	632.12 18" NE; 631.71 24" E (EX); 631.53 24" SW (EX)
MH-2B	201+94	49' LT	MANHOLE, TYPE A, 5'-DIA, RESTRICTOR PLATE	TY 1 FR, CLID	638.26 RIM	631.50 24" NE & SW (EX); RESTRICTOR 631.60 15"

NOTES:
 1. THE GENERAL CONTRACTOR IS REQUIRED TO HIRE AN ENVIRONMENTAL FIRM WITH AT LEAST (5) FIVE DOCUMENTED LEAKING UNDERGROUND STORAGE TANK CLEANUPS OR THAT IS PRE-QUALIFIED IN HAZARDOUS WASTE BY THE DEPARTMENT TO REMEDIATE THE SOIL CONTAMINATION AND MONITOR FOR WORKER PROTECTION.

STORM PIPES					
NO.	TYPE	LENGTH (LF)	DIA (IN)	SLOPE	TBF (CY)
P-1	SS, CL A, TYPE 1	5	12	0.00%	0.7
P-2	SS, CL A, TYPE 1	3	18	0.50%	1.9
P-3	SS, CL A, TYPE 1	7	18	0.50%	3.3
P-4	SS, CL A, TYPE 1	151	18	0.50%	59.0
P-5	SS, CL A, TYPE 1	19	18	1.00%	0.0
P-6	SS, CL A, TYPE 1	30	12	2.00%	5.8
P-7	SS (WATER MAIN REQUIREMENTS)	6	12	3.00%	1.6
P-8	SS, CL A, TYPE 1	9	12	2.00%	2.3
P-9	SS, CL A, TYPE 1	10	12	2.00%	2.0

WAUKEGAN ROAD (IL-43)

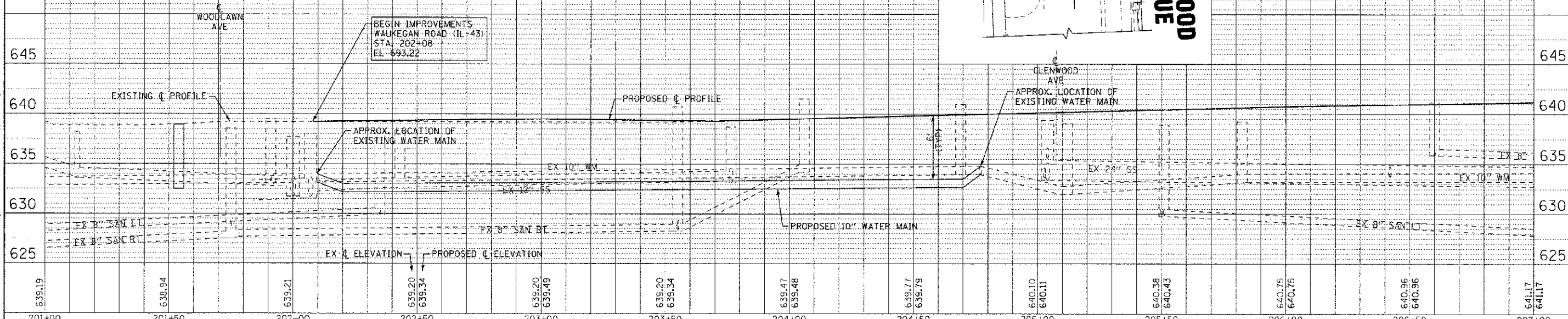

639.19	630.94	639.21	639.20	639.34	639.20	639.34	639.47	639.48	639.77	639.79	640.10	640.11	640.38	640.43	640.75	640.75	640.96	640.96	641.17	641.17
201+00	201+50	202+00	202+50	203+00	203+50	204+00	204+50	205+00	205+50	206+00	206+50	207+00								