

STORM STRUCTURES						
NO.	STATION	OFFSET	TYPE	FRAME	RIM/EP	INVERTS
EX CB-19	302+88	14.4' RT	EX CATCH BASIN	TY 1 FR, CLUD	-	632.69 12" N (EX); 632.80 12" S
CB-28	302+88	22' RT	CATCH BASIN, TYPE C	TY 24 F&G	635.48 EP	632.87 12" N
EX CB-20	306+03	29' LT	EX CATCH BASIN	EXISTING	-	635.75 12" SE (EX); 637.30 12" S
IN-3	306+05	23.5' LT	INLET, TYPE A	TY 24 F&G	640.33 EP	637.50 12" N

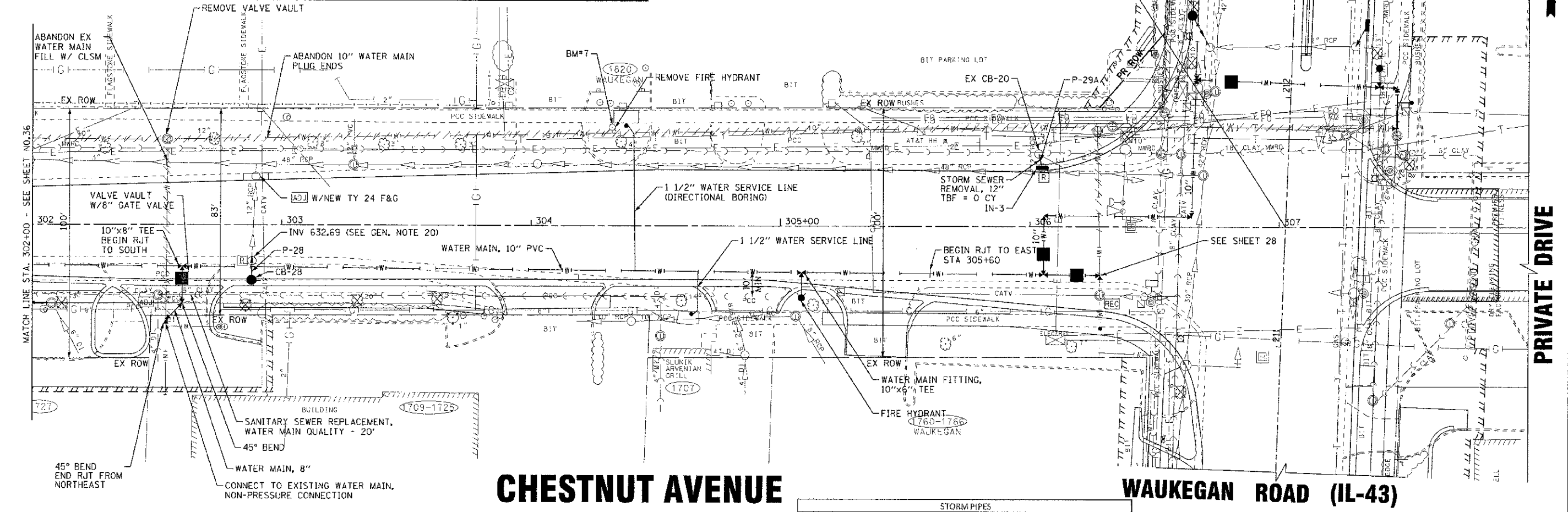

CHESTNUT AVENUE

WAUKEGAN ROAD (IL-43)

STORM PIPES					
NO.	TYPE	LENGTH (LF)	DIA (IN)	SLOPE	TBF (CY)
P-28	SS (WATER MAIN REQUIREMENTS)	7	12	1.00%	1.3
P-29A	SS, CL, TYPE 1	5	12	4.00%	0.8

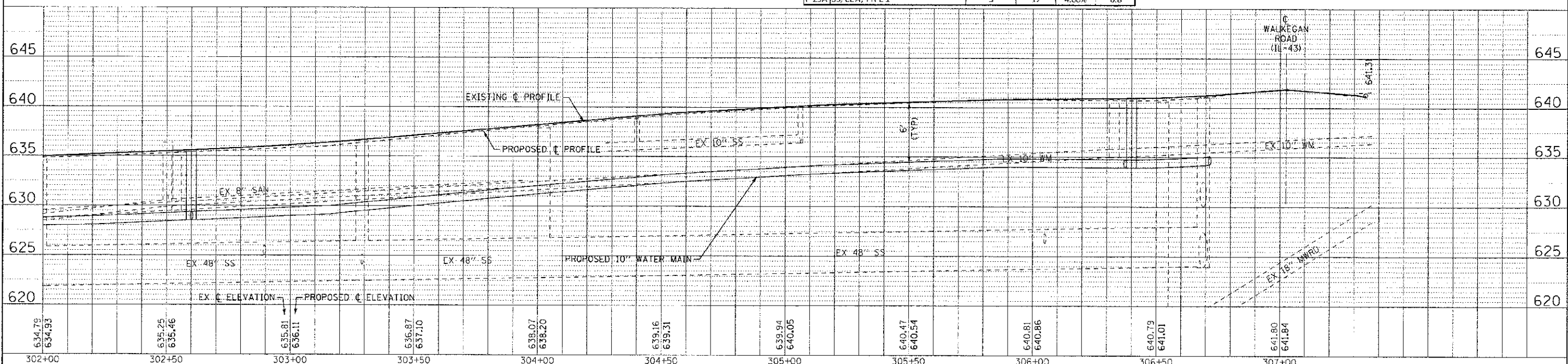

DESIGNED - DSH	REVISED - 10-12-12 PER VILLAGE
DRAWN - MAC	REVISED -
CHECKED - TLH	REVISED -
DATE - 8/23/12	FILE - 110025-12-DU6.spl

STATE OF ILLINOIS
DEPARTMENT OF TRANSPORTATION

DRAINAGE AND UTILITY
CHESTNUT AVENUE

SCALE: H: 1"=20' V: 1"=5'
STA. 302+00 TO STA. 307+02.50

F.A.P./F.A.U. RTE.	SECTION	COUNTY	TOTAL SHEETS	SHEET NO.
0348/1352	05-00160-00-CH	COOK	109	37
C-91-070-06		CONTRACT NO. 63756		
FED. ROAD DIST. NO. 1 ILLINOIS		FED. AID PROJECT F-0348(35)		

COPYRIGHT © 2012 BY BAXTER & WOODMAN, INC.
 5741 CT. ILLINOIS - PROFESSIONAL DESIGN FIRM
 60012-1000 - CHICAGO, ILLINOIS
 312.467.1000 - FAX 312.467.1001
 WWW.BAXTERANDWOODMAN.COM