

- LEGEND**
- CLASS B OR D PATCHES
 - HOT-MIX ASPHALT SURFACE REMOVAL - BUTT JOINT
 - HOT-MIX ASPHALT SURFACE REMOVAL, 2" SPECIAL OR VARIABLE DEPTH
 - EXISTING CONCRETE SIDEWALK OR DRIVEWAY TO REMAIN IN PLACE
 - SIDEWALK OR PCC DRIVEWAY REMOVAL AND REPLACEMENT
 - HOT-MIX ASPHALT DRIVEWAY REMOVAL AND REPLACEMENT
 - STRUCTURE TO BE ADJUSTED
 - NEW F&G/LID TYPE (WHERE SHOWN)
 - STRUCTURE TO BE REMOVED

NOTES:
1. SEE "PAVEMENT MARKING, SIGNING, SIDEWALK AND DRIVEWAY PLAN" FOR SIDEWALK AND DRIVEWAY INFORMATION.

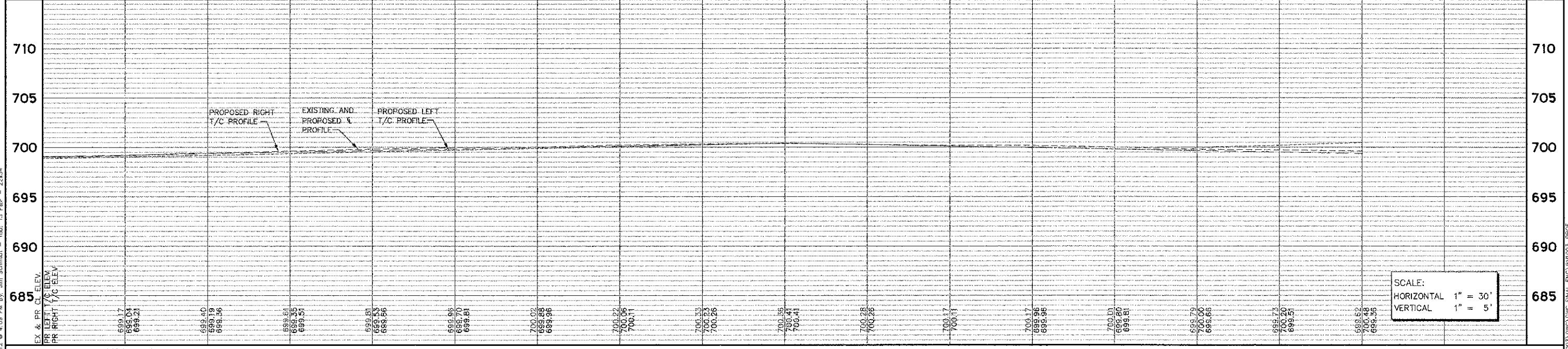

SCALE:
HORIZONTAL 1" = 30'
VERTICAL 1" = 5'

Engineering Enterprises, Inc. CONSULTING ENGINEERS 52 Wheeler Road Sugar Grove, Illinois 60554 630.466.6700 / www.eeiweb.com		USER NAME =	DESIGNED - SWM/TW/J	REVISED -	STATE OF ILLINOIS DEPARTMENT OF TRANSPORTATION		BATAVIA ROAD PLAN AND PROFILE		F.A.U. RTE. 3553	SECTION 10-00031-00-RS	COUNTY DUPAGE	TOTAL SHEETS 29	SHEET NO. 13
PLLOT SCALE =	PLLOT DATE =	CHECKED - JRL	DATE - 8/24/12	REVISED -					SCALE: 1"=30'	SHEET NO. 3 OF 5 SHEETS	STA. 2058+50 TO STA. 2066+50	FED. ROAD DIST. NO. 1	ILLINOIS

Printed: October 18, 2012 @ 4:09 PM By: Jim Schmidt - Tab: 13 Page - 23x34
 Copyright © 2012 Engineering Enterprises, Inc.

File: R:\5185RPO\WV1003\DWG\1016.FINAL_ENG_WV1003-PROF