

- LEGEND**
- CLASS B OR D PATCHES
 - HOT-MIX ASPHALT SURFACE REMOVAL - BUTT JOINT
 - HOT-MIX ASPHALT SURFACE REMOVAL, 2" SPECIAL OR VARIABLE DEPTH
 - EXISTING CONCRETE SIDEWALK OR DRIVEWAY TO REMAIN IN PLACE
 - SIDEWALK OR PCC DRIVEWAY REMOVAL AND REPLACEMENT
 - HOT-MIX ASPHALT DRIVEWAY REMOVAL AND REPLACEMENT
 - STRUCTURE TO BE ADJUSTED
 - NEW F&G/LID TYPE (WHERE SHOWN)
 - STRUCTURE TO BE REMOVED

- NOTES:**
- SEE "PAVEMENT MARKING, SIGNING, SIDEWALK AND DRIVEWAY PLAN" FOR SIDEWALK AND DRIVEWAY CALLOUTS
 - THE GAS MART USA AT THE NORTHEAST CORNER OF BATAVIA ROAD AND WARRENVILLE ROAD WAS IDENTIFIED AS A REC IN THE PHASE I STUDY. ANY SOIL OR STONE EXCAVATION ADJACENT TO THIS PROPERTY MUST REMAIN ON SITE. NO SOIL TESTING HAS BEEN CONDUCTED, BUT IN CASE DURING CONSTRUCTION NON SPECIAL WASTE IS DETECTED, THE FOLLOWING PAY ITEMS SHALL BE USED:
 NON-SPECIAL WASTE DISPOSAL 6 CU YD
 SPECIAL WASTE PLANS AND REPORTS 1 LSUM

- HOT-MIX ASPHALT SURFACE REMOVAL, 2" SPECIAL, 2356 SQ YD
- BITUMINOUS MATERIALS (PRIME COAT), 236 GALLON
- AGGREGATE (PRIME COAT), 5 TON
- HOT-MIX ASPHALT SURFACE COURSE, MIX "D", N70, 2", 264 TON

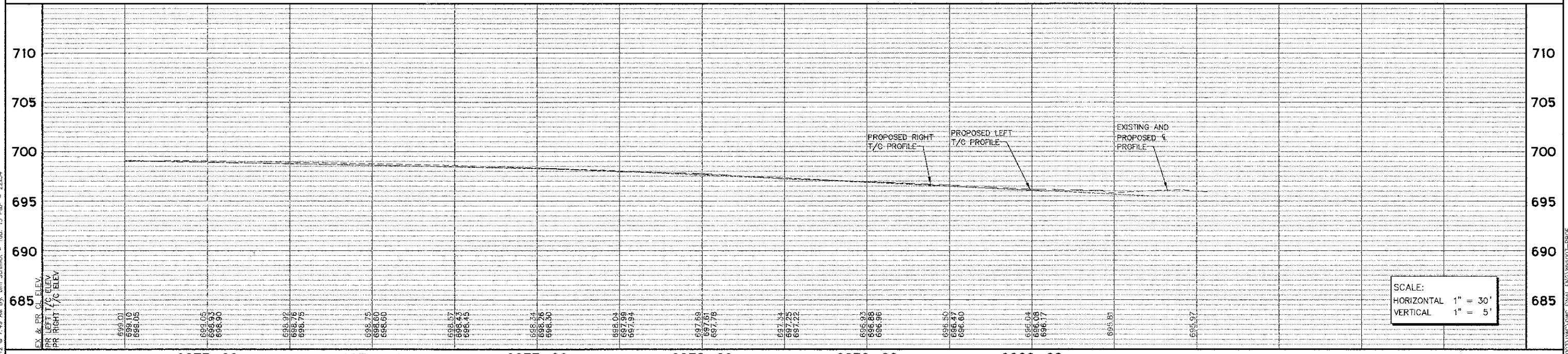

Engineering Enterprises, Inc.
 CONSULTING ENGINEERS
 52 Wheeler Road
 Skokie, Illinois 60054
 830.466.6700 / www.eeiweb.com

USER NAME =	DESIGNED - SWM/TWV	REVISIONS
PLOT SCALE =	DRAWN - KKP/CLN/JPS	REVISIONS
PLOT DATE =	CHECKED - JRL	REVISIONS
	DATE - 8/24/12	REVISIONS

**STATE OF ILLINOIS
 DEPARTMENT OF TRANSPORTATION**

BATAVIA ROAD PLAN AND PROFILE

SCALE: 1"=30'
 SHEET NO. 5 OF 5 SHEETS
 STA. 2074+50 TO STA. 2080+80

F.A.U. RTE.	SECTION	COUNTY	TOTAL SHEETS	SHEET NO.
3553	10-00031-00-RS	DUPAGE	29	15
FED. ROAD DIST. NO. 1 ILLINOIS			CONTRACT NO. 63758	
FED. AID PROJECT - M-9003(B66)				

Printed: October 19, 2012 @ 7:49 AM By: Jim Schmidt - Tab: 15 P&P - 22434
 COPY/RIGHT © 2012 ENGINEERING ENTERPRISES, INC.

Path: S:\SHPROJ\Warrenville\DWG\FINAL_ENG\WV003-PROF