

DATE		
BY		
REVISIONS		
NO. 1	DATE	DESCRIPTION
NO. 2		
NO. 3		
NO. 4		
NO. 5		
NO. 6		
NO. 7		
NO. 8		
NO. 9		
NO. 10		
NO. 11		
NO. 12		
NO. 13		
NO. 14		
NO. 15		
NO. 16		
NO. 17		
NO. 18		
NO. 19		
NO. 20		
NO. 21		
NO. 22		
NO. 23		
NO. 24		
NO. 25		
NO. 26		
NO. 27		
NO. 28		
NO. 29		
NO. 30		
NO. 31		
NO. 32		
NO. 33		
NO. 34		
NO. 35		
NO. 36		
NO. 37		
NO. 38		
NO. 39		
NO. 40		
NO. 41		
NO. 42		
NO. 43		
NO. 44		
NO. 45		
NO. 46		
NO. 47		
NO. 48		
NO. 49		
NO. 50		
NO. 51		
NO. 52		
NO. 53		
NO. 54		
NO. 55		
NO. 56		
NO. 57		
NO. 58		
NO. 59		
NO. 60		
NO. 61		
NO. 62		
NO. 63		
NO. 64		
NO. 65		
NO. 66		
NO. 67		
NO. 68		
NO. 69		
NO. 70		
NO. 71		
NO. 72		
NO. 73		
NO. 74		
NO. 75		
NO. 76		
NO. 77		
NO. 78		
NO. 79		
NO. 80		
NO. 81		
NO. 82		
NO. 83		
NO. 84		
NO. 85		
NO. 86		
NO. 87		
NO. 88		
NO. 89		
NO. 90		
NO. 91		
NO. 92		
NO. 93		
NO. 94		
NO. 95		
NO. 96		
NO. 97		
NO. 98		
NO. 99		
NO. 100		

MATCH LINE STA. 56+50

NOTE:
ALL WATERMAIN TO BE ABANDONED
SHALL BE CUT AND CAPPED

NOTE:
NO UTILITY WORK AFTER
STATION 61+85.60. SEE
SHEET 10 FOR REMOVAL
AND PROPOSED CONDITION

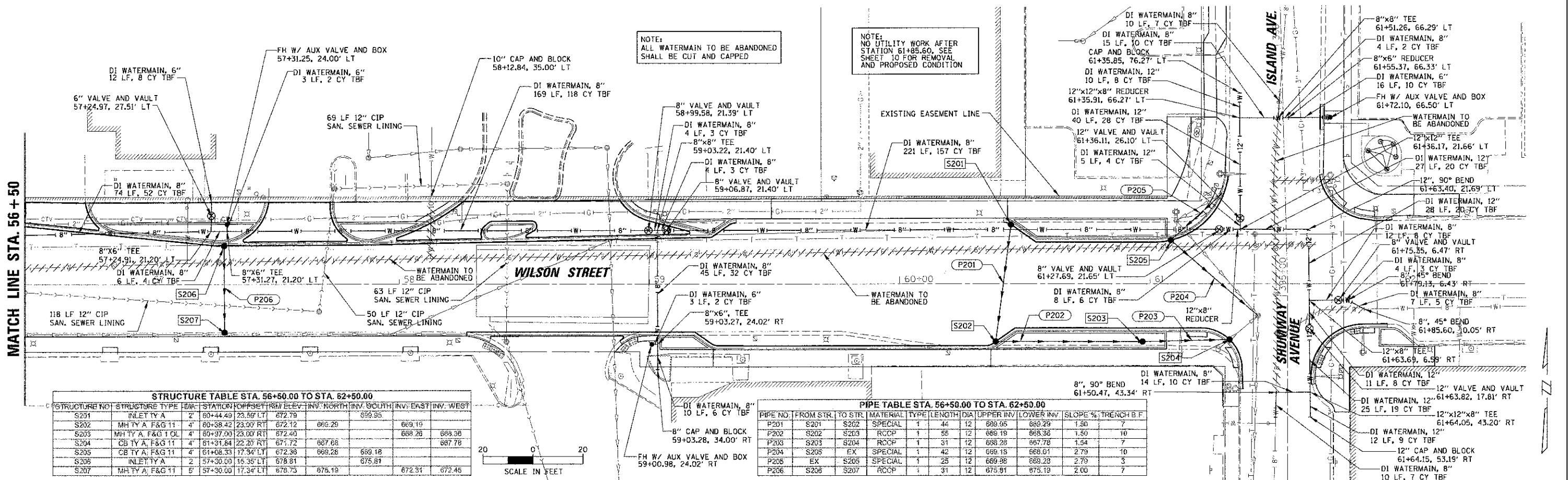

STRUCTURE TABLE STA. 56+50.00 TO STA. 62+50.00

STRUCTURE NO.	STRUCTURE TYPE	DIA.	STATION	OFFSET	INVERT ELEV.	INV. NORTH	INV. SOUTH	INV. EAST	INV. WEST
S201	INLET TY A	2'	60+44.49	23.59' LT	672.79		669.29	669.95	
S202	MH TY A F&G 11	4'	60+38.42	23.00' RT	672.12		669.19	669.38	
S203	MH TY A F&G 10L	4'	60+37.00	23.00' RT	672.40		668.26	668.38	
S204	CB TY A F&G 11	4'	61+31.64	22.20' RT	671.72		667.68	667.78	
S205	CB TY A F&G 11	4'	61+08.33	17.34' LT	672.38		669.18		
S206	INLET TY A	2'	57+30.00	15.35' LT	678.81		675.81		
S207	MH TY A F&G 11	5'	57+30.00	17.34' LT	678.73		675.19	672.45	

PIPE TABLE STA. 56+50.00 TO STA. 62+50.00

PIPE NO.	FROM STR.	TO STR.	MATERIAL	TYPE	LENGTH	DIA.	UPPER INV.	LOWER INV.	SLOPE %	TRENCH B.F.
P201	S201	S202	SPECIAL	1	44	12	669.95	669.29	1.50	7
P202	S202	S203	RCCP	1	55	12	669.19	668.38	1.50	10
P203	S203	S204	RCCP	1	31	12	668.26	667.78	1.54	7
P204	S205	EX	SPECIAL	1	42	12	669.18	668.01	2.79	10
P205	EX	S205	SPECIAL	1	25	12	669.98	669.28	2.79	3
P206	S206	S207	RCCP	1	31	12	675.81	675.19	2.00	7

DATE		
BY		
REVISIONS		
NO. 1	DATE	DESCRIPTION
NO. 2		
NO. 3		
NO. 4		
NO. 5		
NO. 6		
NO. 7		
NO. 8		
NO. 9		
NO. 10		
NO. 11		
NO. 12		
NO. 13		
NO. 14		
NO. 15		
NO. 16		
NO. 17		
NO. 18		
NO. 19		
NO. 20		
NO. 21		
NO. 22		
NO. 23		
NO. 24		
NO. 25		
NO. 26		
NO. 27		
NO. 28		
NO. 29		
NO. 30		
NO. 31		
NO. 32		
NO. 33		
NO. 34		
NO. 35		
NO. 36		
NO. 37		
NO. 38		
NO. 39		
NO. 40		
NO. 41		
NO. 42		
NO. 43		
NO. 44		
NO. 45		
NO. 46		
NO. 47		
NO. 48		
NO. 49		
NO. 50		
NO. 51		
NO. 52		
NO. 53		
NO. 54		
NO. 55		
NO. 56		
NO. 57		
NO. 58		
NO. 59		
NO. 60		
NO. 61		
NO. 62		
NO. 63		
NO. 64		
NO. 65		
NO. 66		
NO. 67		
NO. 68		
NO. 69		
NO. 70		
NO. 71		
NO. 72		
NO. 73		
NO. 74		
NO. 75		
NO. 76		
NO. 77		
NO. 78		
NO. 79		
NO. 80		
NO. 81		
NO. 82		
NO. 83		
NO. 84		
NO. 85		
NO. 86		
NO. 87		
NO. 88		
NO. 89		
NO. 90		
NO. 91		
NO. 92		
NO. 93		
NO. 94		
NO. 95		
NO. 96		
NO. 97		
NO. 98		
NO. 99		
NO. 100		

