

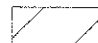

REMOVAL LEGEND

-  HMA SURFACE REMOVAL
-  REMOVAL LIMITS
-  PIPE TO BE REMOVED
-  TREE REMOVAL

IMPROVEMENT BEGINS
STA. 207+06.00

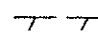

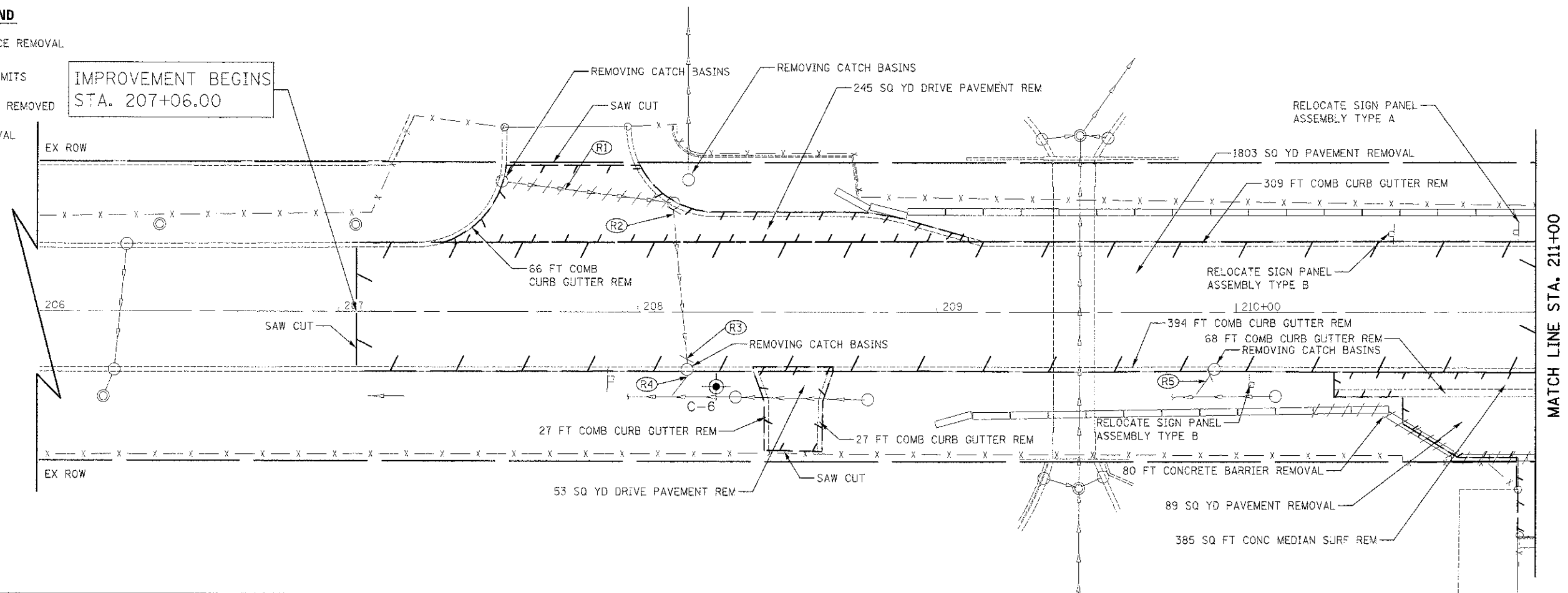
31ST STREET

GOLFVIEW AVENUE
MATCH LINE STA. 10+75
SEE SHEET NO. 23

IMPROVEMENT ENDS
STA. 216+00.00

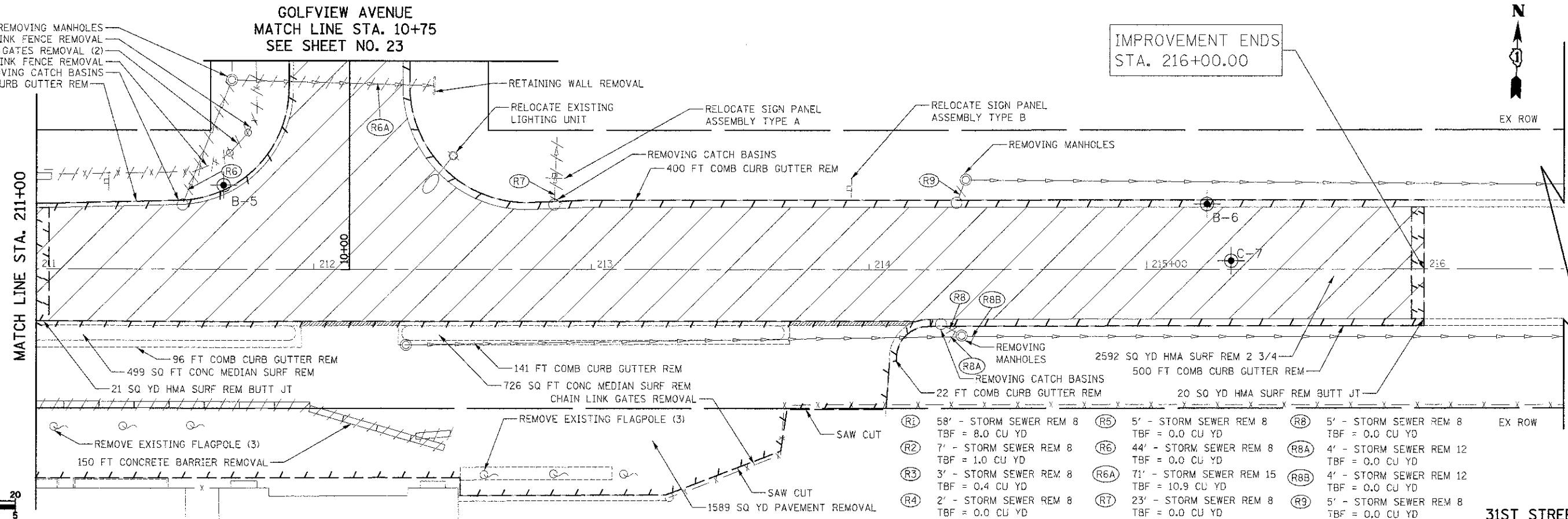

31ST STREET

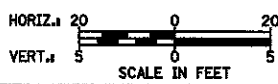

FILE NAME = ...N07-Removals\2563_REM.dgn	USER NAME = dte	DESIGNED - DTE	REVISED -
		DRAWN - DTE	REVISED -
		CHECKED - GAB	REVISED -
		DATE - 10/22/2012	REVISED -

**STATE OF ILLINOIS
DEPARTMENT OF TRANSPORTATION**

REMOVAL PLAN

SCALE: 1" = 20' SHEET NO. 1 OF 6 SHEETS STA. 207+26 TO STA. 216+00

F.A.U. RTE. 3784	SECTION 12-F3000-23-PK	COUNTY COOK	TOTAL SHEETS 133	SHEET NO. 22
CONTRACT NO. 63764				ILLINOIS FED. AID PROJECT

- (R1) 58' - STORM SEWER REM 8
TBF = 8.0 CU YD
- (R2) 7' - STORM SEWER REM 8
TBF = 1.0 CU YD
- (R3) 3' - STORM SEWER REM 8
TBF = 0.4 CU YD
- (R4) 2' - STORM SEWER REM 8
TBF = 0.0 CU YD
- (R5) 5' - STORM SEWER REM 8
TBF = 0.0 CU YD
- (R6) 44' - STORM SEWER REM 8
TBF = 0.0 CU YD
- (R6A) 71' - STORM SEWER REM 15
TBF = 10.9 CU YD
- (R7) 23' - STORM SEWER REM 8
TBF = 0.0 CU YD
- (R8) 5' - STORM SEWER REM 8
TBF = 0.0 CU YD
- (R8A) 4' - STORM SEWER REM 12
TBF = 0.0 CU YD
- (R8B) 4' - STORM SEWER REM 12
TBF = 0.0 CU YD
- (R9) 5' - STORM SEWER REM 8
TBF = 0.0 CU YD