

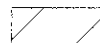

REMOVAL LEGEND

-  HMA SURFACE REMOVAL
-  REMOVAL LIMITS
-  PIPE TO BE REMOVED
-  TREE REMOVAL

**BROOKFIELD ZOO NORTH LOT
MATCH LINE STA. 100+70
SEE SHEET NO. 25**

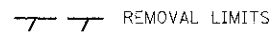

MATCH LINE STA. 10+75
SEE SHEET NO. 22

MATCH LINE STA. 16+50

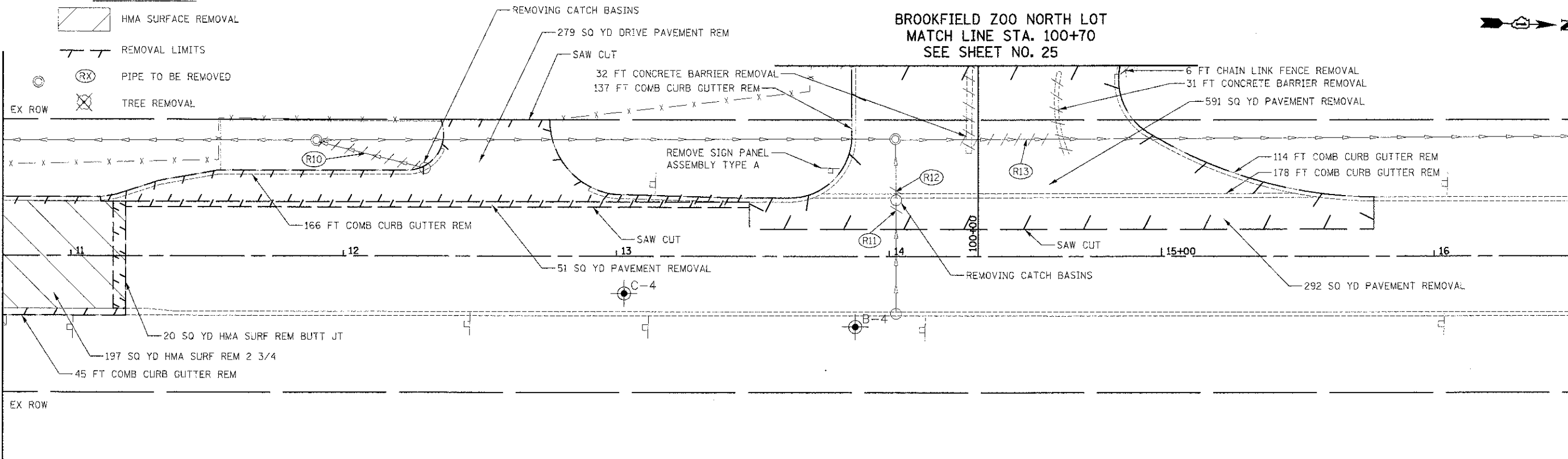

- (R10) 38" - STORM SEWER REM 8
TBF = 0.0 CU YD
- (R11) 4" - STORM SEWER REM 12
TBF = 0.8 CU YD
- (R12) 4" - STORM SEWER REM 12
TBF = 0.8 CU YD
- (R13) 33" - STORM SEWER REM 15
TBF = 10.1 CU YD

GOLFVIEW AVENUE



MATCH LINE STA. 16+50

MATCH LINE STA. 22+00
SEE SHEET NO. 24

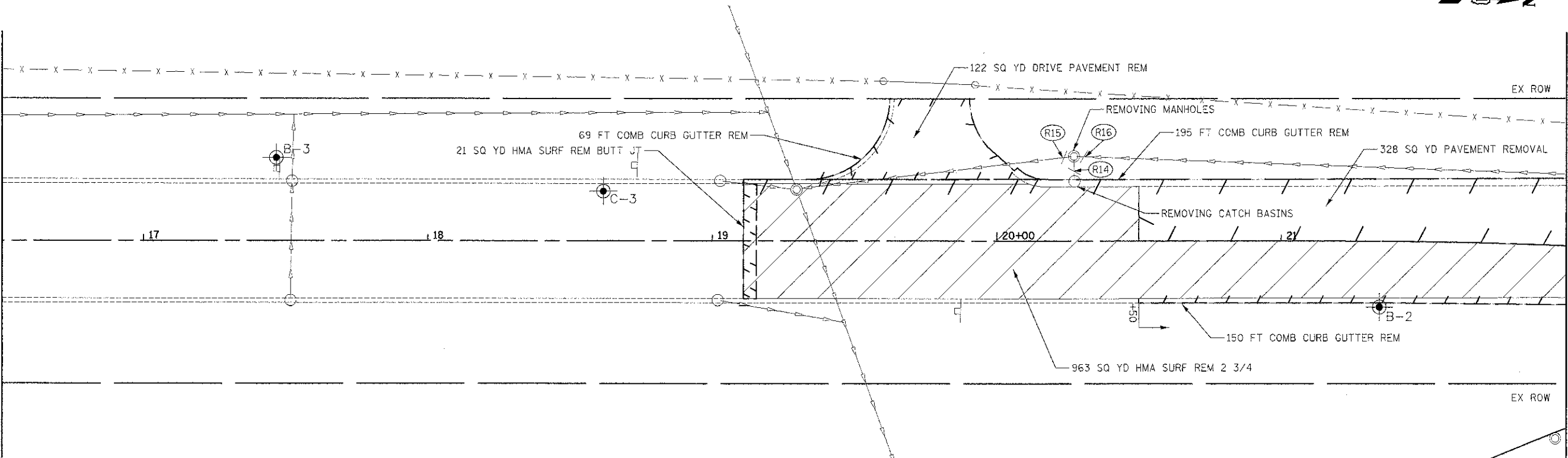

- (R14) 5" - STORM SEWER REM 8
TBF = 0.0 CU YD
- (R15) 4" - STORM SEWER REM 15
TBF = 0.0 CU YD
- (R16) 4" - STORM SEWER REM 15
TBF = 0.0 CU YD

GOLFVIEW AVENUE



FILE NAME = ...N07 Removals\29621_RCM_02.dgn	USER NAME = dte	DESIGNED - DTE	REVISED -	STATE OF ILLINOIS DEPARTMENT OF TRANSPORTATION	REMOVAL PLAN	F.A.U. RTE. 3784	SECTION 12-F3000-23-PK	COUNTY COOK	TOTAL SHEETS 133	SHEET NO. 23		
PLLOT SCALE = 20.0000' / 1"	CHECKED - GAB	DATE - 10/22/2012	REVISED -			SCALE: 1" = 20'	SHEET NO. 2 OF 6 SHEETS	STA. 10+75 TO STA. 23+00	CONTRACT NO. 63764			
PLLOT DATE = 11/9/2012			REVISED -			ILLINOIS FED. AID PROJECT						