

- NOTES**
1. SEE SHEET 56 FOR DRAINAGE STRUCTURE INFORMATION.
 2. NEW STORM STRUCTURES TO BE CUT INTO AN EXISTING STORM SEWER LINE SHALL REQUIRE 4 FEET OF NEW STORM SEWER IN EACH APPLICABLE DIRECTION. THIS WORK SHALL BE PAID FOR AS THE SAME TYPE AND SIZE OF THE EXISTING SEWER BEING TIED IN TO.

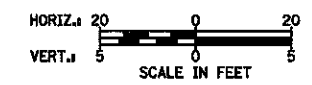

31ST STREET

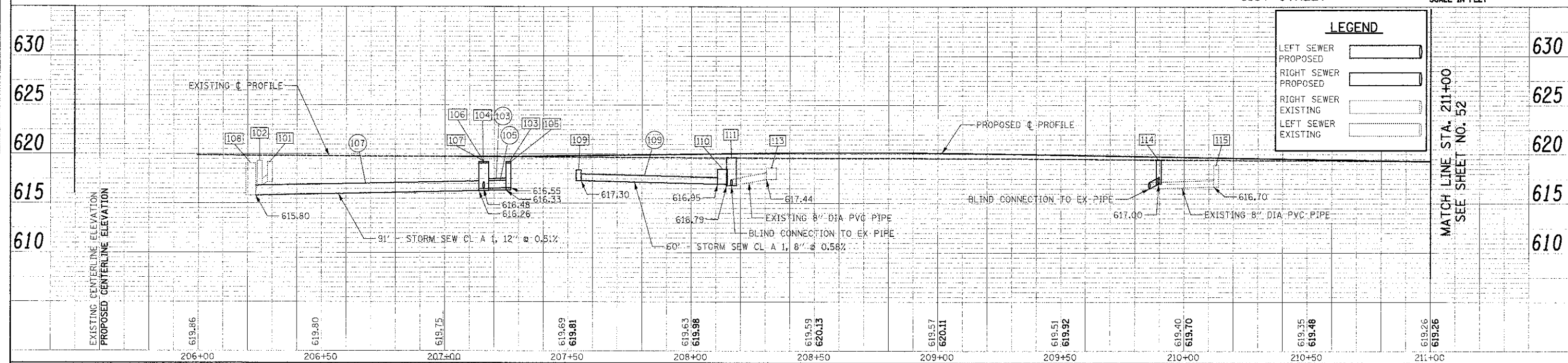

LEGEND	
LEFT SEWER PROPOSED	
RIGHT SEWER PROPOSED	
RIGHT SEWER EXISTING	
LEFT SEWER EXISTING	

DATE	
BY	
PROJECT	
PLANNING	
DESIGN	
CONSTRUCTION	
OPERATION	
MAINTENANCE	

DATE	
BY	
PROJECT	
PLANNING	
DESIGN	
CONSTRUCTION	
OPERATION	
MAINTENANCE	

FILE NAME ...2563.D&U_21.egn	USER NAME = dta	DESIGNED - JES	REVISED -	STATE OF ILLINOIS DEPARTMENT OF TRANSPORTATION	DRAINAGE AND UTILITIES	F.A.U. RT#	SECTION	COUNTY	TOTAL SHEETS	SHEET NO.	
PLLOT SCALE = 20.0000' / 1"	CHECKED - GAB	REVISED -	3784			12-F3000-23-PK	COOK	133	51		
PLLOT DATE = 11/9/2012	DATE - 10/22/2012	REVISED -	SCALE: 1" = 20'			SHEET NO. 1 OF 6 SHEETS		STA. 206+00 TO STA. 211+00		CONTRACT NO. 63764	
						FED. ROAD DIST. NO. 1 ILLINOIS		FED. AID PROJECT			