

LEGEND

- (XXX.XX) EXISTING PAVEMENT ELEVATION
- XXX.XX PROPOSED PAVEMENT ELEVATION
- EXISTING CONTOUR
- PROPOSED CONTOUR

IN THE RESURFACING AREA, ALL EXISTING ELEVATIONS WILL ALSO BE THE FINAL PROPOSED SURFACE ELEVATION.

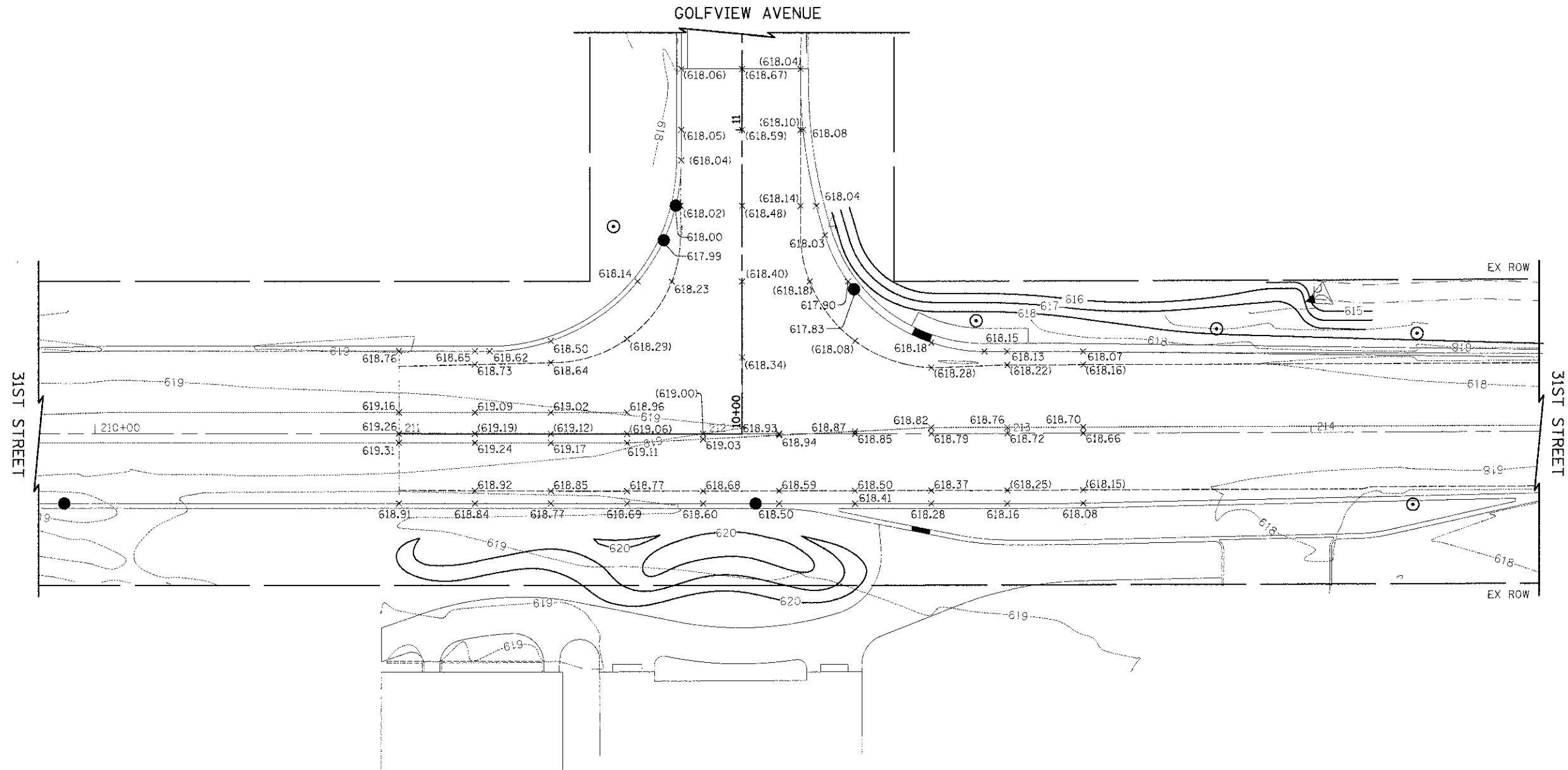

31ST STREET
GOLFVIEW AVENUE



FILE NAME = ...12-Grading\2563_INT_01.dgn	USER NAME = dte	DESIGNED DTE	REVISIONS	STATE OF ILLINOIS DEPARTMENT OF TRANSPORTATION	INTERSECTION DETAILS	F.A.U. 1 RTE. 3784	SECTION 12-F3000-23-PK	COUNTY COOK	TOTAL SHEET SHEETS NO. 133 60
PLOT SCALE = 20.0000' / 1" = 20'		CHECKED GAB	REVISIONS	SCALE: 1" = 20' SHEET NO. 1 OF 3 SHEETS STA. TO STA.		FED. ROAD DIST. NO. 1 ILLINOIS FED. AID PROJECT		CONTRACT NO. 63764	
PLOT DATE = 11/9/2012		DATE = 10/22/2012	REVISIONS						