

RELOCATED EXISTING TRAFFIC SIGNS

- 1 R2-1, 30"x36"
- 2 R3-2, 30"x30"
- 3 R7-1, 12"x18"
- 4 SPECIAL, 24"x18"
- 5 SPECIAL, 24"x18"
- 6 SPECIAL, 36"x30"
- 7 SPECIAL, 48"x24"
- 8 SPECIAL, 24"x30"
- 9 SPECIAL, 18"x24"
- 10 SPECIAL, 36" DIA
- 11 SPECIAL, 18"x18"

PROPOSED TRAFFIC SIGNS

- 12 R1-1, 30"x30"
- 13 R3-5R, 30"x36"
- 14 R4-7, 24"x30"
- 15 R4-7a, 24"x30"
- 16 R3-SPECIAL, 36"x36"
- 17 R3-SPECIAL, 36"x36"
- 18 R3-SPECIAL, 36"x36"
- 19 R3-SPECIAL, 36"x36"

PROPOSED PARKING LOT SIGNS

- 20 SPECIAL, SEE DETAIL SHEET 112
- 21 SPECIAL, SEE DETAIL SHEET 112
- 22 SPECIAL, SEE DETAIL SHEET 112
- 23 SPECIAL, SEE DETAIL SHEET 112
- 24 SPECIAL, SEE DETAIL SHEET 112
- 25 SPECIAL, SEE DETAIL SHEET 112
- 26 SPECIAL, SEE DETAIL SHEET 112
- 27 SPECIAL, SEE DETAIL SHEET 112

RAISED PAVEMENT MARKINGS LEGEND

- ONE-WAY CRYSTAL
- ONE-WAY AMBER
- TWO-WAY AMBER

NOTE:
ALL PERMANENT PAVEMENT MARKINGS SHALL BE THERMOPLASTIC UNLESS OTHERWISE NOTED.

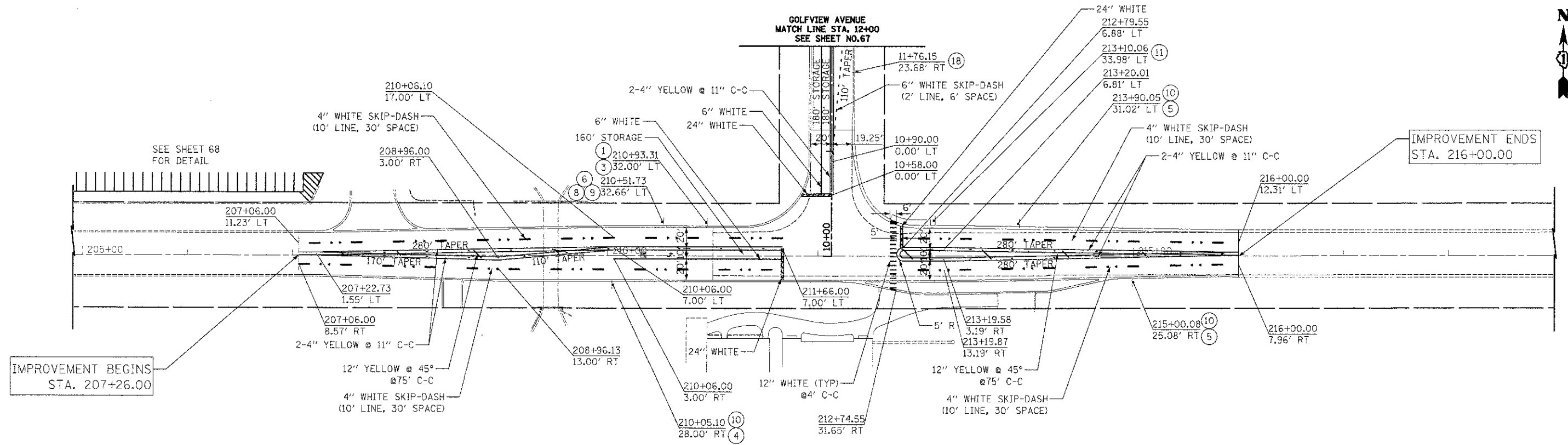

31ST STREET

FILE NAME = ... \2863_PMK_01.dgn	USER NAME = dte	DESIGNED - DTE	REVISED -	STATE OF ILLINOIS DEPARTMENT OF TRANSPORTATION	PAVEMENT MARKING AND SIGNING PLAN	F.A.U. RTE. 3784	SECTION 12-F3000-23-PX	COUNTY COOK	TOTAL SHEETS 133	SHEET NO. 66	
PLOT SCALE = 50.0000 / 1 in.	CHECKED - GAB	REVISOR -	REVISOR -			SCALE: 1" = 50'	SHEET NO. 1 OF 2 SHEETS	STA. 207+26.00 TO STA. 216+00.00	FED. ROAD DIST. NO. 1 ILLINOIS	CONTRACT NO. 63764	
PLOT DATE = 11/9/2012	DATE = 10/22/2012	REVISOR -	REVISOR -			FED. AID PROJECT					