

KEYED NOTES

- ⑬ NEW IP SECURITY CAMERA MOUNTED TO LIGHT POLE AND/OR CANOPY  
VERIFY MTG HEIGHT WITH CZS.
- ⑭ WIRELESS ACCESS POINT (AP) MOUNTED TO LIGHT POLE AND/OR CANOPY  
VERIFY MTG HEIGHT WITH CZS.
- ⑮ ADD NEW IP SECURITY CAMERA & NEW WIRELESS ACCESS POINT (AP)  
TO NORTH GATE ENTRANCE. COORDINATE EXACT LOCATION AND  
MOUNTING HEIGHT WITH CZS.



1" C W/ 2\*6, 1\*8G FOR  
RECEPTACLE BRANCH  
CIRCUIT & 2\*6, 1\*8G  
FOR ARCHWAY STRUCTURE  
FLOOD LIGHT BRANCH CIRCUIT.  
COORDINATE CONDUIT ROUTING  
& FINAL TERMINATION WITH  
CZS FACILITIES DEPARTMENT.

(10) F7 FOR  
UP-LIGHT OF  
BANNERS  
COORDINATE  
EXACT  
LOCATION WITH  
CZS SITE

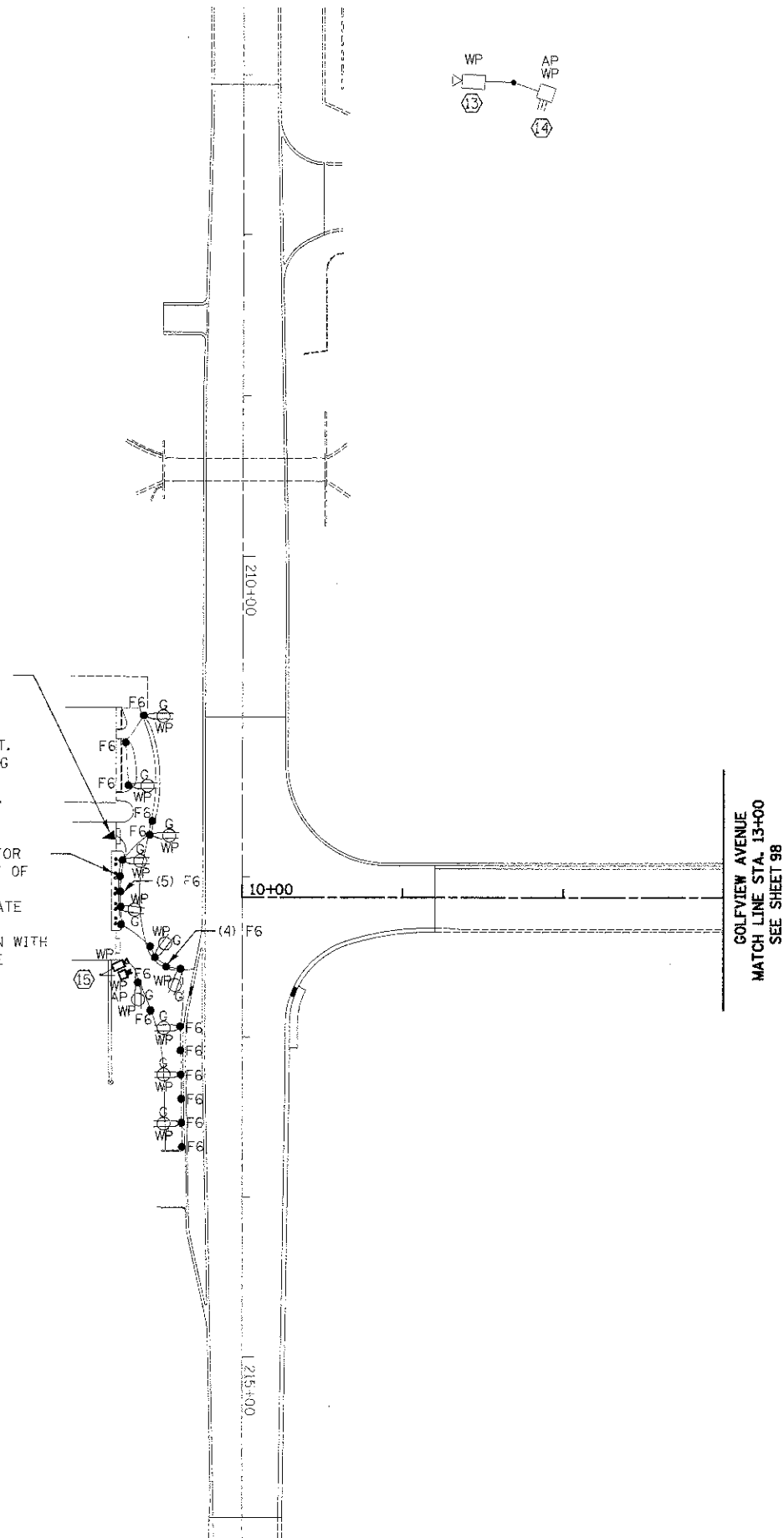

31ST STREET

FILE NAME = ...sheet\Lighting\2563.5.1.2.dgn	USER NAME = dse	DESIGNED -	REVISED -	<b>STATE OF ILLINOIS DEPARTMENT OF TRANSPORTATION</b>	<b>ELECTRICAL SITE PLAN E1.0</b>	F.A. RTE.	SECTION	COUNTY	TOTAL SHEETS	SHEET NO.	
		DRAWN -	REVISED -			3784	12-F3000-23-PK	COOK	133	97	
		CHECKED -	REVISED -			<b>CONTRACT NO. 63764</b>					
		PLT DATE = 11/9/2012	DATE -			REVISED -	SCALE: 1" = 50'	SHEET NO. 1 OF 2 SHEETS	STA.	TO STA.	FED. ROAD DIST. NO.