

F.A.P. NO.	SECTION	COUNTY	TOTAL SHEETS	SHEET NO.
311	(1) R	KENDALL	54	120
STA.	TO STA.			
FED. ROAD DIST. NO.	ILLINOIS FED. AID PROJECT			

**TRAFFIC DETOUR ROUTE NOTES**

- ALL SIGNING SHALL BE IN ACCORDANCE WITH THE APPLICABLE PROVISIONS OF THE STATE OF ILLINOIS "STANDARD SPECIFICATIONS FOR ROAD AND BRIDGE CONSTRUCTION" ADOPTED JANUARY 1, 2007 AND IN ACCORDANCE WITH IDOT STANDARD BLR-21. THE DETAILS IN THESE PLANS, AND THE LATEST EDITION OF THE STATE OF ILLINOIS "MANUAL ON UNIFORM TRAFFIC CONTROL DEVICES".
- PAYMENT FOR PLACEMENT, MAINTENANCE AND REMOVAL OF ALL TRAFFIC CONTROL DEVICES REQUIRED FOR THIS DETOUR SHALL BE INCLUDED IN THE COST FOR TRAFFIC CONTROL AND PROTECTION (SPECIAL), LOCATION 5.
- THE CONTRACTOR SHALL PROCEED WITH THE WORK IN AN EXPEDIENT MANNER TO REDUCE THE LENGTH OF TIME THAT THE DETOUR IS IN EFFECT.
- THE ENGINEER SHALL BE NOTIFIED IN WRITING AT LEAST TWO WEEKS PRIOR TO THE DAY THE ROAD IS TO BE CLOSED. THE ENGINEER WILL CONTACT THE BUREAU OF OPERATIONS AS WELL AS LOCAL, TOWNSHIP AND COUNTY OFFICIALS CONCERNING THE CLOSURE.
- THE CONTRACTOR SHALL SUPPLY TO THE ENGINEER THE NAMES AND PHONE NUMBERS OF HIS REPRESENTATIVES ON THE CONSTRUCTION SITE AND HIS REPRESENTATIVE RESPONSIBLE FOR THE DETOUR SIGNING AND MAINTENANCE PRIOR TO THE START OF WORK.
- LONGITUDINAL DIMENSIONS SHOWN ON THESE PLANS MAY BE ADJUSTED TO FIT FIELD CONDITIONS.
- THE ROAD SHALL NOT BE CLOSED UNTIL ALL SIGNING IS ERECTED IN ACCORDANCE WITH THE ROAD CLOSURE PLAN AND INSPECTED AND APPROVED BY THE ENGINEER.
- ALL EXISTING SIGNING THAT IS NOT APPLICABLE WHILE THE ROAD CLOSURE IS IN EFFECT SHALL BE COMPLETELY COVERED BY THE CONTRACTOR.
- ALL ROAD CLOSURE SIGNING SHALL BE MOUNTED AS INDICATED.
- THE SIZE OF ALL SIGNS NOT SPECIFIED IN THESE PLANS SHALL BE AS REQUIRED BY THE ILLINOIS MANUAL ON UNIFORM TRAFFIC CONTROL DEVICES AND APPLICABLE TRAFFIC STANDARDS.
- AS A MINIMUM, ALL AMBER FLASHING LIGHTS THAT ARE REQUIRED FOR THE ROAD CLOSURE SIGNING SHALL MEET THE REQUIREMENTS FOR A TYPE A - LOW INTENSITY FLASHING LIGHTS IN ARTICLE 1084.01 OF THE STANDARD SPECIFICATIONS. ALL LIGHTS SHALL OPERATE DURING HOURS OF DARKNESS. ONLY LIGHTS THAT HAVE BEEN APPROVED BY THE ILLINOIS DEPARTMENT OF TRANSPORTATION SHALL BE USED.
- THE TYPE III BARRICADES USED AT POINTS OF CLOSURE TO THRU TRAFFIC ONLY SHALL NOT EXCEED 8 FEET IN WIDTH EACH FOR A SINGLE APPROACH LANE. ALL BARRICADES AT THESE LOCATIONS SHALL HAVE REFLECTORIZED STRIPING ON THE BACK OF THE BARRICADE. THE "ROAD CLOSED TO THRU TRAFFIC" SIGN SHALL BE MOUNTED ACCORDING TO STANDARD 702001.
- THE "ROAD CLOSED" SIGN ON A TYPE III BARRICADE SHALL BE MOUNTED ACCORDING TO STANDARD 720001. ALL TYPE III BARRICADES SHALL HAVE TWO AMBER TYPE A - LOW INTENSITY FLASHING LIGHTS.
- CONSTRUCTION EQUIPMENT SHALL NOT BE PARKED IMMEDIATELY BEHIND THE TYPE III BARRICADES DURING NON-WORKING HOURS. IN ANY EVENT, ARTICLES 701 THRU 703 OF THE STANDARD SPECIFICATIONS SHALL APPLY.
- THE ENGINEER SHALL BE NOTIFIED AT LEAST TWO WEEKS BEFORE THE ROAD IS TO BE OPENED TO TRAFFIC.
- THE CONTRACTOR SHALL MAINTAIN OVERNIGHT ACCESS TO ALL PRIVATE DRIVEWAYS AND FIELD ENTRANCES DURING PERIODS OF CONSTRUCTION.
- THE "SIDEWALK CLOSED" SIGN SHALL BE MOUNTED ON A TYPE II BARRICADE AND LOCATED ACCORDING TO STANDARD 701801.

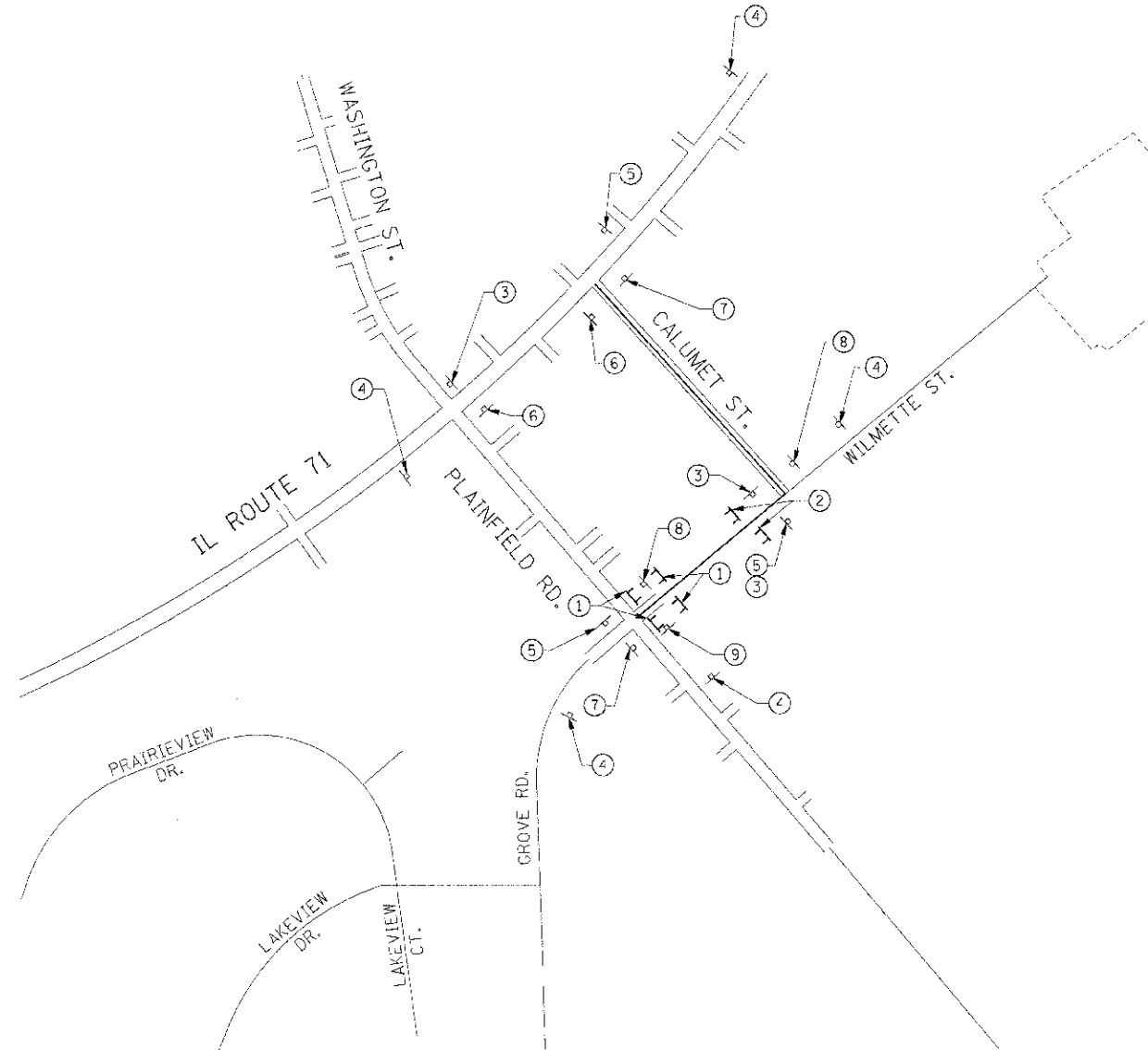

**LEGEND**

- ⊥ POST MOUNTED SIGN
- I TYPE II BARRICADE
- ⊥ TYPE III BARRICADE
- REGIONAL DETOUR ROUTE

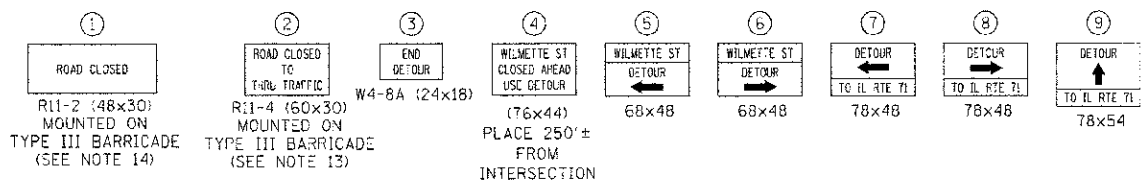

**NOTE**  
 ALL ROAD CLOSURE SIGNING EXCEPT REGULATORY SIGNS SHALL HAVE BLACK LEGENDS ON FLUORESCENT ORANGE BACKGROUNDS AND STANDARD BLACK BORDERS. ALL ROAD CLOSURE SIGNING SHALL BE NEW OR LIKE NEW CONDITION.

REVISIONS	
NAME	DATE

ILLINOIS DEPARTMENT OF TRANSPORTATION  
**DETOUR ROUTING DETAIL**  
**WILMETTE STREET**  
**LOCATION 5**  
 SCALE: NONE  
 DATE: 7/3/2012  
 DRAWN BY:  
 CHECKED BY: RG

IF HDL: 5/16/2012  
 PLOT DATE: 7/3/2012  
 FILE NAME: G:\569825\CONVIL7\DETOUR\WILMETTE.DWG