

F.A.P. R.E.	SECTION	COUNTY	TOTAL SHEETS	SHEET NO.
311	(1-D) R	KENDALL	514	125
STA.		TO STA.		
FED. ROAD DIST. NO.		ILLINOIS FED. AID PROJECT		

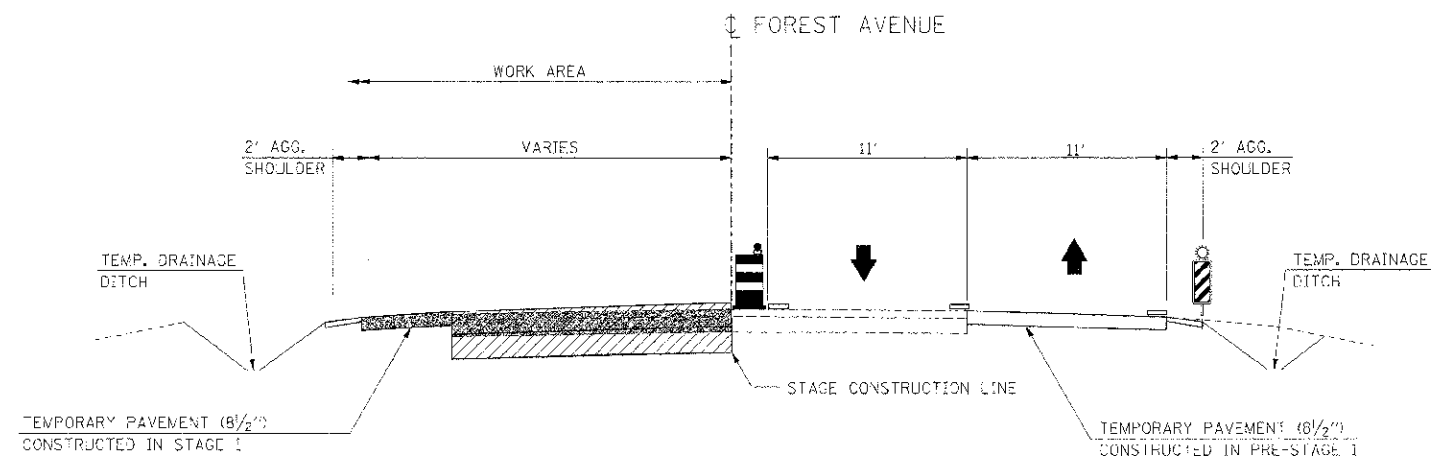

TYPICAL SECTION - STAGE 1 AND 1A

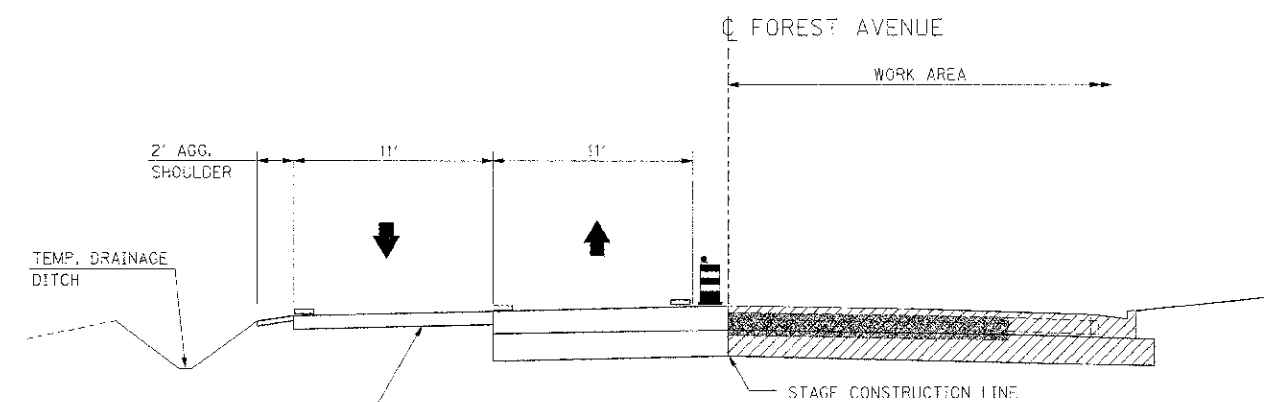



(LOOKING NORTH)
FOREST AVENUE
STA. 46+32 TO STA. 53+10



TYPICAL SECTION - STAGE 1B AND 1C

(LOOKING NORTH)
FOREST AVENUE
STA. 46+32 TO STA. 53+10

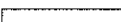
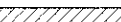
LEGEND

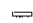
-  VERTICAL PANEL
-  DRUM WITH STEADY BURNING LIGHT
-  TRAFFIC FLOW
-  PREVIOUS STAGE CONSTRUCTION
-  CURRENT STAGE CONSTRUCTION
-  PAVEMENT REMOVAL
-  TEMPORARY PAVEMENT MARKING

REVISIONS	
NAME	DATE

ILLINOIS DEPARTMENT OF TRANSPORTATION
MAINTENANCE OF TRAFFIC
STAGE 1 & SUB-STAGES
TYPICAL SECTIONS - SIDEROADS
SCALE: NONE
DATE: 7/3/2012
DRAWN BY: AAD
CHECKED BY: RG

IE PROJ: 606805
PLOT DATE: 7/3/2012
FILE NAME: S:\915025\GROU1\11\01_7S-183587