

F.A.P. R.T.E.:	SECTION	COUNTY	TOTAL SHEETS	SHEET NO.
311	(I-D) R	KENDALL	514	130
STA.	TO STA.			
FED. ROAD DIST. NO.	ILLINOIS FED. AID PROJECT			

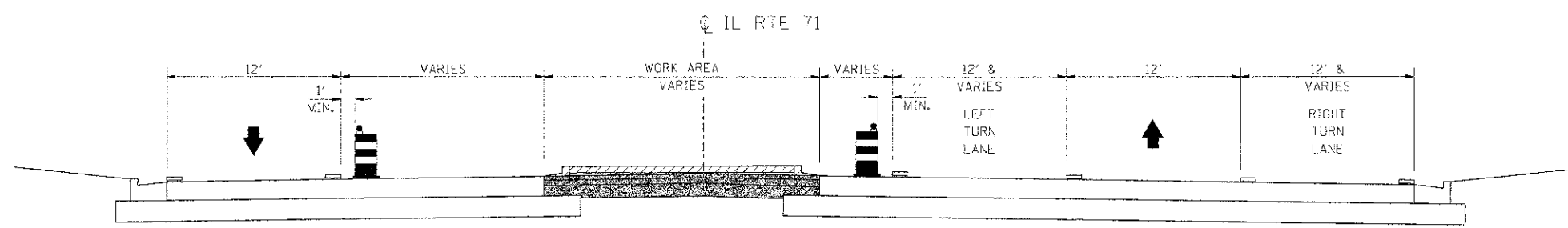

TYPICAL SECTION
(LOOKING EAST)
STA. 859+80 TO STA. 863+44.48
STA. 874+00 TO STA. 880+24.08

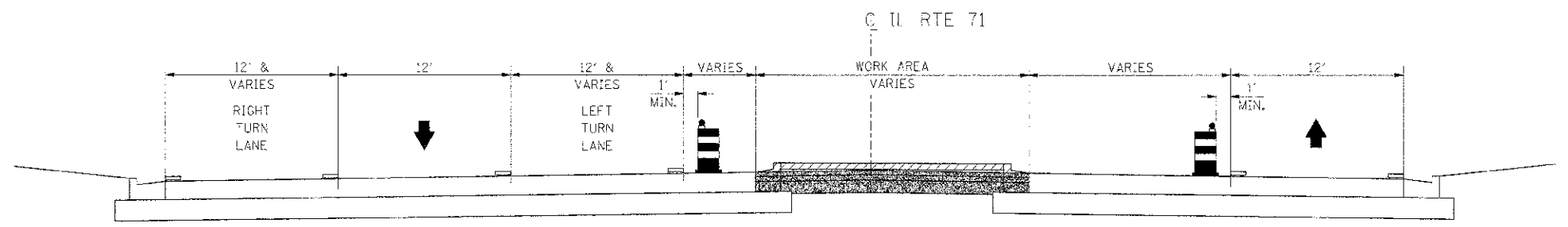

TYPICAL SECTION
(LOOKING EAST)
STA. 863+44.48 TO STA. 870+00
STA. 880+24.08 TO STA. 884+00

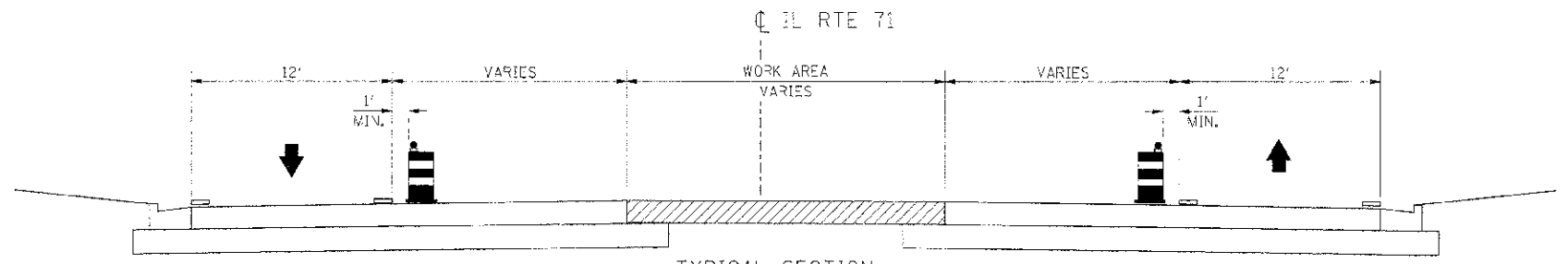



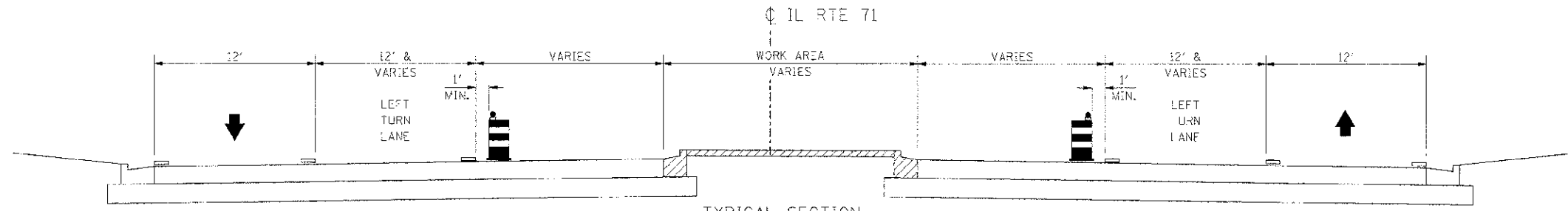

TYPICAL SECTION
(LOOKING EAST)
STA. 808+00 TO STA. 812+50



TYPICAL SECTION
(LOOKING EAST)
STA. 812+50 TO STA. 859+80
STA. 870+00 TO STA. 874+00
STA. 884+00 TO STA. 918+86

NOTE:
SEE "MAINTENANCE OF TRAFFIC" SHEETS FOR LIMITS OF TEMPORARY PAVEMENT TO BE REMOVED.

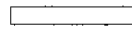
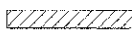
LEGEND

-  VERTICAL PANEL
-  DRJM WITH STEADY BURNING LIGHT
-  TRAFFIC FLOW
-  PREVIOUS STAGE CONSTRUCTION
-  CURRENT STAGE CONSTRUCTION
-  PAVEMENT REMOVAL
-  TEMPORARY PAVEMENT MARKING

REVISIONS	
NAME	DATE

ILLINOIS DEPARTMENT OF TRANSPORTATION
MAINTENANCE OF TRAFFIC
STAGE 3
TYPICAL SECTIONS - MAINLINE

SCALE: NONE
DATE: 7/3/2012

DRAWN BY: AAD
CHECKED BY: RC

IE PROJ: 581025
 PLOT DATE: 7/3/2012
 FILE NAME: S:\581025\CAD\1171\DOT_TS_381.SHT