

F.A.P. RTE.	SECTION	COUNTY	TOTAL SHEETS	SHEET NO.
311	(1-D) R	KENDALL	514	135
STA.		TO STA.		
FED. ROAD DIST. NO.		ILLINOIS FED. AID PROJECT		

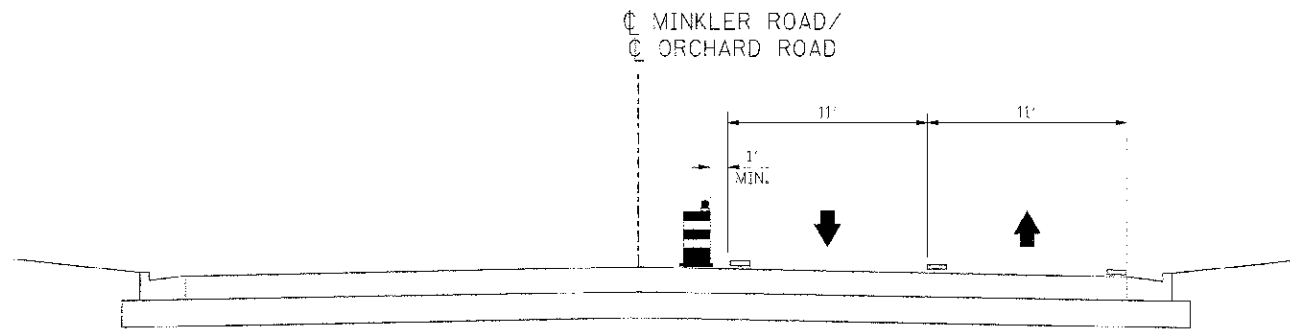

TYPICAL SECTION - STAGE 5 AND 5A

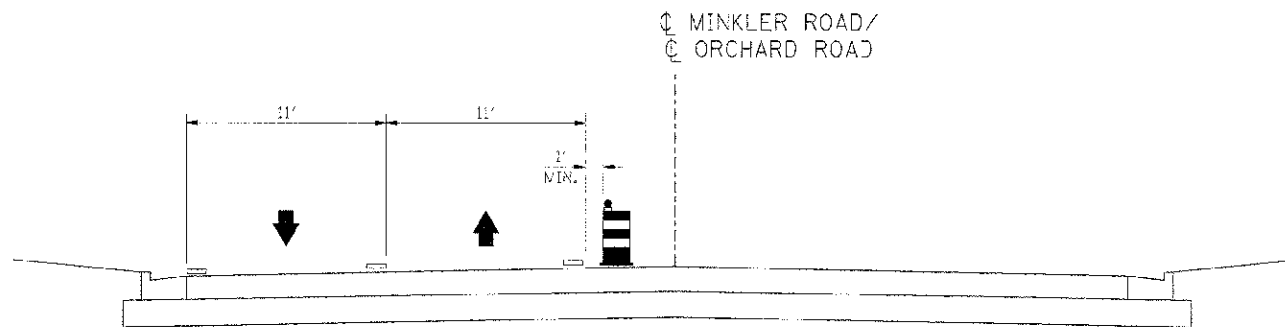





(LOOKING NORTH)  
STA. 55+00 TO STA. 71+30

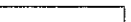

TYPICAL SECTION - STAGE 5B AND 5C

(LOOKING NORTH)  
STA. 55+00 TO STA. 71+30

**LEGEND**

-  VERTICAL PANEL
-  DRUM WITH STEADY BURNING LIGHT
-  TRAFFIC FLOW
-  PREVIOUS STAGE CONSTRUCTION
-  CURRENT STAGE CONSTRUCTION
-  PAVEMENT REMOVAL
-  TEMPORARY PAVEMENT MARKING

REVISIONS	
NAME	DATE

ILLINOIS DEPARTMENT OF TRANSPORTATION  
**MAINTENANCE OF TRAFFIC**  
**STAGE 5 & SUBSTAGES**  
**TYPICAL SECTIONS - SIDEROADS**

SCALE: NONE  
DATE: 7/3/2012  
DRAWN BY: AAD  
CHECKED BY: RG

IE PROJ. # 5070025  
 PLOT DATE: 7/3/2012  
 FILE NAME: G:\SR05\PROJECTS\171\MTT\TS\BMP5.HWT