

P.A.P. H.T.E.	SECTION	COUNTY	TOTAL SHEETS	SHEET NO.
31:	(1-1) R	KENDALL	514	143
STA. 858+00		TO STA. 873+00		
FED. ROAD DIST. NO.	ILLINOIS	FED. AID PROJECT		

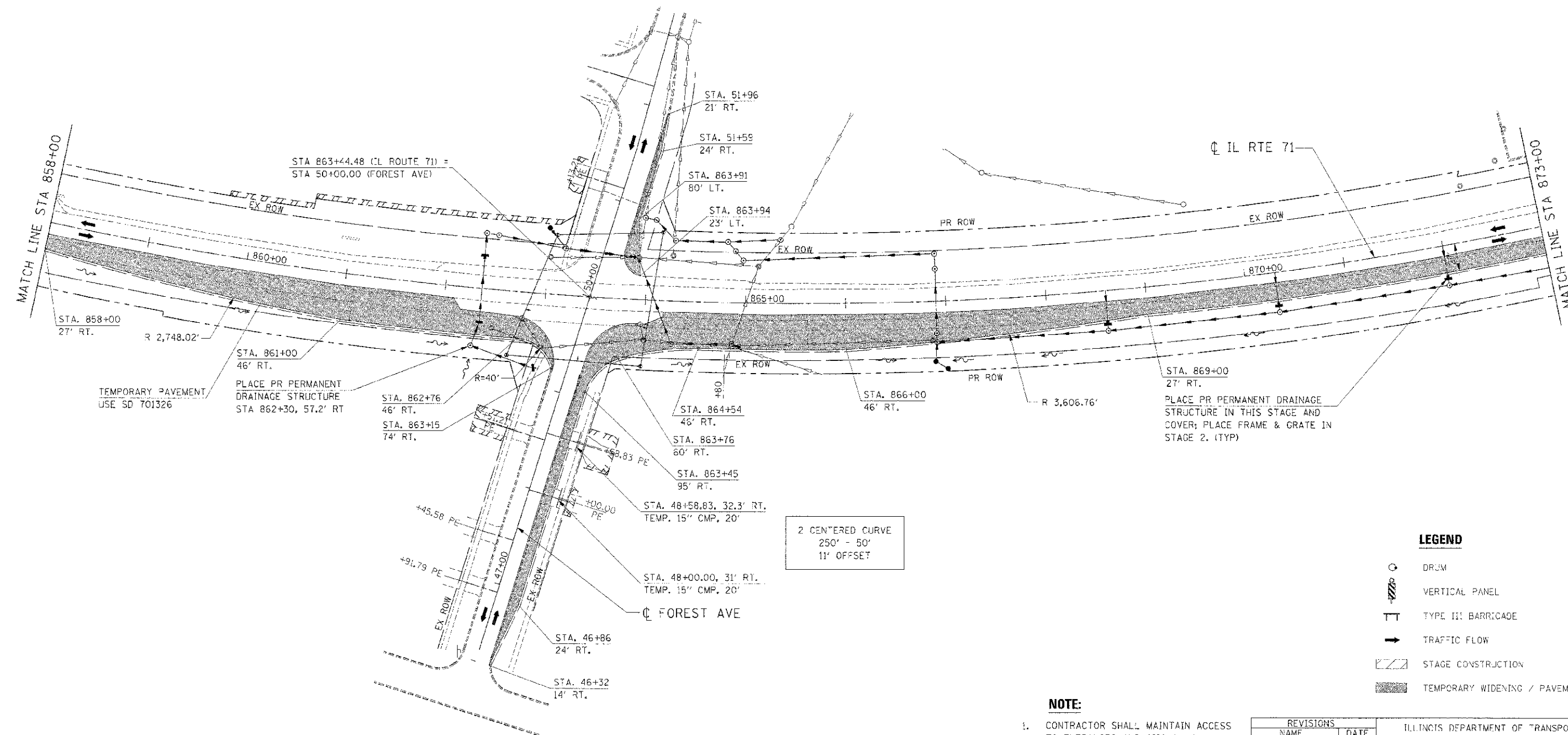
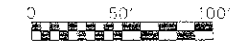

2 CENTERED CURVE
250' - 50'
11' OFFSET

LEGEND

- DRAIN
- VERTICAL PANEL
- TYPE III BARRIAGE
- TRAFFIC FLOW
- STAGE CONSTRUCTION
- TEMPORARY WIDENING / PAVEMENT

NOTE:

1. CONTRACTOR SHALL MAINTAIN ACCESS TO ENTRANCES AND SIDE ROADS AT ALL TIMES EXCEPT AS NOTED TO BE CLOSED.
2. SEE "REMOVAL PLANS" FOR LOCATIONS OF REQUIRED PATCHING FOR DRAINAGE TO BE INSTALLED IN PRE-STAGE 1.

REVISIONS	
NAME	DATE

ILLINOIS DEPARTMENT OF TRANSPORTATION

**MAINTENANCE OF TRAFFIC
PRE-STAGE 1 (IL RTE 71)
STA 858+00 TO STA 873+00**

SCALE: 1"=50'
DATE: 7/3/2012

DRAWN BY: _____
CHECKED BY: RG

IF PROJ. # 66025
PLOT DATE = 7/3/2012
FILE NAME = G:\66025\CH011 71.MD.PRE.07.SHT