

F.A.P. RTE.	SECTION	COUNTY	TOTAL SHEETS	SHEET NO.
311	(1-D) R	KENDALL	514	153
STA. 846+00		TO STA. 858+00		
FED. ROAD DIST. NO.		ILLINOIS	FED. AID PROJECT	

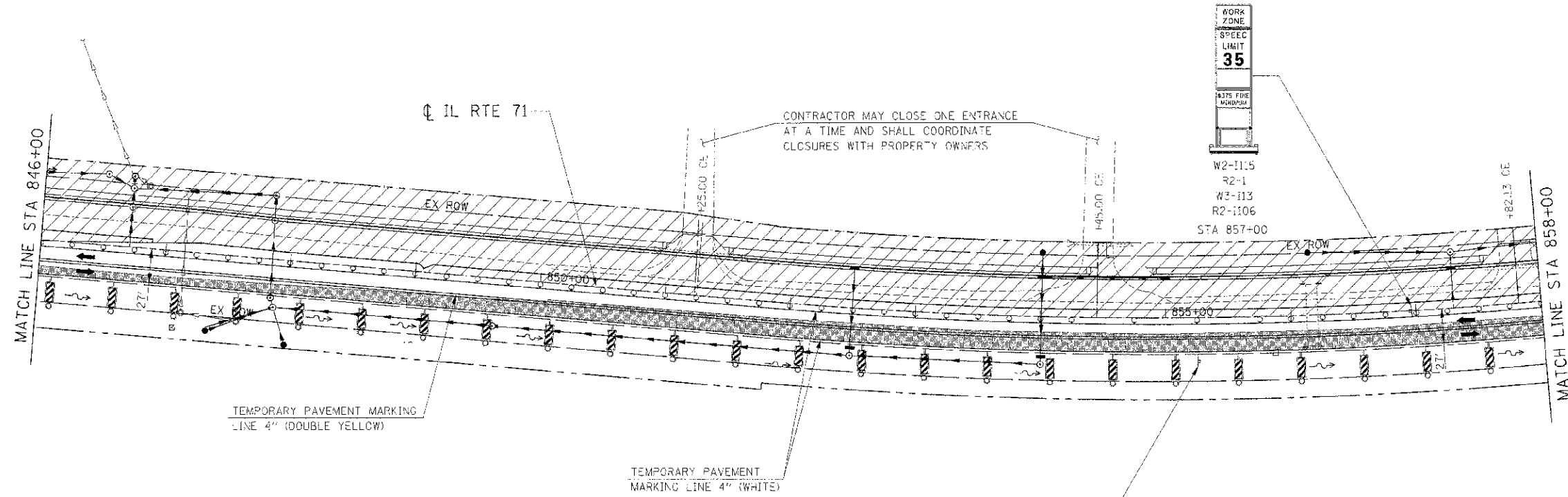

TEMPORARY PAVEMENT MARKING
LINE 4" (DOUBLE YELLOW)

TEMPORARY PAVEMENT MARKING
LINE 4" (WHITE)

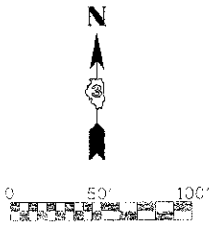

LEGEND

- DRUM
- VERTICAL PANEL
- TYPE III BARRICADE
- TRAFFIC FLOW
- STAGE CONSTRUCTION
- TEMPORARY WIDENING / PAVEMENT

NOTE:

CONTRACTOR SHALL MAINTAIN ACCESS TO ENTRANCES AND SIDE ROADS AT ALL TIMES EXCEPT AS NOTED TO BE CLOSED.

REVISIONS	
NAME	DATE

ILLINOIS DEPARTMENT OF TRANSPORTATION

**MAINTENANCE OF TRAFFIC
STAGE 1 (IL RTE 71)
STA 846+00 TO STA 858+00**

SCALE: 1"=50'
DATE 7/3/2012

DRAWN BY
CHECKED BY RG

IE PROJ. 66420
 DATE 7/3/12
 FILE NAME C:\66420\CAD\171\NOT.1.05.SHT