

F.A.R. RTE.	SECTION	COUNTY	TOTAL SHEETS	SHEET NO.
311	1-2 R	KENDALL	514	176
STA. 816+00		TO STA. 831+00		
FED. ROAD DIST. NO. ILLINOIS FED. AID PROJECT				

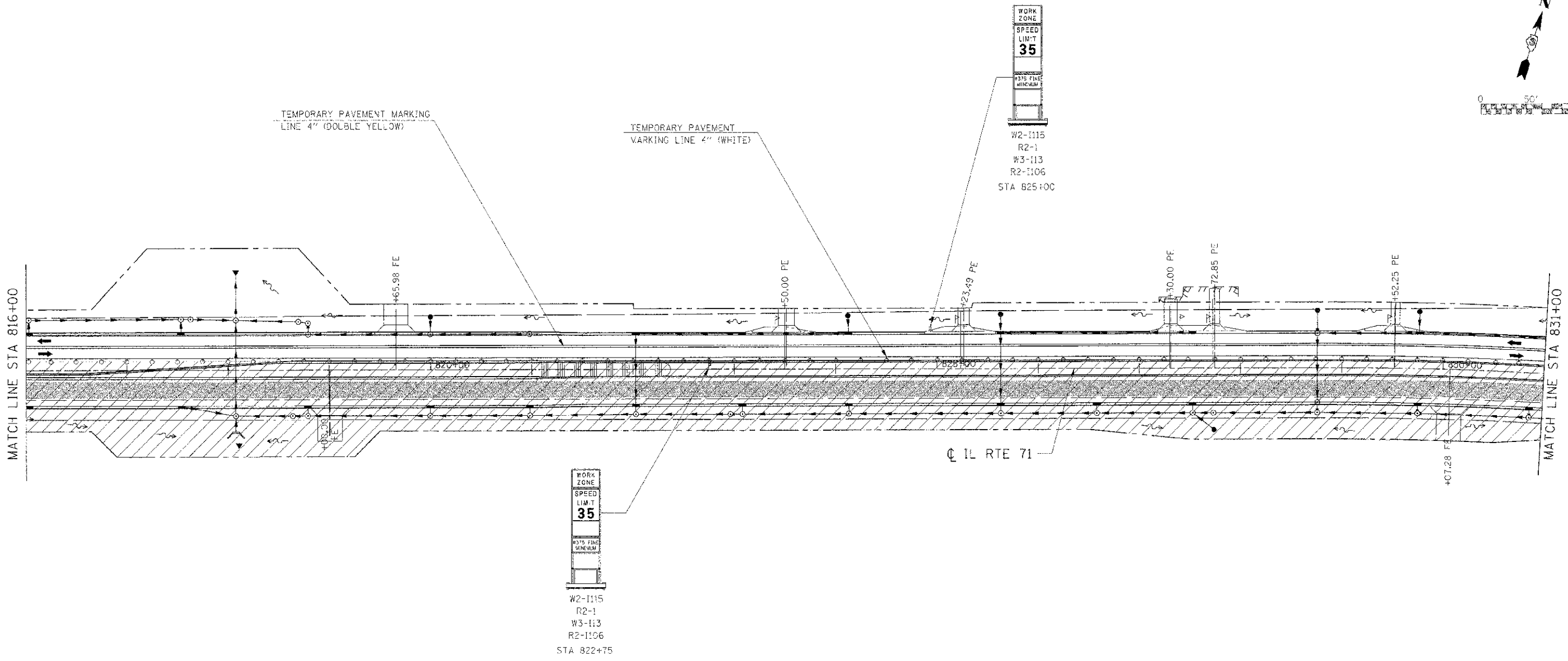
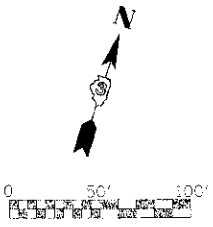

WORK ZONE
SPEED LIMIT
35
#315 FINE GRANULAR
W2-I115
R2-1
W3-I13
R2-I106
STA 822+75

WORK ZONE
SPEED LIMIT
35
#315 FINE GRANULAR
W2-I115
R2-1
W3-I13
R2-I106
STA 825+00

LEGEND

- DRJM
- VERTICAL PANEL
- TYPE III BARRICADE
- TRAFFIC FLOW
- STAGE CONSTRUCTION
- TEMPORARY WIDENING / PAVEMENT

NOTE:
CONTRACTOR SHALL MAINTAIN ACCESS TO ENTRANCES AND SIDE ROADS AT ALL TIMES EXCEPT AS NOTED TO BE CLOSED.

REVISIONS	
NAME	DATE

ILLINOIS DEPARTMENT OF TRANSPORTATION
**MAINTENANCE OF TRAFFIC
STAGE 2 (IL RTE 71)
STA 816+00 TO STA 831+00**
SCALE: 1"=50'
DATE: 7/3/2012
DRAWN BY: AAD
CHECKED BY: RG

DR: PHILLIP BROWN
 PLOT DATE: 7/3/2012
 FILE NAME: G:\358525\CAD\171\NOT P. 84.SJT