

F.A.P. R.L.	SECTION	COUNTY	TOTAL SHEET SHEETS, NO.
311	(1-1) R	KENDALL	54 181
STA. 858+00	TO STA. 873+00		
ILL. ROAD DIST. NO. ILLINOIS FED. AID PROJECT			

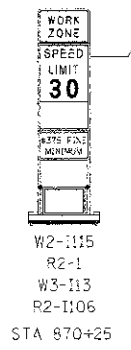
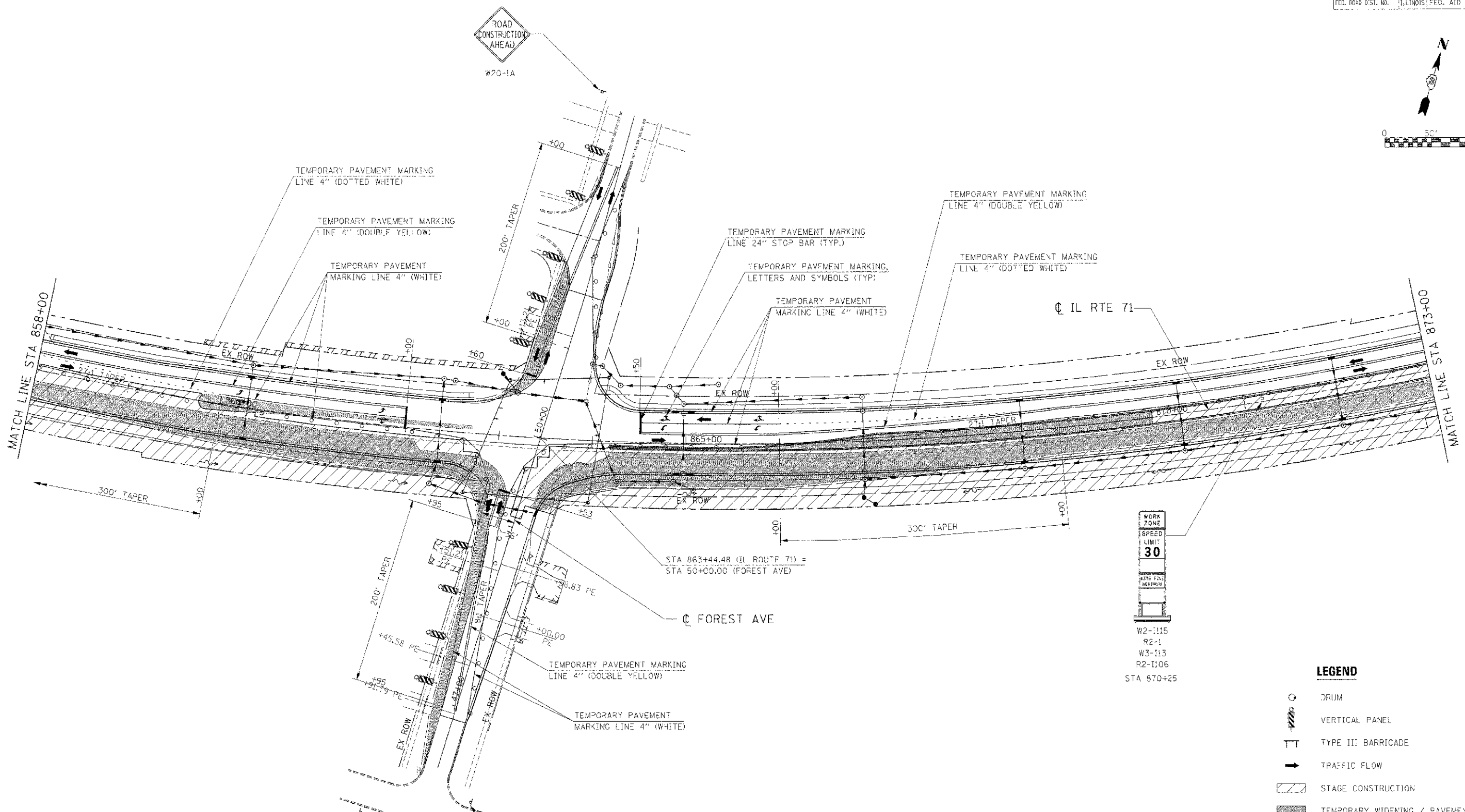
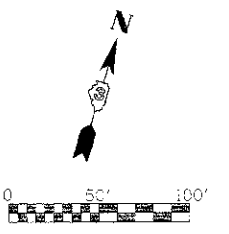

LEGEND

- DRUM
- VERTICAL PANEL
- TYPE II BARRICADE
- TRAFFIC FLOW
- STAGE CONSTRUCTION
- TEMPORARY WIDENING / PAVEMENT

REVISIONS	
NAME	DATE

ILLINOIS DEPARTMENT OF TRANSPORTATION
MAINTENANCE OF TRAFFIC
STAGE 2 (IL RTE 71)
STA 858+00 TO STA 873+00

SCALE: 1"=50'
 DATE: 7/3/2012

DRAWN BY: AAD
 CHECKED BY: RG

NOTE:
 CONTRACTOR SHALL MAINTAIN ACCESS TO ENTRANCES AND SIDE ROADS AT ALL TIMES EXCEPT AS NOTED TO BE CLOSED.

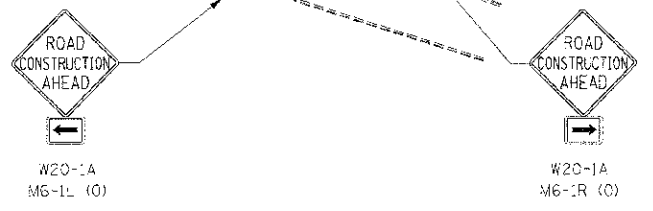

IE PROJ: 060625
 PLOT DATE: 7/3/2012
 FILE NAME: G:\310525\CH01\11\1011_2.RVT