

FLAP	SECTION	COUNTY	TOTAL SHEET NO.
311	(1-1) R	KENDALL	514 / 222
STA. 787+00		TO STA. 801+00	
FED. ROAD DIST. NO. ILLINOIS FED. AID PROJECT			

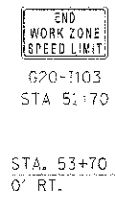
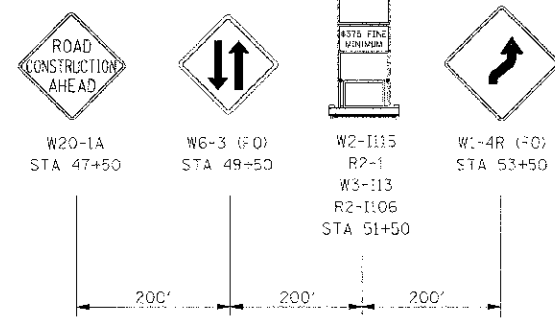
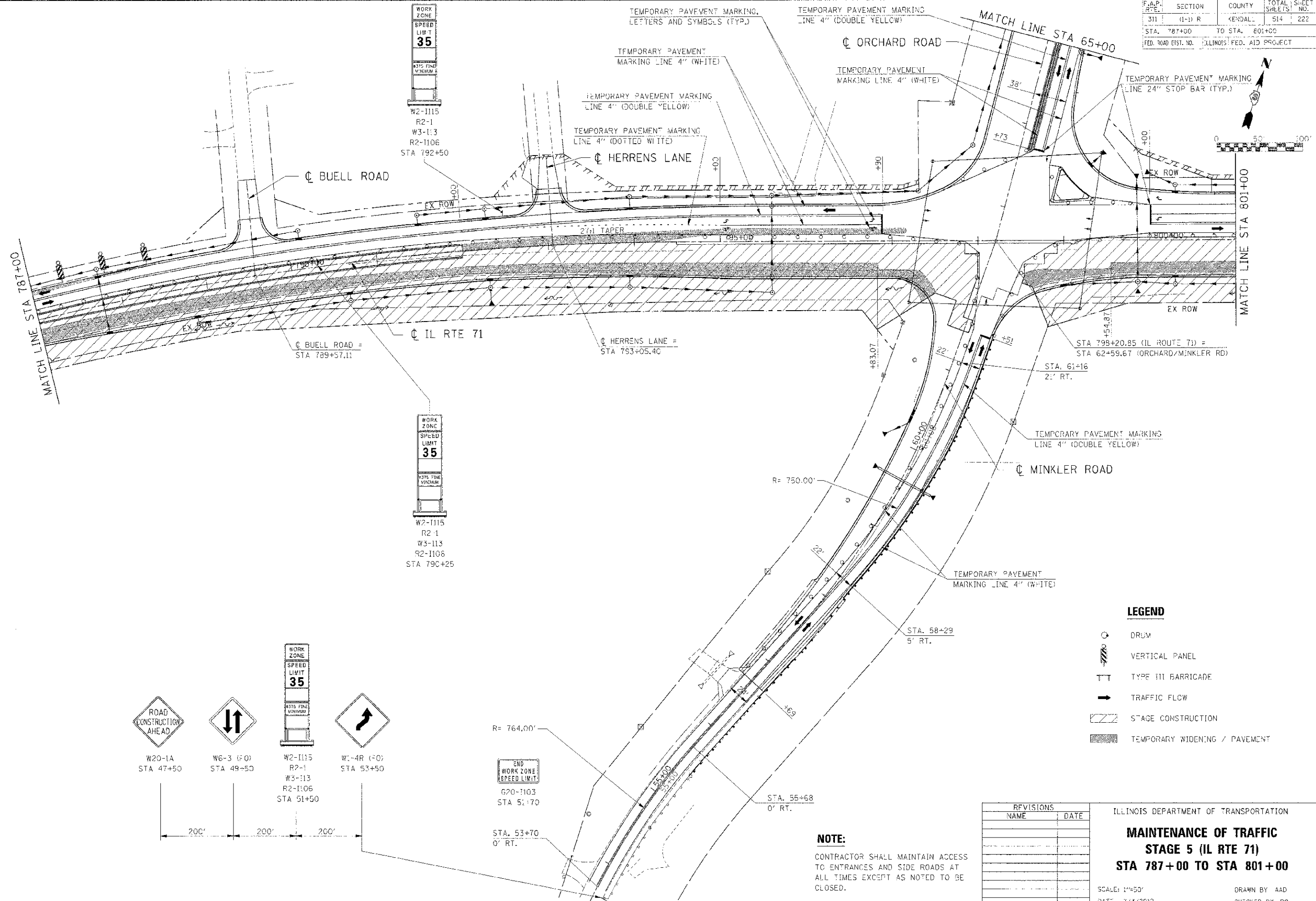

LEGEND

- DRUM
- VERTICAL PANEL
- TYPE III BARRICADE
- TRAFFIC FLOW
- STAGE CONSTRUCTION
- TEMPORARY WIDENING / PAVEMENT

REVISIONS	
NAME	DATE

ILLINOIS DEPARTMENT OF TRANSPORTATION

MAINTENANCE OF TRAFFIC

STAGE 5 (IL RTE 71)

STA 787+00 TO STA 801+00

SCALE: 1"=50'

DATE: 7/3/2012

DRAWN BY: AAD

CHECKED BY: RC

NOTE:

CONTRACTOR SHALL MAINTAIN ACCESS TO ENTRANCES AND SIDE ROADS AT ALL TIMES EXCEPT AS NOTED TO BE CLOSED.

IF PRINTED: 09/05/2012
 PLOT DATE: 7/3/2012
 FILE NAME: G:\ASB\6625\CD\171\10115_001.SHT