

F.A.P. DIST. NO.	SECTION	COUNTY	TOTAL SHEETS	SHEET NO.
311	(1)-1: R	KENDALL	514	231
STA. 787+00	TO STA. 801+00			
FED. ROAD DIST. NO.	FED. AID PROJ. NO.			

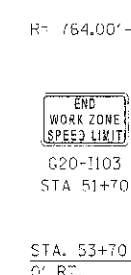
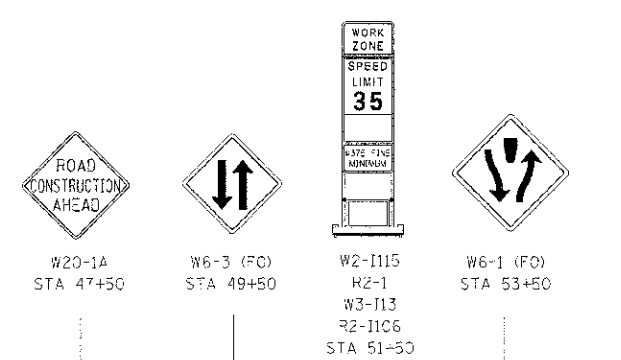
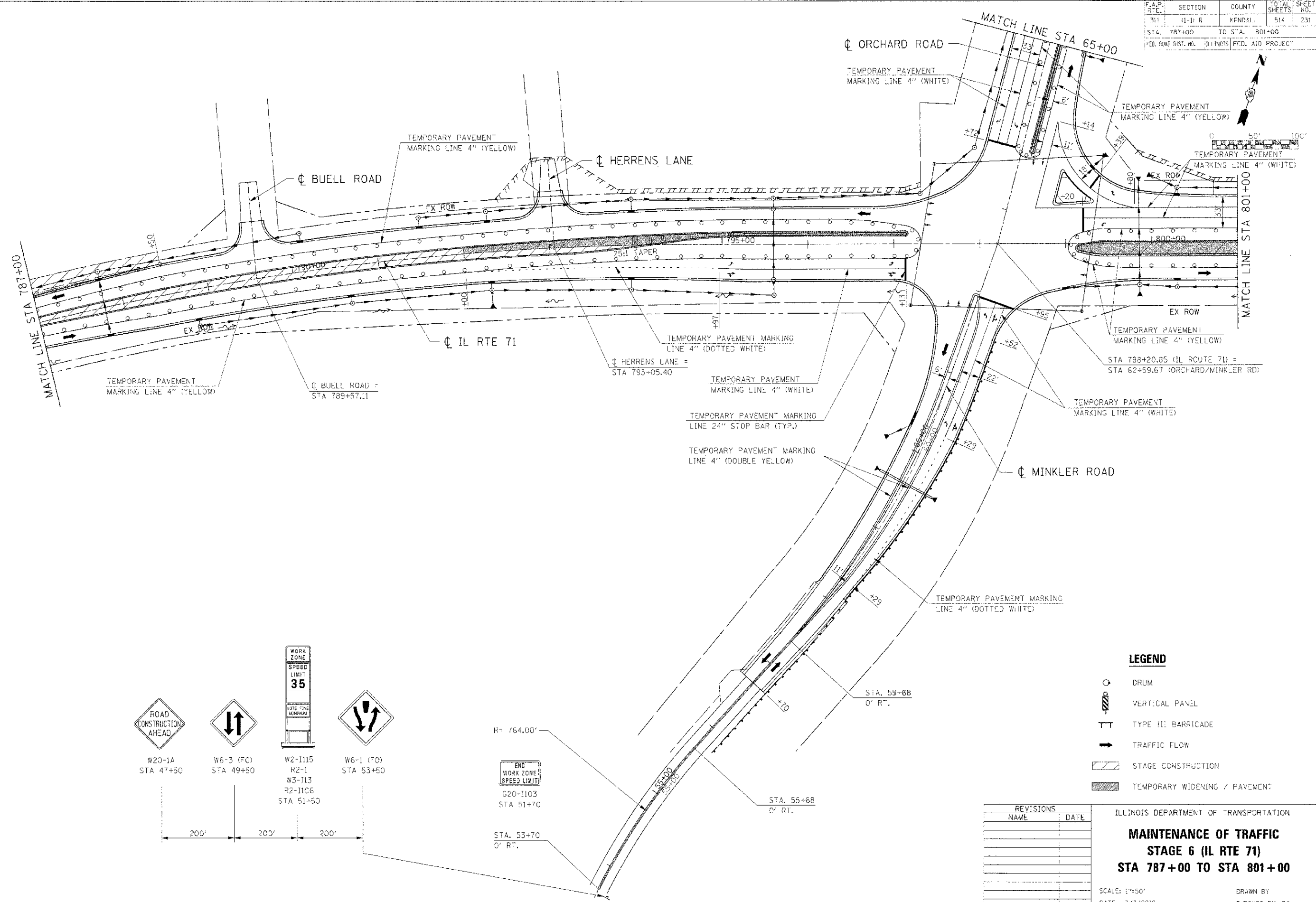

LEGEND

- DRUM
- VERTICAL PANEL
- TYPE III BARRICADE
- TRAFFIC FLOW
- STAGE CONSTRUCTION
- TEMPORARY WIDENING / PAVEMENT

REVISIONS	
NAME	DATE

ILLINOIS DEPARTMENT OF TRANSPORTATION
MAINTENANCE OF TRAFFIC
STAGE 6 (IL RTE 71)
STA 787+00 TO STA 801+00
 SCALE: 1"=50'
 DATE: 7/3/2012
 DRAWN BY: [blank]
 CHECKED BY: RG

IE_P011_2585025
 PLOT DATE: 7/3/2012
 FILE NAME: G:\505025\CORVIL71_P011_6_06.dwt