

F.A.P. RTE.	SECTION	COUNTY	TOTAL SHEETS	SHEET NO.
311	0-13R	KENDALL	514	236
STA. 780+44.91		TO STA. 918+85.88		
FED. ROAD DIST. NO.		ILLINOIS	FED. AID PROJECT	

**EROSION LEGEND**

	PERIMETER EROSION BARRIER		STONE RIP RAP
	TEMPORARY DITCH CHECK		EROSION CONTROL BLANKET w/ SEEDING CLASS 3
	INLET & PIPE PROTECTION		TURF REINFORCEMENT MAT
	SEDIMENT BASIN		SEEDING CLASS 2 OR CLASS 3
	PROPOSED SURFACE FLOW		SODDING, SALT TOLERANT

STAGING NOTE:  
PERIMETER EROSION BARRIER AND TEMP DITCH CHECKS MUST BE MAINTAINED THRU THE END OF TEMPORARY ROADWAY CONSTRUCTION (SEE STAGING PLANS) BETWEEN STA 777+00 LT TO STA 787+00 LT; REMOVED PRIOR TO FINAL SEEDING AND MULCH.

TEMP DITCH CHECK TO BE PLACED IN EACH STAGE OF CONSTRUCTION, TYP (SEE CROSS SECTIONS FOR DITCHING)

STAGING NOTE:  
PERIMETER EROSION BARRIER AND TEMP DITCH CHECKS MUST BE MAINTAINED THRU THE END OF TEMPORARY ROADWAY CONSTRUCTION (SEE STAGING PLANS) BETWEEN STA 777+00 RT TO STA 787+00 RT; REMOVED PRIOR TO FINAL SEEDING AND MULCH.

PRE-STAGE 1 TEMPORARY SEEDING:  
STA 774+34 RT TO STA 787+00 RT  
SEEDING, CLASS 7 - 0.562 ACRE  
MULCH, METHOD 1 - 0.562 ACRE

STAGE 1 TEMPORARY SEEDING:  
STA 773+30 LT TO STA 787+00 LT  
SEED, CLASS 7 - 0.689 ACRE  
MULCH, METHOD 1 - 0.689 ACRE

STAGE 2 TEMPORARY SEEDING:  
STA 774+34 RT TO STA 787+00 RT  
SEEDING, CLASS 7 - 0.562 ACRE  
MULCH, METHOD 2 - 0.689 ACRE

STAGE 1 PERMANENT SEEDING:  
STA 773+30 LT TO STA 787+00 LT  
SEEDING, CLASS 2 - 0.689 ACRE  
NITROGEN FERT NUTR - 41.3 LBS  
PHOSPHORUS FERT NUTR - 41.3 LBS  
POTASSIUM FERT NUTR - 41.3 LBS  
MULCH, METHOD 2 - 0.689 ACRE

STAGE 2 PERMANENT SEEDING:  
STA 774+34 RT TO STA 787+00 RT  
SEEDING, CLASS 2 - 0.562 ACRE  
NITROGEN FERT NUTR - 33.7 LBS  
PHOSPHORUS FERT NUTR - 33.7 LBS  
POTASSIUM FERT NUTR - 33.7 LBS  
MULCH, METHOD 2 - 0.562 ACRE

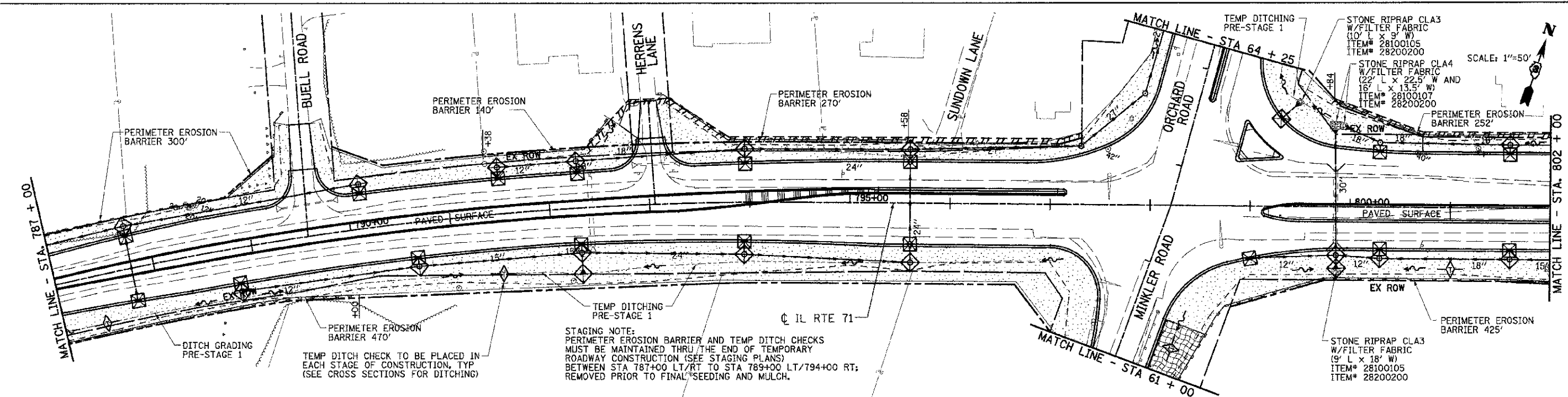
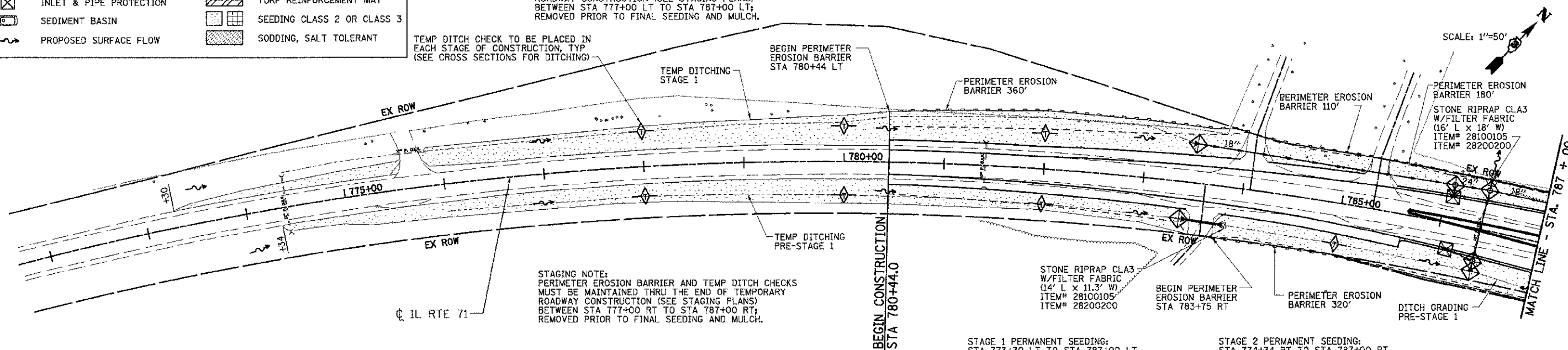

PRE-STAGE 1 TEMPORARY SEEDING:  
STA 787+00 RT TO STA 802+00 RT  
SEEDING, CLASS 7 - 1.149 ACRE  
MULCH, METHOD 1 - 1.149 ACRE

STAGE 1 TEMPORARY SEEDING:  
STA 787+00 LT TO STA 802+00 LT  
SEEDING, CLASS 7 - 0.849 ACRE  
MULCH, METHOD 1 - 0.849 ACRE

STAGE 2 TEMPORARY SEEDING:  
STA 787+00 RT TO STA 802+00 RT  
SEEDING, CLASS 7 - 1.149 ACRE  
MULCH, METHOD 1 - 1.149 ACRE

STAGE 1 PERMANENT SEEDING:  
STA 787+00 LT TO STA 802+00 LT  
SEEDING, CLASS 2 - 0.849 ACRE  
NITROGEN FERT NUTR - 50.9 LBS  
PHOSPHORUS FERT NUTR - 50.9 LBS  
POTASSIUM FERT NUTR - 50.9 LBS  
MULCH, METHOD 2 - 0.849 ACRE

STAGE 2 PERMANENT SEEDING:  
STA 787+00 RT TO STA 802+00 RT  
SEEDING, CLASS 2 - 1.106 ACRE  
SEEDING, CLASS 3 - 0.043 ACRE  
NITROGEN FERT NUTR - 68.9 LBS  
PHOSPHORUS FERT NUTR - 68.9 LBS  
POTASSIUM FERT NUTR - 68.9 LBS  
MULCH, METHOD 2 - 1.149 ACRE

**INTENDED EROSION AND LANDSCAPE SEQUENCE**

- 1) PLACE PERIMETER EROSION CONTROL BARRIER PRIOR TO COMMENCEMENT OF ANY WORK (SEE ARTICLE 280).
- 2) INSTALL TEMPORARY INLET PROTECTION AT ALL EXISTING AND PROPOSED STRUCTURES AND PIPE INLET AND OUTLETS WITHIN THE PROJECT LIMITS, AND IN ACCORDANCE WITH ARTICLE 280 OF THE IDOT STANDARD SPECIFICATION, (280001 INLET AND PIPE PROTECTION EACH).
- 3) CONSTRUCT EARTHWORK, DITCHES FIRST (MAXIMUM 10 ACRES DISTURBED AT ONE TIME PRIOR TO SEEDING - SEE ARTICLE 202 & 280).
- 4) INSTALL ALL DITCH EROSION ITEMS TO THE NEW DITCH CENTERLINES FROM OFFSETS IN SECTIONS (SEE CROSS SECTIONS)
- 5) PLACE AND MAINTAIN TEMPORARY AND PERMANENT EROSION CONTROL ITEMS FOLLOWING THE STAGED CONSTRUCTION PROCEDURE SHOWN IN THESE PLANS. SEED EVERY 7 DAYS (SEE ARTICLE 280 FOR TEMPORARY EROSION ITEMS AND ARTICLE 250 & 251 FOR PERMANENT SEEDING).
- 6) FINAL SHAPE, GRADE AND PAVE ROADWAY BY STAGING SHOWN IN PLANS.
- 7) PLACE REMAINING PERMANENT EROSION CONTROLS AND LANDSCAPE ITEMS PRIOR TO THE COMPLETION OF EACH STAGE.

REVISIONS	
NAME	DATE

ILLINOIS DEPARTMENT OF TRANSPORTATION

**EROSION CONTROL PLAN  
LANDSCAPING**  
STA 773+30 TO STA 802+00

SCALE: VERT. 1"=10'  
HORIZ. 1"=50'  
DATE 07/06/2012  
DRAWN BY KDD  
CHECKED BY MO/MED

PLOT DATE = 7/29/2012  
 PLOT SCALE = 1"=50'  
 PLOT USER = kdd  
 USER NAME = kdd

