

F.A.P. RTE.	SECTION	COUNTY	TOTAL SHEETS	SHEET NO.
311	G-DR	KENDALL	514	239
STA. 780+44.91		TO STA. 918+85.88		
FED. ROAD DIST. NO.		ILLINOIS	FED. AID PROJECT	

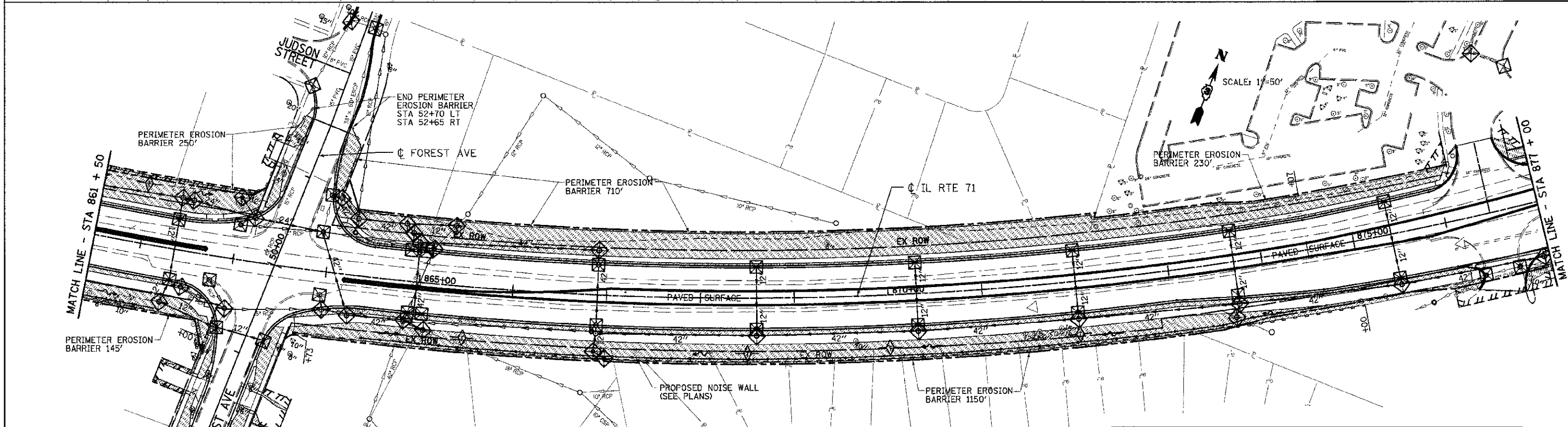
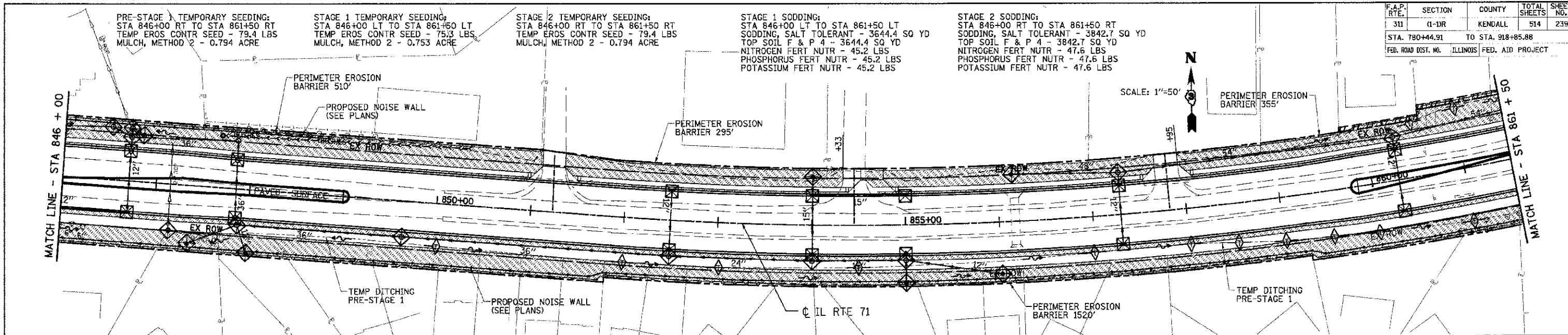

EROSION LEGEND

	PERIMETER EROSION BARRIER		STONE RIP RAP
	TEMPORARY DITCH CHECK		EROSION CONTROL BLANKET w/ SEEDING CLASS 3
	INLET & PIPE PROTECTION		TURF REINFORCEMENT MAT
	SEDIMENT BASIN		SEEDING CLASS 2 OR CLASS 3
	PROPOSED SURFACE FLOW		SODDING, SALT TOLERANT

INTENDED EROSION AND LANDSCAPE SEQUENCE

- 1) PLACE PERIMETER EROSION CONTROL BARRIER PRIOR TO COMMENCEMENT OF ANY WORK (SEE ARTICLE 280).
- 2) INSTALL TEMPORARY INLET PROTECTION AT ALL EXISTING AND PROPOSED STRUCTURES AND PIPE INLET AND OUTLETS WITHIN THE PROJECT LIMITS, AND IN ACCORDANCE WITH ARTICLE 280 OF THE 100T STANDARD SPECIFICATION, (280001 INLET AND PIPE PROTECTION EACH).
- 3) CONSTRUCT EARTHWORK, DITCHES FIRST (MAXIMUM 10 ACRES DISTURBED AT ONE TIME PRIOR TO SEEDING - SEE ARTICLE 202 & 280).
- 4) INSTALL ALL DITCH EROSION ITEMS TO THE NEW DITCH CENTERLINES FROM OFFSETS IN SECTIONS (SEE CROSS SECTIONS)
- 5) PLACE AND MAINTAIN TEMPORARY AND PERMANENT EROSION CONTROL ITEMS FOLLOWING THE STAGED CONSTRUCTION PROCEDURE SHOWN IN THESE PLANS. SEED EVERY 7 DAYS (SEE ARTICLE 280 FOR TEMPORARY EROSION ITEMS AND ARTICLE 250 & 251 FOR PERMANENT SEEDING).
- 6) FINAL SHAPE, GRADE AND PAVE ROADWAY BY STAGING SHOWN IN PLANS.
- 7) PLACE REMAINING PERMANENT EROSION CONTROLS AND LANDSCAPE ITEMS PRIOR TO THE COMPLETION OF EACH STAGE.

REVISIONS	
NAME	DATE

ILLINOIS DEPARTMENT OF TRANSPORTATION

**EROSION CONTROL PLAN
LANDSCAPING**

STA 846+00 TO STA 877+00

SCALE: VERT. 1"=50'
HORIZ. 1:50
DATE 07/06/2012

DRAWN BY KDD
CHECKED BY MG/MED

PLOT DATE = 7/19/2012
FILE NAME = F:\66420\11-DR\66420-239.dwg
USER NAME = kdd

BLOOM COMPANIES, LLC
Infrastructure Development and Design
800 W. Fulton Street, Suite 701 • Chicago, IL 60601
Phone: (312) 676-9200 Fax: (312) 676-9200