

F.A.P. RTE.	SECTION	COUNTY	TOTAL SHEETS	SHEET NO.
311	(1-1R)	KENDALL	514	255
STA. 846+00		TO STA. 858+00		
FED. ROAD DIST. NO.		ILLINOIS		FED. AID PROJECT

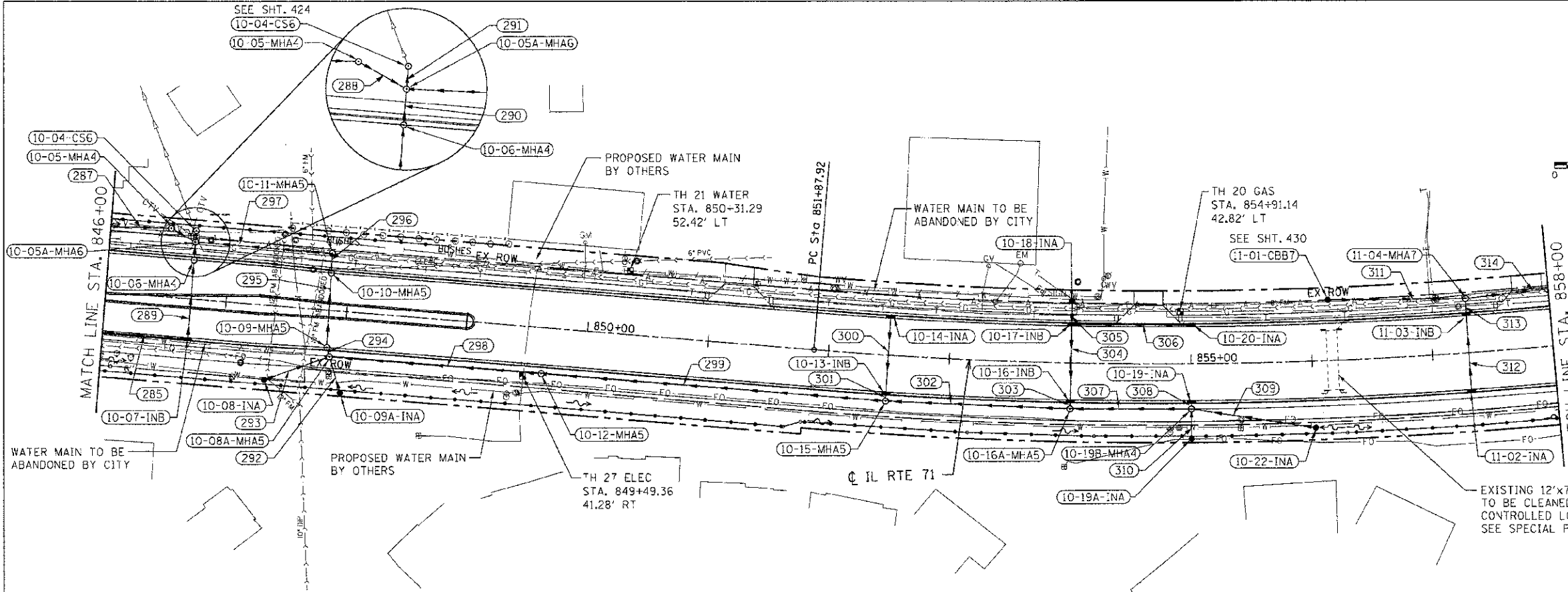
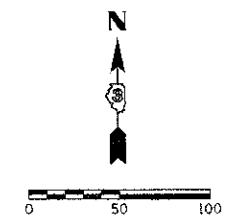

DRAINAGE STRUCTURE SCHEDULE

STRUCTURE NUMBER	STATION	OFFSET	ROUTE	STRUCTURE TYPE	CASTING	RIM ELEVATION	NORTH INVERT	SOUTH INVERT	EAST INVERT	WEST INVERT	COMMENTS
10-04-CS6	846+70.76	56.25' LT.		CONTROL STRUCTURE, 6' DIAMETER	TYPE 1 FRAME, CLOSED LID	662.00	662.48	663.93			
10-05-MH A	846+50.00	56.50' LT.		MANHOLE, TYPE A, 4' DIAMETER	TYPE 8 GRATE	661.86			669.49	669.59	
10-05A-MH A	846+70.76	46.82' LT		MANHOLE, TYPE A, 6' DIAMETER	TYPE 1 FRAME, CLOSED LID	664.50	654.00	659.55	654.00	659.39	
10-06-MH A	846+70.76	32.00' LT.		MANHOLE, TYPE A, 4' DIAMETER	TYPE 24 FRAME AND GRATE	665.10	659.61	659.71			
10-07-IN B	846+70.76	32.00' RT.		INLET, TYPE B	TYPE 24 FRAME AND GRATE	665.10	660.02			660.12	
10-08-IN A	847+36.45	61.36' RT		INLET, TYPE A	TYPE 8 GRATE	663.90			662.15		
10-08A-MH A	847+88.77	38.14' RT		MANHOLE, TYPE A, 5' DIAMETER	TYPE 1 FRAME, CLOSED LID	666.01	664.49	659.61	654.49	661.90	
10-09-MH A	847+85.12	30.69' RT.		MANHOLE, TYPE A, 5' DIAMETER	TYPE 24 FRAME AND GRATE	665.61	654.49	654.48			
10-09A-IN A	848+00.00	67.16' RT.		INLET, TYPE A	TYPE 8 GRATE	664.30	659.81				
10-10-MH A	847+84.75	30.72' LT.		MANHOLE, TYPE A, 5' DIAMETER	TYPE 24 FRAME AND GRATE	665.61	654.42	664.42			
10-11-MH A	847+84.30	46.62' LT.		MANHOLE, TYPE A, 5' DIAMETER	TYPE 1 FRAME, CLOSED LID	664.10		664.40		654.40	
10-12-MH A	849+64.53	38.00' RT		MANHOLE, TYPE A, 5' DIAMETER	TYPE 1 FRAME, CLOSED LID	666.45			654.71	654.71	
10-13-IN B	852+49.51	30.50' RT.		INLET, TYPE B	TYPE 24 FRAME AND GRATE	663.48	659.18	669.08			
10-14-IN A	852+49.51	30.50' LT.		INLET, TYPE A	TYPE 24 FRAME AND GRATE	663.48		659.48			
10-15-MH A	852+49.59	38.00' RT		MANHOLE, TYPE A, 5' DIAMETER	TYPE 1 FRAME, CLOSED LID	663.89	669.06		655.17	655.07	
10-16-IN B	854+00.84	30.50' RT.		INLET, TYPE B	TYPE 24 FRAME AND GRATE	661.26	655.61	665.61			
10-16A-MH A	854+00.63	38.00' RT.		MANHOLE, TYPE A, 5' DIAMETER	TYPE 1 FRAME, CLOSED LID	661.66	655.50		655.52	655.42	
10-17-IN B	854+00.66	30.50' LT.		INLET, TYPE B	TYPE 24 FRAME AND GRATE	661.26	656.86	655.80	655.80		
10-18-IN A	854+00.59	46.36' LT.		INLET, TYPE A	TYPE 8 GRATE	660.98		656.94			
10-19A-IN A	856+00.01	61.89' RT.		INLET, TYPE A	TYPE 8 GRATE	660.10	656.45				
10-19-IN A	856+00.01	30.50' RT.		INLET, TYPE A	TYPE 24 FRAME AND GRATE	659.81		666.31			
10-19B-MH A	856+00.00	37.50' RT		MANHOLE, TYPE A, 4' DIAMETER	TYPE 1 FRAME, CLOSED LID	660.21	656.21	656.25	656.15	655.85	
10-20-IN A	855+00.01	30.50' LT.		INLET, TYPE A	TYPE 24 FRAME AND GRATE	669.81				666.62	
10-22-IN A	866+01.29	55.00' RT.		INLET, TYPE A	TYPE 8 GRATE	658.20				656.55	
11-01-CB B SPC	856+15.02	49.90' LT.		CATCH BASIN, TYPE B, 7' DIAMETER (SPECIAL)	TYPE 7 GRATE	656.40			642.21		
11-02-IN A	857+30.06	30.50' RT.		INLET, TYPE A	TYPE 24 FRAME AND GRATE	656.26	652.32				
11-03-IN B	857+30.06	30.50' LT.		INLET, TYPE B	TYPE 24 FRAME AND GRATE	656.26	652.00	652.10			
11-04-MH A	857+30.38	44.57' LT.		MANHOLE, TYPE A, 7' DIAMETER	TYPE 1 FRAME, CLOSED LID	656.87		651.92	641.42	641.80	

STORM SEWER SCHEDULE

SEGMENT	SIZE	LENGTH	GRADE
285	12" SS X	122.2'	@ 0.75%
287	12" SS X	100.3'	@ 0.44%
288	12" SS X	17.9'	@ 0.56%
289	12" SS X	64.0'	@ 0.48%
290	15" SS X	7.8'	@ 0.77%
291	36" SS X	3.4'	@ 2.06%
292	12" SS X	27.6'	@ 0.72%
293	12" SS X	53.7'	@ 0.47%
294	36" SS X	3.0'	@ 0.33%
295	38" SS X	61.4'	@ 0.10%
296	36" SS X	9.6'	@ 0.21%
297	36" SS X	108.1'	@ 0.37%
298	36" SS X	170.8'	@ 0.13%
299	30" SS X	280.7'	@ 0.13%
300	12" SS X	61.0'	@ 0.49%
301	15" SS X	3.0'	@ 0.67%
302	24" SS X	147.6'	@ 0.17%
303	15" SS X	3.0'	@ 0.33%
304	15" SS X	61.0'	@ 0.31%
305	12" SS X	17.5'	@ 0.46%
306	12" SS X	96.2'	@ 0.85%
307	15" SS X	95.9'	@ 0.34%
308	12" SS X	3.0'	@ 3.33%
309	12" SS X	101.0'	@ 0.40%
310	12" SS X	20.9'	@ 0.96%
311	48" SS X	107.5'	@ 0.36%
312	12" SS X	61.0'	@ 0.36%
313	12" SS X	6.6'	@ 1.21%
314	54" SS X	287.8'	@ 0.35%

REVISIONS	
NAME	DATE

ILLINOIS DEPARTMENT OF TRANSPORTATION

DRAINAGE PLAN
STA. 846+00 TO STA. 858+00

SCALE: VERT. 1"=50'
 HORIZ. 1"=50'
 DATE 7/3/2012

DRAWN BY RLH
 CHECKED BY MED

THE PROJ. # 030504
 PLOT DATE 7/3/2012
 FILE NAME prAct11_rdbL.dwg