

F.A.P. RTE.	SECTION	COUNTY	TOTAL SHEETS	SHEET NO.
311	(1-1)R	KENDALL	514	308
STA. 833+00		TO STA. 839+25		
FED. ROAD DIST. NO.		ILLINOIS FED. AID PROJECT		

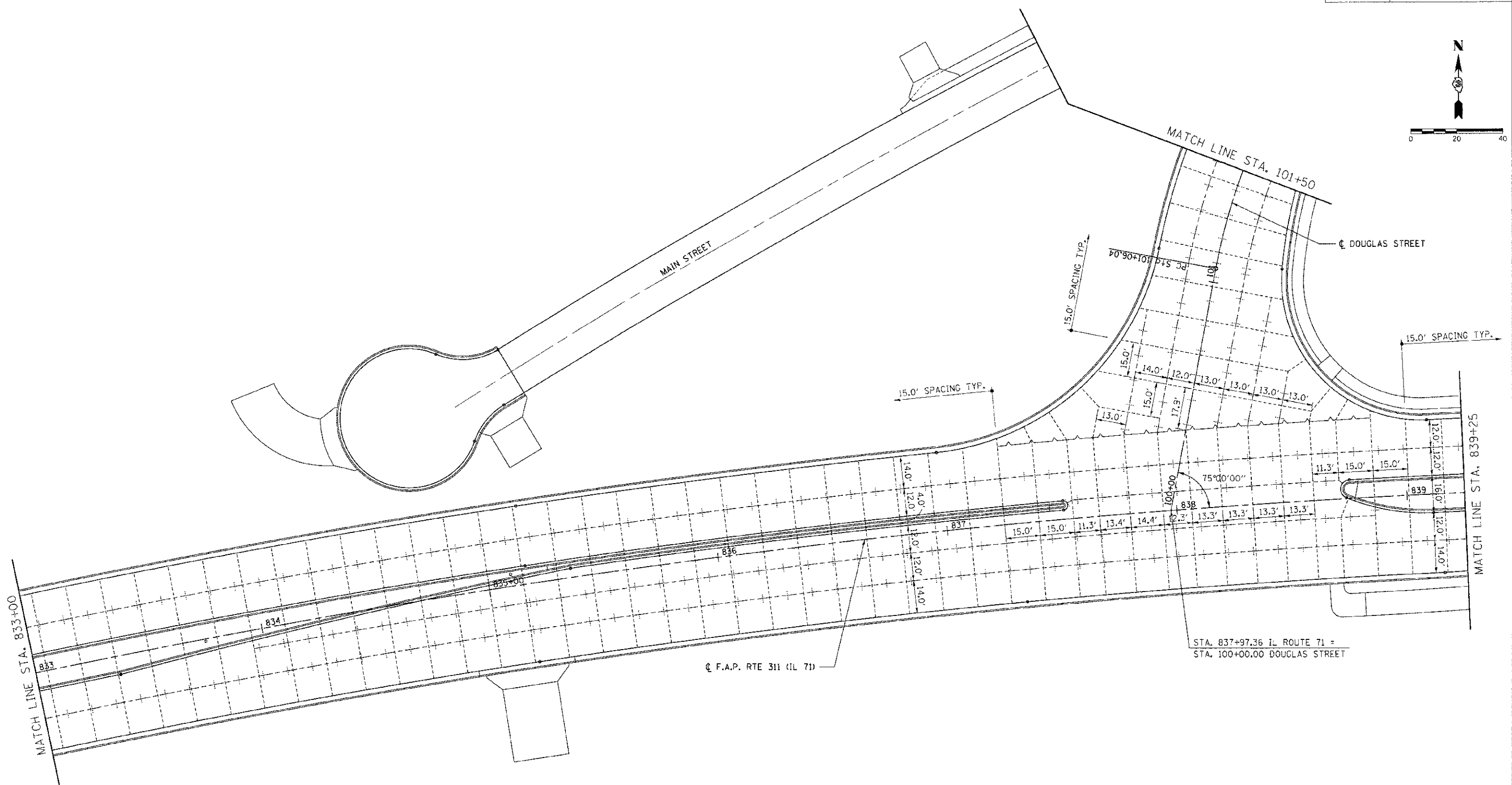
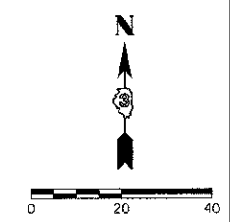

LEGEND

- KEYED CONSTRUCTION JOINT
- SAWED LONGITUDINAL JOINT OR LONGITUDINAL CONSTRUCTION JOINT
- TRANSVERSE SAWED CONTRACTION JOINT

REVISIONS	
NAME	DATE

ILLINOIS DEPARTMENT OF TRANSPORTATION
PAVEMENT JOINT LAYOUT
IL RTE 71
STA 833+00 TO STA 839+25

SCALE: VERT. 1"=20'
 HORIZ. 1"=20'
 DATE 7/5/2012

DRAWN BY SAE
 CHECKED BY MED

TUG PROJ. #0182914
 PLOT DATE = 7/5/2012
 FILE NAME = p:\01\01\1\ids\dss3\0182914\pave\joints.dwg