

F.A.P. RTE.	SECTION	COUNTY	TOTAL SHEETS	SHEET NO.
311	(1-1)R	KENDALL	514	328
STA. 64+50		TO STA. 68+00		
FED. ROAD DIST. NO.		ILLINOIS FED. AID PROJECT		

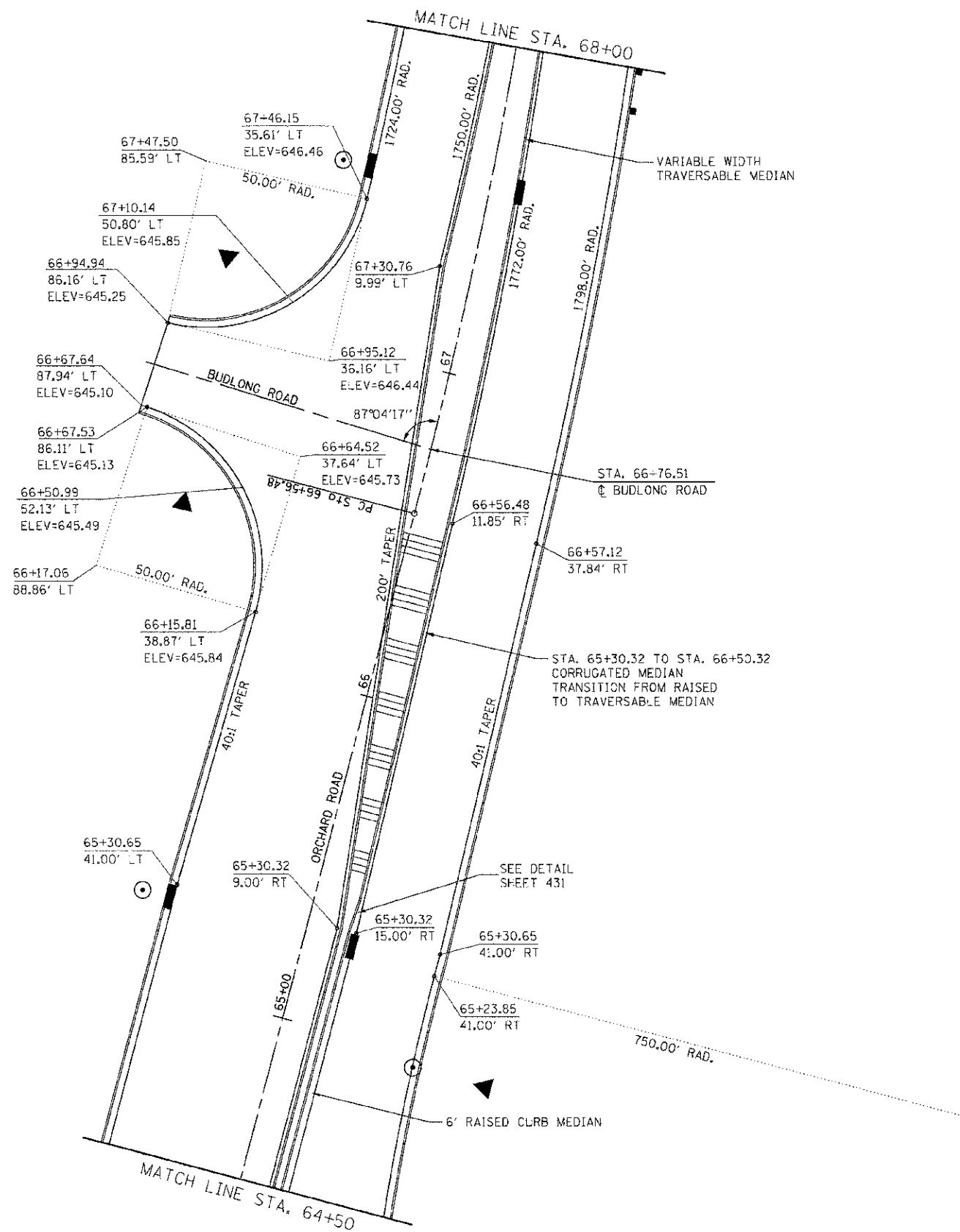
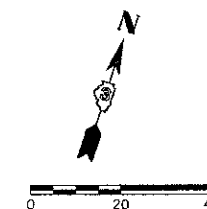

NOTES:

- FOR ADDITIONAL DETAILS, SEE JOINTING PLANS, SIGNING AND STRIPING PLANS, AND TRAFFIC SIGNAL PLANS.

REVISIONS	
NAME	DATE

ILLINOIS DEPARTMENT OF TRANSPORTATION
INTERSECTION DETAIL
ORCHARD ROAD
STA. 64 + 50 TO STA. 68 + 00

SCALE: VERT. 1"=20'
 HORIZ. 1"=20'
 DATE 7/5/2012
 DRAWN BY SAE
 CHECKED BY MED

TUG PROJ: 1305814
 PLOT DATE: 7/5/2012
 FILE NAME: p:\proj\1305814\1305814.dwg