

F.A.P. NO.	SECTION	COUNTY	TOTAL SHEET NO.
311	(1-1)R	KENDALL	514 / 342
STA. 201+50		TO STA. 207+00	
FED. ROAD DIST. NO.		ILLINOIS FED. AID PROJECT	

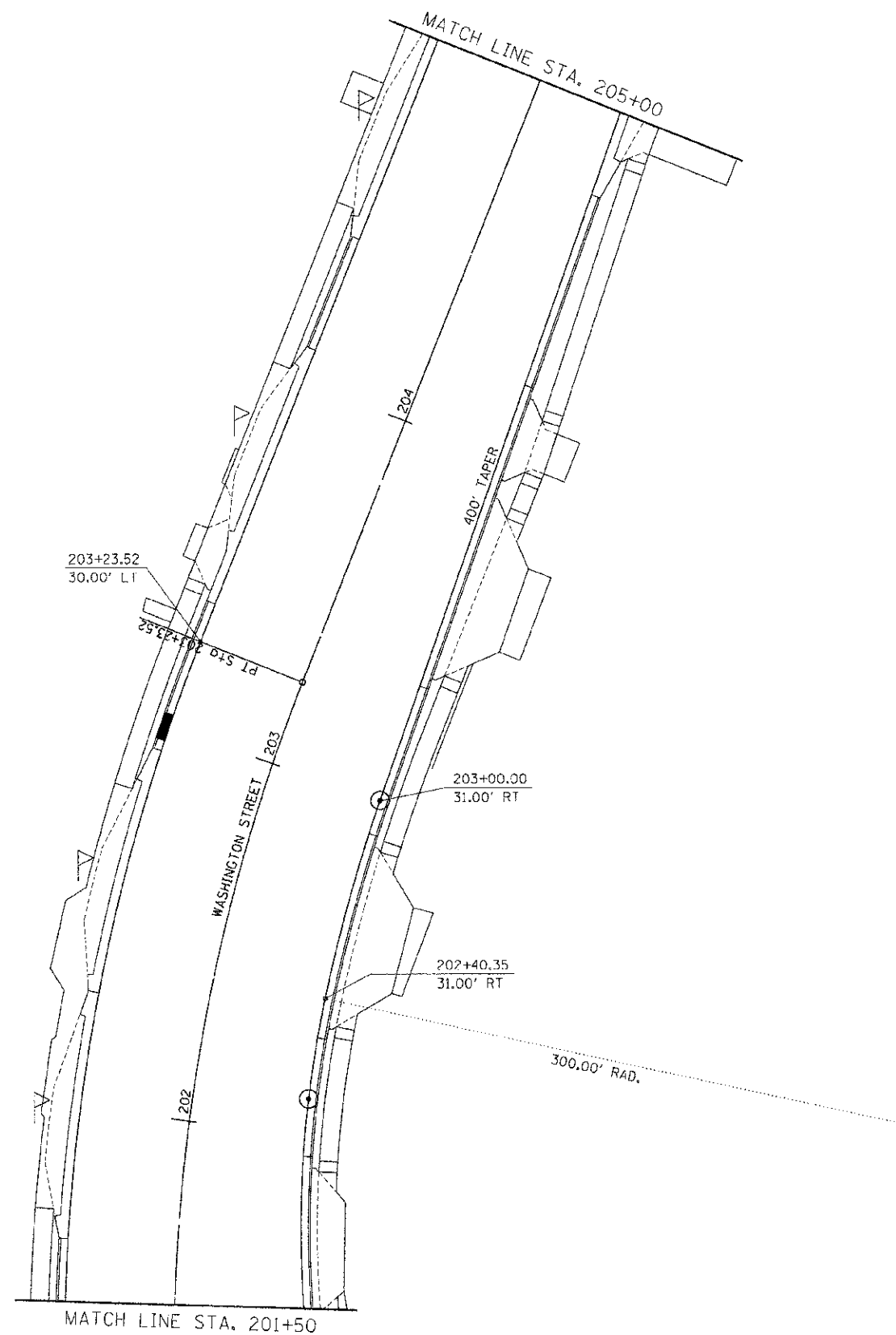
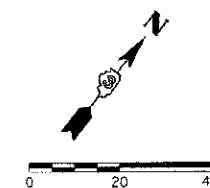

NOTES:

1. FOR ADDITIONAL DETAILS, SEE JOINTING PLANS, SIGNING AND STRIPING PLANS, AND TRAFFIC SIGNAL PLANS.
2. ADJUST PAVEMENT GRADES THROUGH CROSS WALKS TO A MAXIMUM OF 2% CROSS SLOPE.

REVISIONS	
NAME	DATE

ILLINOIS DEPARTMENT OF TRANSPORTATION

**INTERSECTION DETAIL
WASHINGTON ST
STA. 201 + 50 TO STA. 207 + 00**

SCALE: VERT. 1"=20'
HORIZ. 1"=20'
DATE 7/5/2012

DRAWN BY SAE
CHECKED BY MED

TUC PROJ: 2006014
PLOT DATE: 7/5/2012
FILE NAME: p:\tuc\1\doc\dat\2\wage\phase 1\int-washington-06.dgn