

F.A.P. R.E.	SECTION	COUNTY	TOTAL SHEETS	SHEET NO.
311	(1-1)R	KENDALL	514	369
STA. TO STA.				
FED. ROAD DIST. NO.		ILLINOIS FED. AID PROJECT		

**TRAFFIC SIGNAL LEGEND**

EXISTING	PROPOSED	DESCRIPTION
		TRAFFIC SIGNAL CONTROLLER TYPE SHALL BE <i>ECONOLITE</i>
		LIGHTING CONTROLLER
		SERVICE INSTALLATION, GROUND MOUNTED
		SIGNAL HEAD WITH BACKPLATE
		SIGNAL HEAD, PEDESTRIAN
		SIGNAL POST
		MAST ARM ASSEMBLY AND POLE, STEEL
		MAST ARM ASSEMBLY AND POLE, STEEL WITH LUMINAIRE
		COMMON TRENCH
		HANDHOLE
		HEAVY DUTY HANDHOLE
		DOUBLE HANDHOLE
		P.V.C. CONDUIT IN TRENCH (T) OR PUSHED (P)
		PEDESTRIAN PUSHBUTTON DETECTOR TYPE 4EVR
		DETECTOR LOOP
		EMERGENCY VEHICLE LIGHT DETECTOR
		CONFIRMATION BEACON

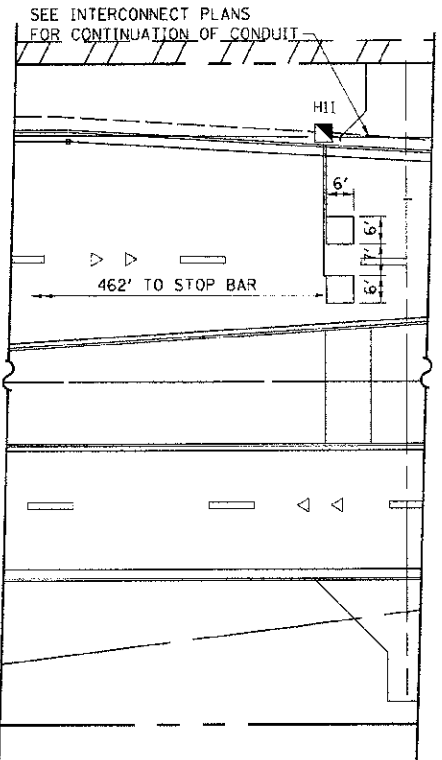
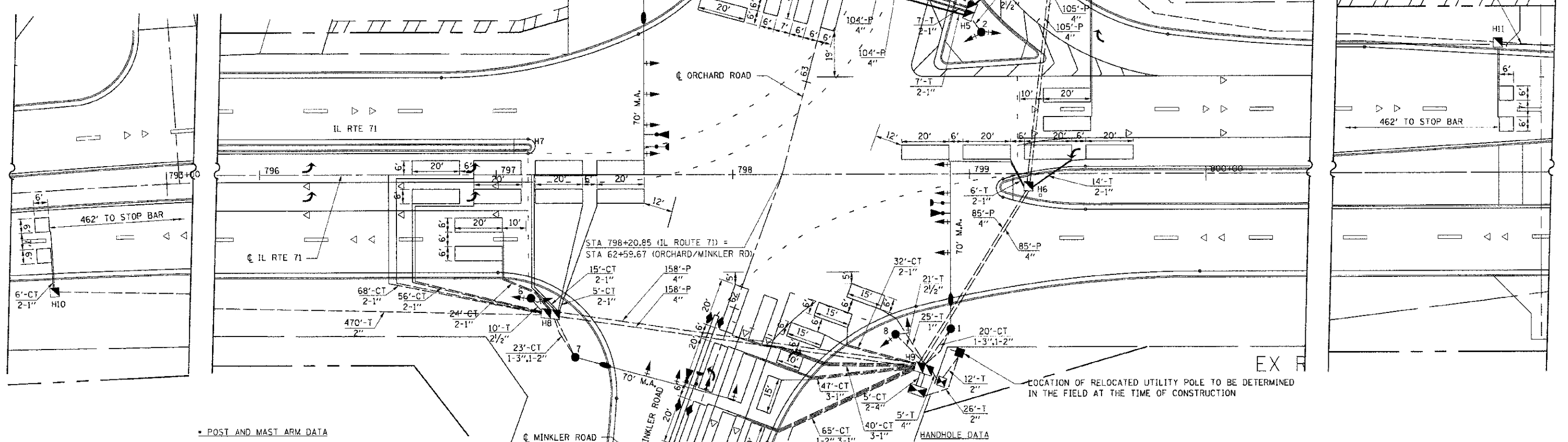
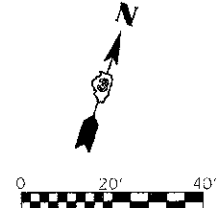

POST AND MAST ARM DATA

NUMBER	LOCATION	DESCRIPTION
1	798+92 65.0'	RT STEEL COMBINATION MAST ARM ASSEMBLY AND POLE 70 FT.
2	799+05 59.6'	LT TRAFFIC SIGNAL POST, GALVANIZED STEEL 16 FT.
3	799+31 107.1'	LT STEEL COMBINATION MAST ARM ASSEMBLY AND POLE 70 FT.
4	798+02 120.9'	LT TRAFFIC SIGNAL POST, GALVANIZED STEEL 16 FT.
5	797+62 77.0'	LT STEEL COMBINATION MAST ARM ASSEMBLY AND POLE 70 FT.
6	797+45 51.9'	RT TRAFFIC SIGNAL POST, GALVANIZED STEEL 16 FT.
7	797+33 76.7'	RT STEEL COMBINATION MAST ARM ASSEMBLY AND POLE 70 FT.
8	798+69 67.3'	RT TRAFFIC SIGNAL POST, GALVANIZED STEEL 16 FT.

HANDHOLE DATA

NUMBER	LOCATION	DESCRIPTION
H1		NOT USED
H2	797+99 105.8'	LT STANDARD HANDHOLE
H3		NOT USED
H4	799+37 100.9'	LT STANDARD HANDHOLE
H5	799+00 68.6'	LT DOUBLE HANDHOLE
H6	799+25 5.4'	RT STANDARD HANDHOLE
H7		NOT USED
H8	797+22 57.1'	RT DOUBLE HANDHOLE
H9	798+81 81.8'	RT DOUBLE HANDHOLE
H10	792+50 42.6'	RT STANDARD HANDHOLE
H11	803+82 54.7'	LT STANDARD HANDHOLE
H12	57+28 22.2'	RT STANDARD HANDHOLE
H13	68+38 41.3'	LT STANDARD HANDHOLE

\*LOCATIONS OF TRAFFIC SIGNAL POSTS AND MAST ARM ASSEMBLIES MAY BE CHANGED IN THE FIELD AS NECESSARY TO AVOID UTILITIES. THE NEW LOCATIONS SHALL BE COORDINATED WITH THE ENGINEER AND APPROVED BY THE DISTRICT TRAFFIC SIGNAL SECTION TO ENSURE THE NEW LOCATIONS MEET OPERATIONAL OFFSET/CLEAR ZONE REQUIREMENTS AND MAINTAIN PROPER POSITION OF SIGNAL HEADS IN RELATION TO THE TRAVELED LANES.

REVISIONS

NAME	DATE

ILLINOIS DEPARTMENT OF TRANSPORTATION

**TRAFFIC SIGNAL PLAN**  
**IL RTE 71**  
**ORCHARD RD./ MINKLER RD.**

SCALE: 1"=20'  
 DATE: 7/9/2012

DRAWN BY: NMR  
 CHECKED BY: DJL

PLOT DATE = 7/9/2012  
 PLOT NAME = p:\work\11\proj\11\11016\_01\ORCHARD\_MINKLER\_11.dwg  
 PLOT SCALE = 28.0000 / IN