

LIGHT POLE IDENTIFICATION:
 39-1 LOCATION NUMBER
 POLE NUMBER
 STA. 293+23 STATION
 50' 0/S OFFSET FROM EDGE OF PAVEMENT

LEGEND:

- EXISTING LIGHTING CONTROLLER TO BE REMOVED.
- EXISTING LIGHTING UNIT TO BE REMOVED, NO SALVAGE.
- LIGHT POLE, ALUMINUM, 45 FT. M.H. WITH 15 FT. DAVIT ARM WITH 250 WATT HORIZONTAL MOUNT LUMINAIRE, BREAKAWAY COUPLINGS
- LIGHT POLE, ALUMINUM, 50 FT. M.H. WITH 15 FT. DAVIT ARM WITH 400 WATT HORIZONTAL MOUNT LUMINAIRE, BREAKAWAY COUPLINGS
- UNIT DUCT, SIZE AS INDICATED
- UNDERGROUND CONDUIT, COILABLE NONMETALLIC CONDUIT, 2 1/2" DIA. (UNLESS NOTED OTHERWISE), SCHEDULE 80.
- ELECTRIC SERVICE INSTALLATION, 240/480 VOLT, 1 PHASE, 4 WIRE
- LIGHTING CONTROLLER, POLE MOUNTED, 480 VOLT, 60 AMP

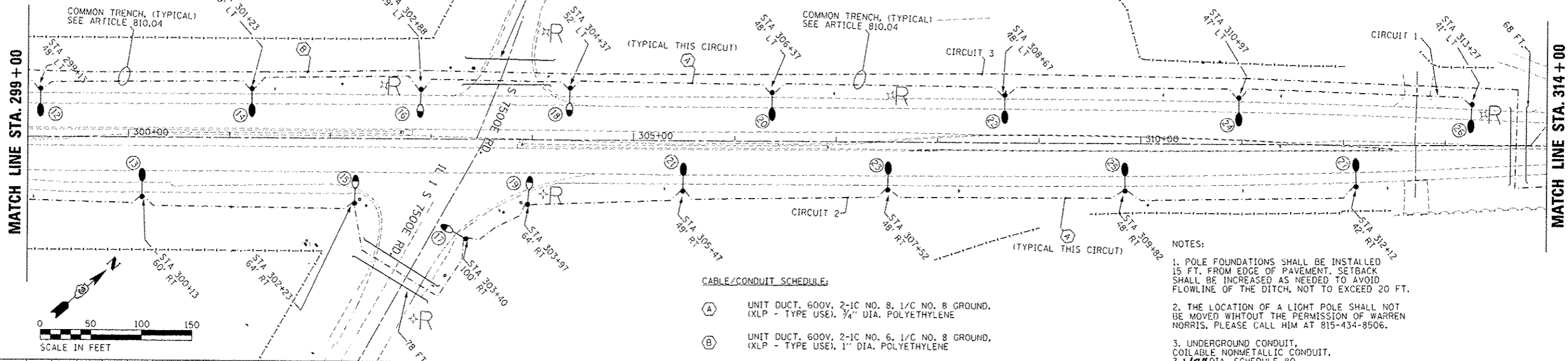

CABLE/CONDUIT SCHEDULE:

- (A) UNIT DUCT, 600V, 2-1C NO. 8, 1/C NO. 8 GROUND, (XLP - TYPE USE), 3/4" DIA. POLYETHYLENE
- (B) UNIT DUCT, 600V, 2-1C NO. 6, 1/C NO. 8 GROUND, (XLP - TYPE USE), 1" DIA. POLYETHYLENE

NOTES:

1. POLE FOUNDATIONS SHALL BE INSTALLED 15 FT. FROM EDGE OF PAVEMENT. SETBACK SHALL BE INCREASED AS NEEDED TO AVOID FLOWLINE OF THE DITCH, NOT TO EXCEED 20 FT.
2. THE LOCATION OF A LIGHT POLE SHALL NOT BE MOVED WITHOUT THE PERMISSION OF WARREN NORRIS, PLEASE CALL HIM AT 815-434-8506.
3. UNDERGROUND CONDUIT, COILABLE NONMETALLIC CONDUIT, 3 1/2" DIA. SCHEDULE 80

| | |
|------|------|
| PLAN | DATE |
| BY | |
| NO. | |
| DATE | |
| NO. | |
| DATE | |
| NO. | |
| DATE | |

| | |
|---------|------|
| PROFILE | DATE |
| BY | |
| NO. | |
| DATE | |
| NO. | |
| DATE | |
| NO. | |
| DATE | |

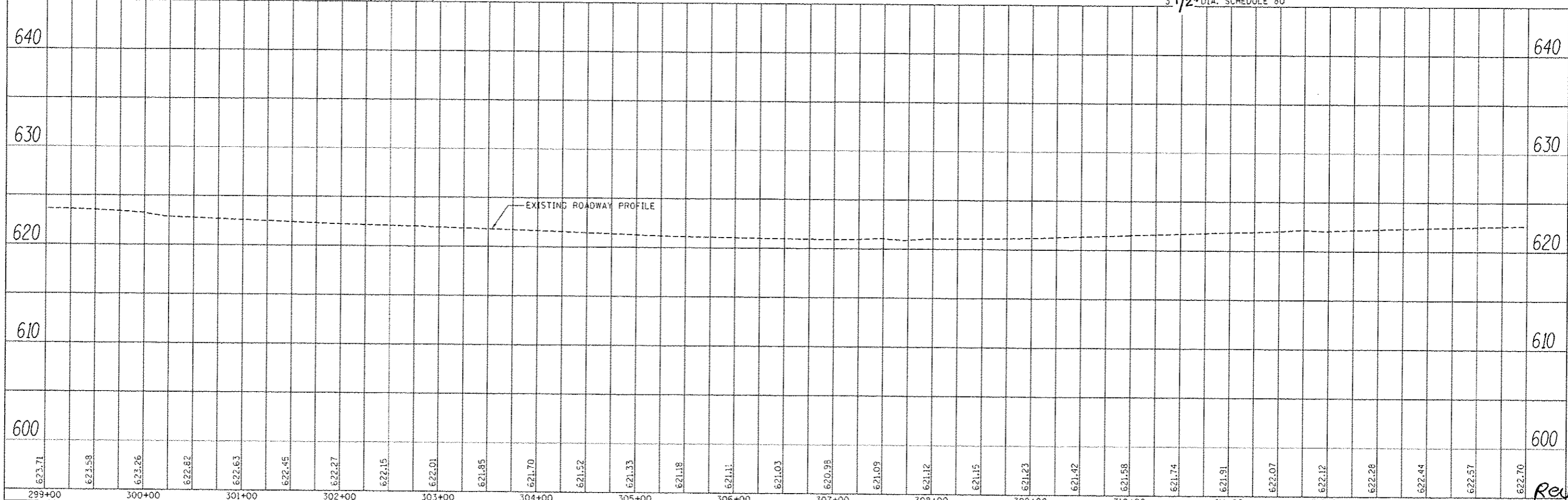

| | | | | | | | | | | | |
|-----------|------------------------------|------------|-----------|---|---------------------------|---------------------------|---------------|----------|--------------|-----------|--|
| FILE NAME | USER NAME = platechr | DESIGNED - | REVISED - | STATE OF ILLINOIS DEPARTMENT OF TRANSPORTATION | PLAN & PROFILE | F.A.P. RTE. | SECTION | COUNTY | TOTAL SHEETS | SHEET NO. | |
| Default | PLOT SCALE = 1/8" = 10' / 1" | CHECKED - | REVISED - | | | 352 | 16, K-15-DL-I | KANKAKEE | 50 | 12 | |
| | PLOT DATE = 12/26/2012 | DATE - | REVISED - | | | CONTRACT NO. 66C14 | | | | | |
| | | | | | | ILLINOIS FED. AID PROJECT | | | | | |

Rev.