

1. CONSTRUCT PROPOSED US 34 PAVEMENT TO TOP OF HMA BINDER COURSE IN STAGE 1. FINAL SURFACE WILL BE APPLIED IN STAGE 3 UNDER TRAFFIC
2. USE TRAFFIC CONTROL AND PROTECTION STANDARD 701331-04 FOR RUN-AROUND DETOUR
3. TEMPORARY PAVEMENT MARKING SHALL BE PLACED TO FORM (2)-12 FT LANES.

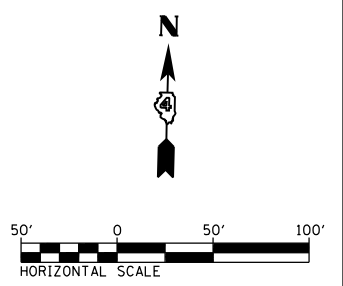

1. USE TRAFFIC CONTROL AND PROTECTION STANDARD 701331-04 FOR RUN-AROUND DETOUR
2. TEMPORARY PAVEMENT MARKING SHALL BE PLACED TO FORM (2)-12 FT LANES.

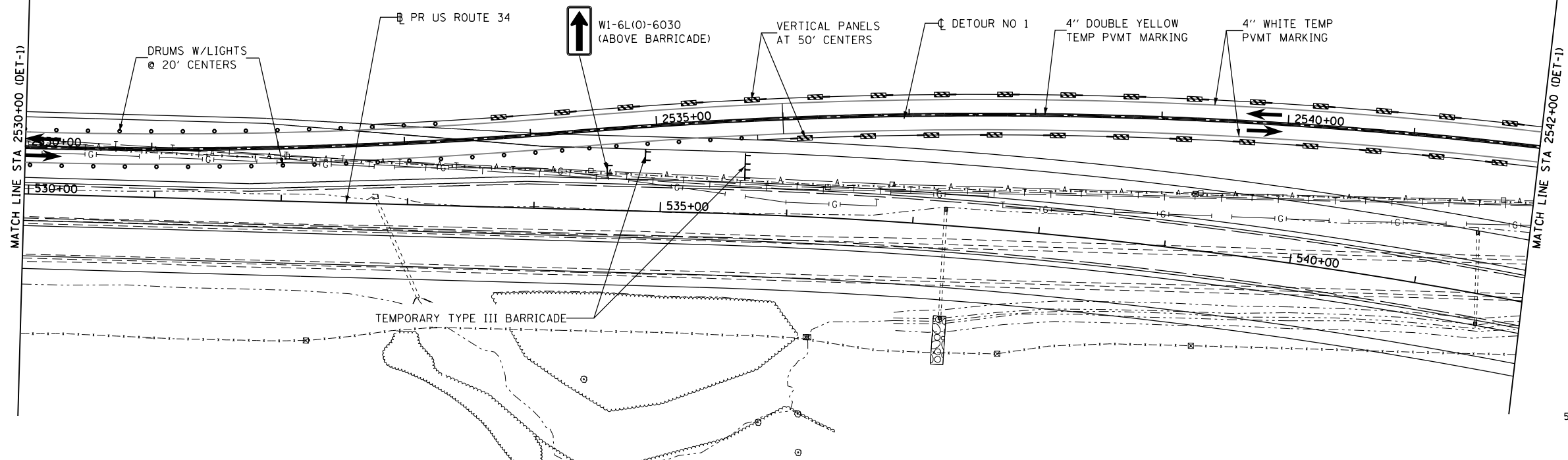
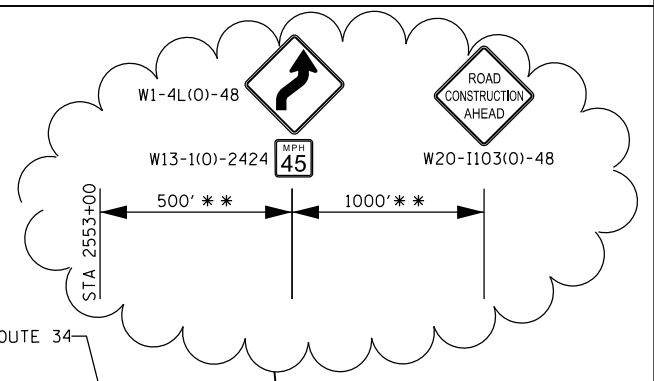
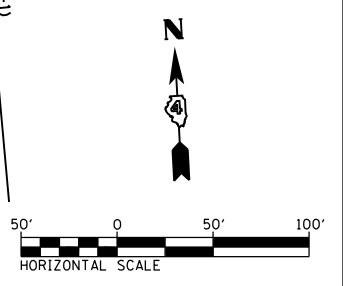
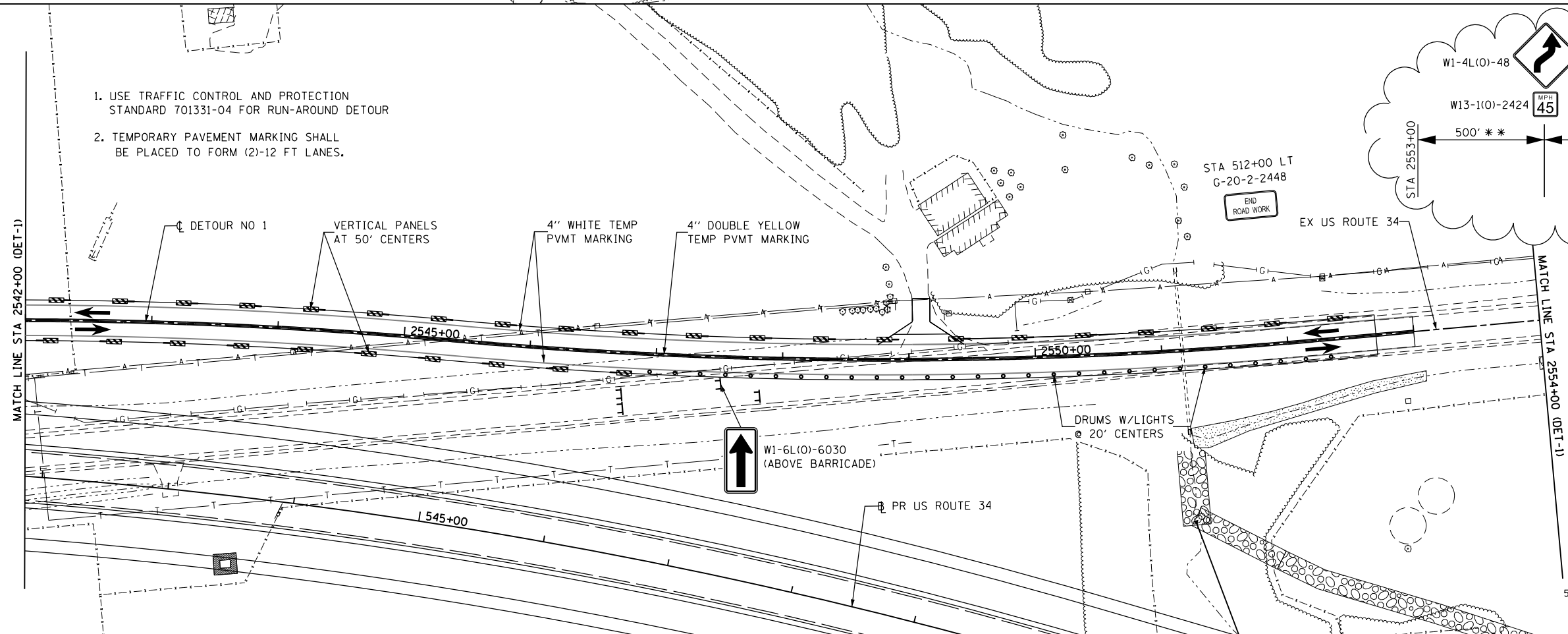

FILE NAME = D468409-SHT-16-STAGE2-DET-1.dgn
 USER NAME = zach1
 PLOT SCALE = 100.0000' / in.
 PLOT DATE = 10/16/2012

DESIGNED - DBS
 DRAWN - PSBA
 CHECKED - CSB
 DATE - 10/2012

REVISED -
 REVISED -
 REVISED -
 REVISED -

**STATE OF ILLINOIS
 DEPARTMENT OF TRANSPORTATION**

**MAINTENANCE OF TRAFFIC
 STAGE 2 - US ROUTE 34 & DETOUR No. 1**

SCALE: 1" = 50' SHEET NO. 16 OF 22 SHEETS STA. 2530+00 TO STA. 2554+00

F.A.P. RTE.	SECTION	COUNTY	TOTAL SHEETS	SHEET NO.
313	7-2; 6-1	HENDERSON	976	217
CONTRACT NO. 68409				
ILLINOIS FED. AID PROJECT				