

- (A) STONE RIPRAP CLASS B3 EROSION PROTECTION L20' X W23'
- (B) STONE RIPRAP CLASS B3 EROSION PROTECTION L20' X W20'
- (C) STONE RIPRAP CLASS B4 L40' X W20'
- (D) STONE RIPRAP CLASS B4 L5' X W25'
- (E) STONE RIPRAP CLASS B3 L16' X W25'
- (F) STONE RIPRAP CLASS B3 L20' X W10'

(21) STA. 663+15 (US 34) SKEW = 4° 21' LA
 181' PRECAST BOX CULVERTS 6' X 4', ASTM C 1577
 DESIGN FILL = 6.1 MIN / 7.5 MAX, PGE = 537 CU YD
 2 BOX CUL END SEC C2
 USFL = 682.55, 663+07.63, 95.00' RT
 DSFL = 680.95, 663+22.37, 97.00' LT

(11) STA. 663+15.00, C (US 34)
 INLET, TYPE A
 WITH MEDIAN INLET (604101)
 GRATE EL = 690.10

SEE SCHEDULE OF QUANTITIES FOR PIPE UNDERDRAIN OUTLETS LOCATION, OFFSET, AND ELEVATION
 SEE PIPE UNDERDRAIN SHEETS FOR UNDERDRAIN PROFILES AND INVERTS AT EDGE OF PAVEMENT

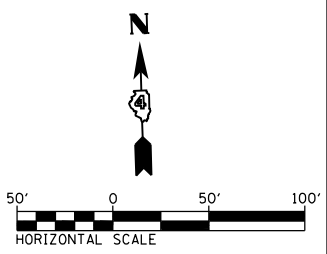
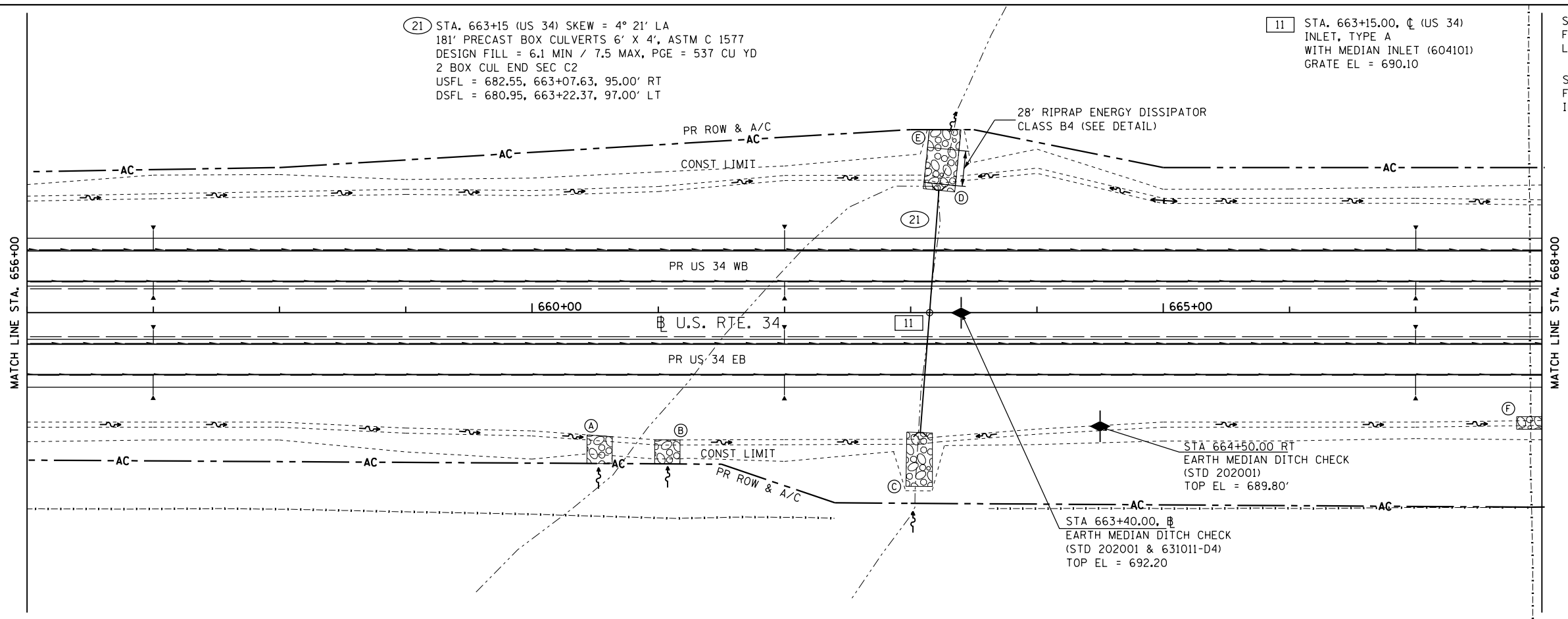

PLAN	SURVEYED	DATE
	PLOTTED	
	ALIGNED	
	CHECKED	
	FILED	
	NO.	

PROFILE	SURVEYED	DATE
	PLOTTED	
	GRADES CHECKED	
	STRUCTURE NOTATIONS OK'D	
	NO.	

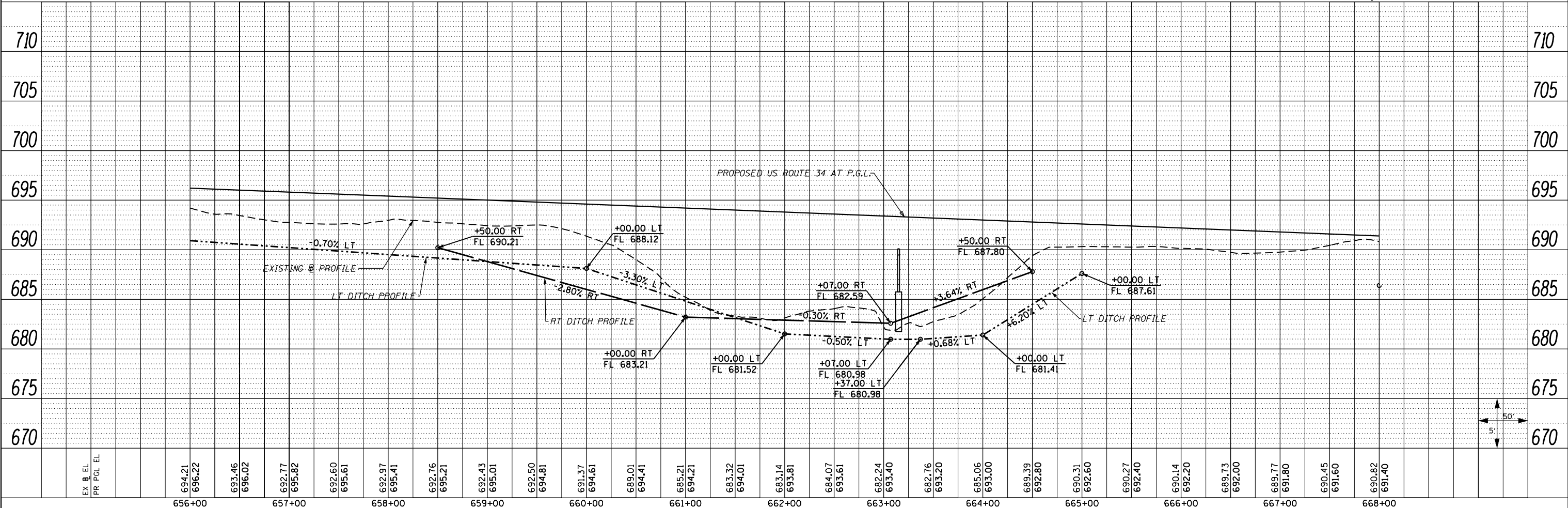

FILE NAME = D:\68409-shd-13-drain-US34-13.dgn	USER NAME = zechl	DESIGNED - DBS	REVISED -	STATE OF ILLINOIS DEPARTMENT OF TRANSPORTATION	DRAINAGE PLAN AND PROFILE US ROUTE 34			F.A.P. RTE. 313	SECTION 7-2 ; 6-1	COUNTY HENDERSON	TOTAL SHEETS 976	SHEET NO. 287	
	PLOT SCALE = 100.0000' / 1"	CHECKED - CSB	REVISED -		SCALE: 1"=50'	SHEET NO. 13 OF 61 SHEETS	STA. 656+00 TO STA. 668+00	CONTRACT NO. 68409		ILLINOIS FED. AID PROJECT			
	PLOT DATE = 10/16/2012	DATE = 10/2012	REVISED -										