

PLAN	SURVEYED	BY	DATE
	PLOTTED		
	ALIGNED		
	CHECKED		
	DESIGNED		
	FILE NAME		
	NO.		

PROFILE	SURVEYED	BY	DATE
	PLOTTED		
	GRADES		
	CHECKED		
	STRUCTURE		
	NOTATION		
	CPAD		
	NO.		

MATCH LINE STA. 24+00 IL 94/116 (1500 E)

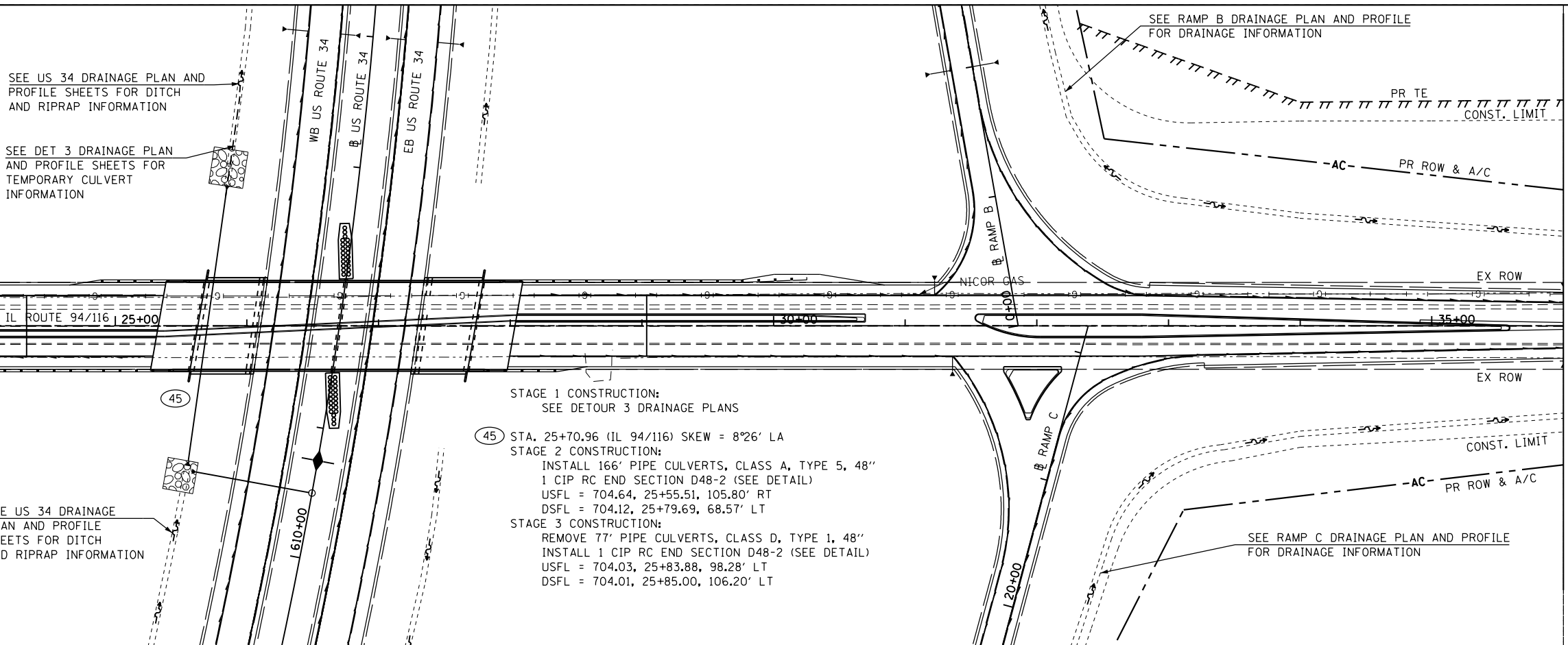

SEE US 34 DRAINAGE PLAN AND PROFILE SHEETS FOR DITCH AND RIPRAP INFORMATION

SEE DET 3 DRAINAGE PLAN AND PROFILE SHEETS FOR TEMPORARY CULVERT INFORMATION

SEE US 34 DRAINAGE PLAN AND PROFILE SHEETS FOR DITCH AND RIPRAP INFORMATION

SEE RAMP B DRAINAGE PLAN AND PROFILE FOR DRAINAGE INFORMATION

SEE SCHEDULE OF QUANTITIES FOR PIPE UNDERDRAIN OUTLETS LOCATION, OFFSET, AND ELEVATION

SEE PIPE UNDERDRAIN SHEETS FOR UNDERDRAIN PROFILES AND INVERTS AT EDGE OF PAVEMENT

MATCH LINE STA. 36+00 IL 94/116 (1500 E)

STAGE 1 CONSTRUCTION:  
SEE DETOUR 3 DRAINAGE PLANS

(45) STA. 25+70.96 (IL 94/116) SKEW = 8°26' LA

STAGE 2 CONSTRUCTION:  
INSTALL 166' PIPE CULVERTS, CLASS A, TYPE 5, 48"  
1 CIP RC END SECTION D48-2 (SEE DETAIL)  
USFL = 704.64, 25+55.51, 105.80' RT  
DSFL = 704.12, 25+79.69, 68.57' LT

STAGE 3 CONSTRUCTION:  
REMOVE 77' PIPE CULVERTS, CLASS D, TYPE 1, 48"  
INSTALL 1 CIP RC END SECTION D48-2 (SEE DETAIL)  
USFL = 704.03, 25+83.88, 98.28' LT  
DSFL = 704.01, 25+85.00, 106.20' LT

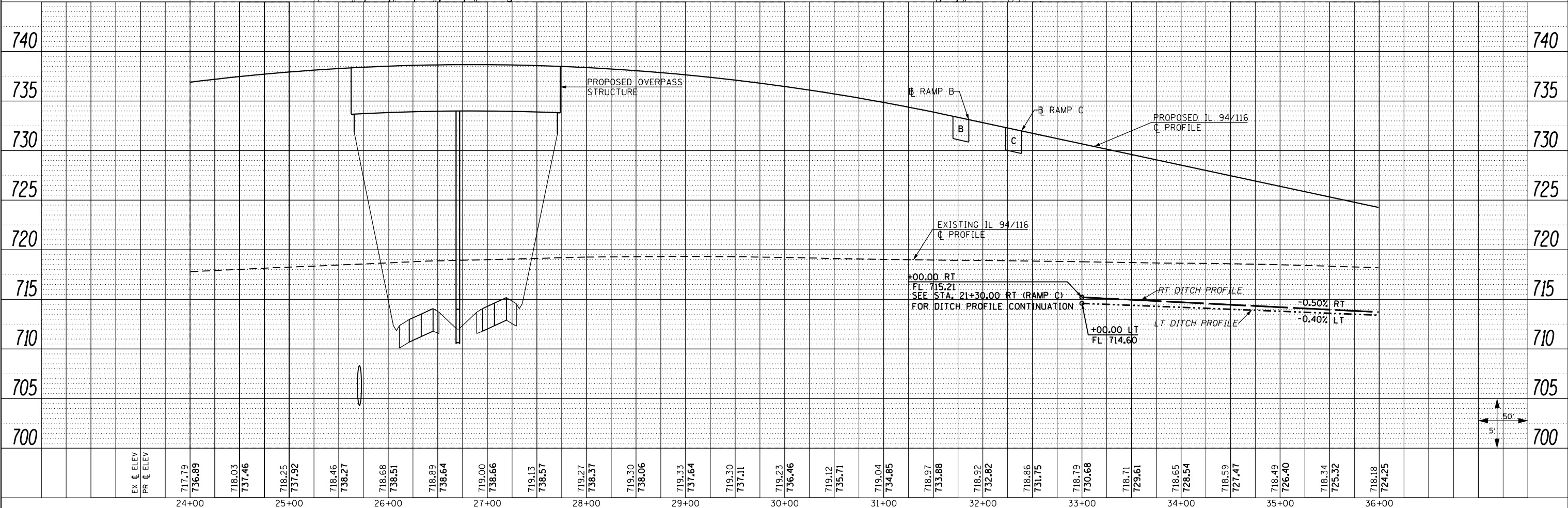
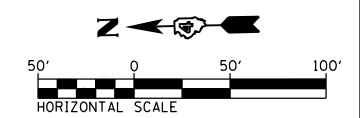

EX ELEV	717.79	718.03	718.25	718.46	718.68	718.89	719.00	719.13	719.27	719.30	719.33	719.30	719.12	719.04	718.97	718.92	718.86	718.79	718.71	718.65	718.59	718.49	718.34	718.18		
PR ELEV	736.89	737.46	737.92	738.27	738.51	738.64	738.66	738.57	738.37	738.06	737.64	737.11	736.46	735.71	734.85	733.88	732.82	731.75	730.68	729.61	727.47	726.40	725.32	724.25		
	24+00	25+00			26+00		27+00		28+00		29+00		30+00		31+00		32+00		33+00		34+00		35+00		36+00	

FILE NAME = 0468409-sh-30-drain-IL94-03.dgn

USER NAME = zachl  
DESIGNED - DBS  
DRAWN - PSBA  
CHECKED - CSB  
DATE - 10/2012

REVISIED -  
REVISIED -  
REVISIED -  
REVISIED -

STATE OF ILLINOIS  
DEPARTMENT OF TRANSPORTATION

DRAINAGE PLAN AND PROFILE  
IL ROUTE 94 /116  
SCALE: 1" = 50'  
SHEET NO. 30 OF 61 SHEETS  
STA. 24+00 TO STA. 36+00

F.A.P. RTE.	SECTION	COUNTY	TOTAL SHEETS	SHEET NO.
313	7-2 ; 6-1	HENDERSON	976	305
CONTRACT NO. 68409				

ILLINOIS FED. AID PROJECT