

DATE	
BY	
SURVEYED	
PLOTTED	
TEMPLATE	
NOTE BOOK	
AREAS CHECKED	
NO.	

DATE	
BY	
SURVEYED	
PLOTTED	
TEMPLATE	
NOTE BOOK	
AREAS CHECKED	
NO.	

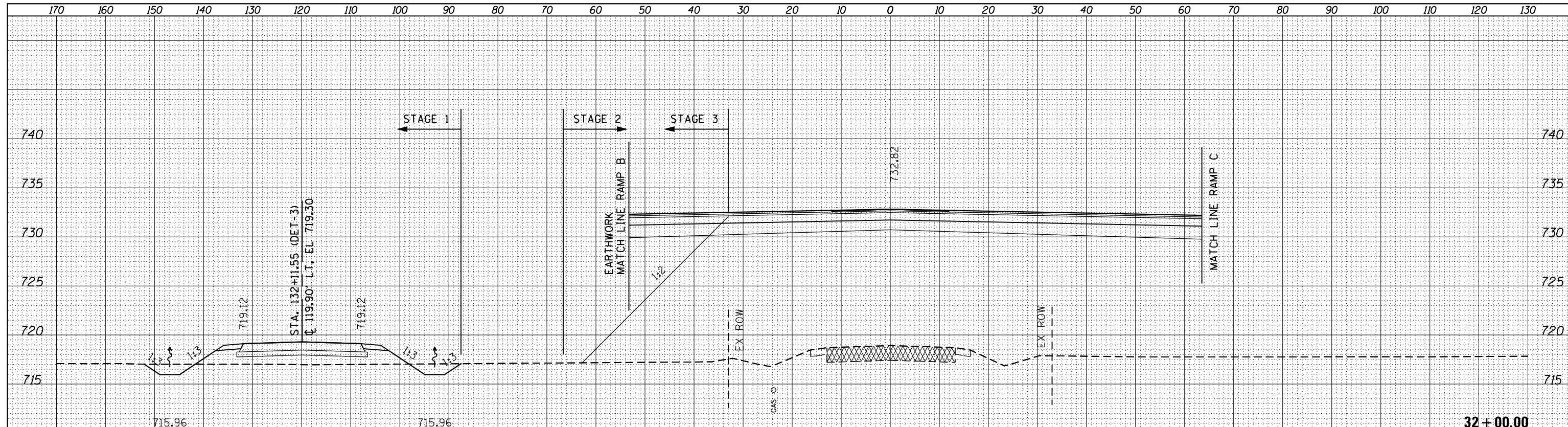

STAGE 1	STAGE 2	STAGE 3
CUT - 16 S.F.	CUT - 0 S.F.	CUT - 0 S.F.
FILL - 55 S.F.	FILL - 467 S.F.	FILL - 87 S.F.
TOPSOIL - 0 S.F.	TOPSOIL - 0 S.F.	TOPSOIL - 0 S.F.
UNSUITABLE - 0 S.F.	UNSUITABLE - 0 S.F.	UNSUITABLE - 0 S.F.

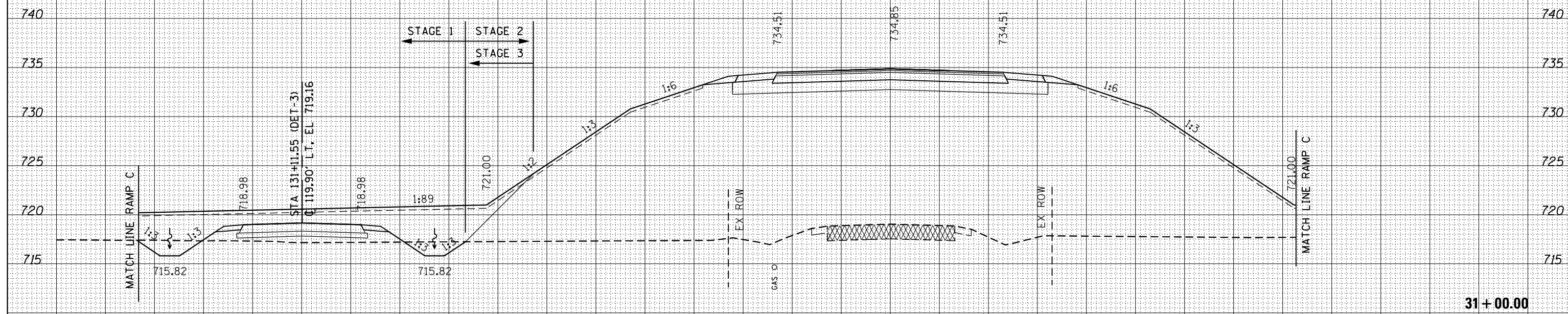

STAGE 1	STAGE 2	STAGE 3
CUT - 25 S.F.	CUT - 0 S.F.	CUT - 0 S.F.
FILL - 39 S.F.	FILL - 2040 S.F.	FILL - 200 S.F.
TOPSOIL - 0 S.F.	TOPSOIL - 27 S.F.	TOPSOIL - 26 S.F.
UNSUITABLE - 0 S.F.	UNSUITABLE - 0 S.F.	UNSUITABLE - 0 S.F.

FILE NAME = D468409-SHT-XSSHT-IL 94-1500E.dgn

USER NAME = zachl	DESIGNED - DBS	REVISED -
	DRAWN - PSBA	REVISED -
PLOT SCALE = 20.0000' / in.	CHECKED - CSB	REVISED -
PLOT DATE = 10/16/2012	DATE - 10/2012	REVISED -

**STATE OF ILLINOIS
DEPARTMENT OF TRANSPORTATION**

**CROSS SECTIONS
IL ROUTE 94 /116**

SCALE: NOTED SHEET NO. 24 OF 33 SHEETS STA. 31+00.00 TO STA. 32+00.00

F.A.P. RTE.	SECTION	COUNTY	TOTAL SHEETS	SHEET NO.
313	7-2 ; 6-1	HENDERSON	976	852
CONTRACT NO. 68409				

ILLINOIS FED. AID PROJECT

