

DATE	
BY	
FINAL SURVEY	SURVEYED
NOTE BOOK	PLOTTED
NO.	TEMPLATE
	AREAS CHECKED

DATE	
BY	
ORIGINAL SURVEY	SURVEYED
NOTE BOOK	PLOTTED
NO.	TEMPLATE
	AREAS CHECKED

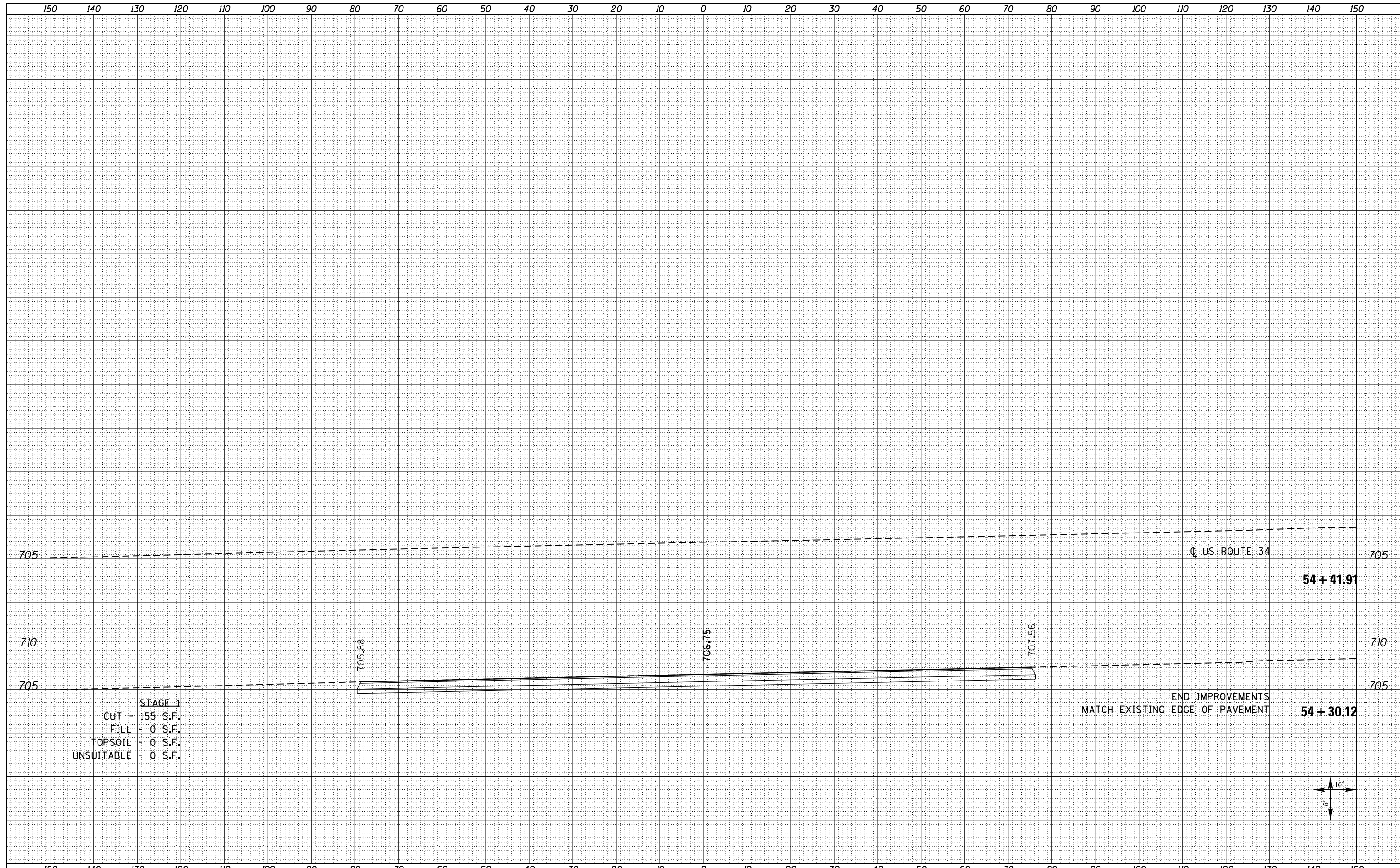

STAGE I  
 CUT - 155 S.F.  
 FILL - 0 S.F.  
 TOPSOIL - 0 S.F.  
 UNSUITABLE - 0 S.F.

END IMPROVEMENTS  
 MATCH EXISTING EDGE OF PAVEMENT

US ROUTE 34



FILE NAME = D468409-SHT-XSHT-TR94-1400E.dgn

USER NAME = zechl	DESIGNED - DBS	REVISED -
	DRAWN - PSBA	REVISED -
PLOT SCALE = 20.0000' / in.	CHECKED - CSB	REVISED -
PLOT DATE = 10/16/2012	DATE - 10/2012	REVISED -

STATE OF ILLINOIS  
 DEPARTMENT OF TRANSPORTATION

CROSS SECTIONS  
 TR 94 (1400 E)

SCALE: NOTED SHEET NO. 11 OF 11 SHEETS STA. 54+30.12 TO STA. 54+41.91

F.A.P. RTE.	SECTION	COUNTY	TOTAL SHEETS	SHEET NO.
313	7-2 ; 6-1	HENDERSON	976	933
CONTRACT NO. 68409				
ILLINOIS FED. AID PROJECT				