

F.A.P. RTE.	SECTION	COUNTY	TOTAL SHEETS	SHEET NO.
322	11-13	CHRISTIAN	437	100
STA.		TO STA.		
FED. ROAD DIST. NO.	ILLINOIS	FED. AID PROJECT		

NE 1/4 SEC 26, T12N, R1E, 3RD PM

PARCEL NO 6069118
GOLDMINE FARMS, INC.
A DELAWARE CORPORATION

19— STA 457+77.0 103.2' LT
PIPE CULVERT, CLASS D, TY 2, 48" Ø, 104'
USFL = 650.73 (457+25.4, 103.1' LT)
DSFL = 650.46 (458+29.4, 103.2' LT)

SEE SHEET 144 FOR INTERSECTION DETAILS

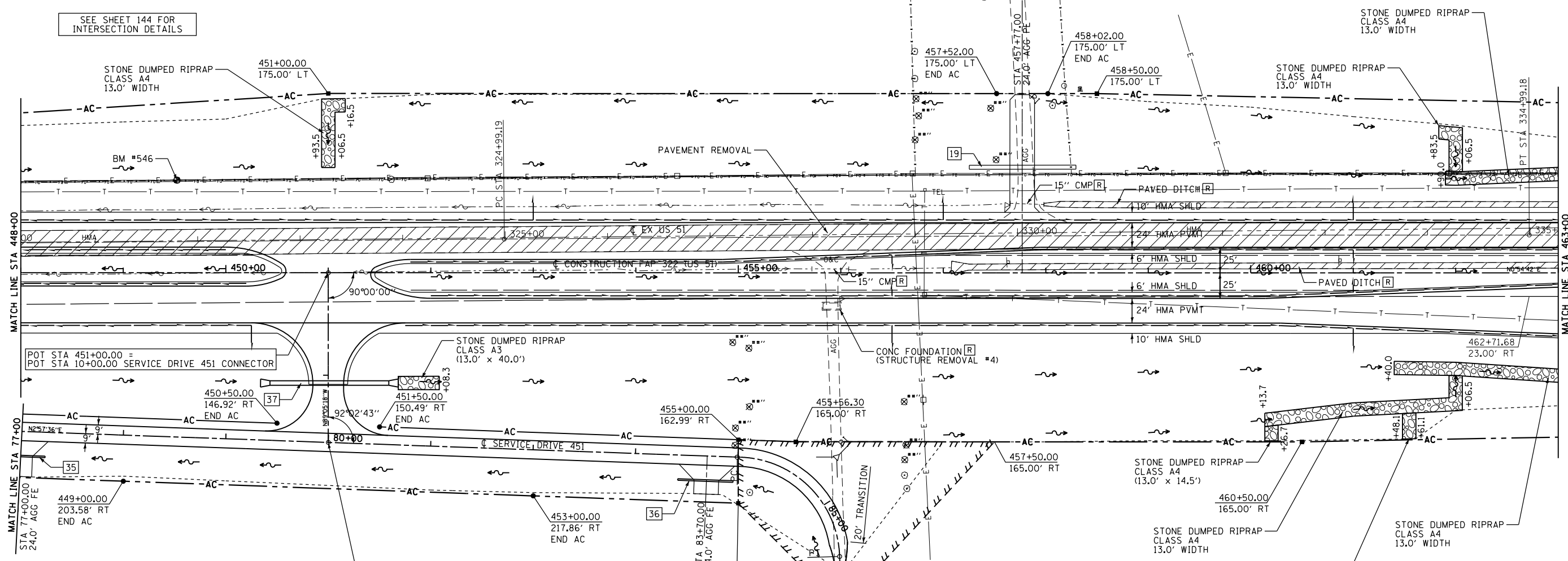

POT STA 451+00.00 =
POT STA 10+00.00 SERVICE DRIVE 451 CONNECTOR

450+50.00 146.92' RT
END AC

451+50.00 150.49' RT
END AC

455+00.00 162.99' RT

455+56.30 165.00' RT

457+00.00 165.00' RT

457+50.00 165.00' RT

460+00.00 165.00' RT

460+50.00 165.00' RT

457+00.00 165.00' RT

460+50.00 165.00' RT

STONE DUMPED RIPRAP CLASS A4 (13.0' x 14.5')

STONE DUMPED RIPRAP CLASS A4 (13.0' x 25.0')

STONE DUMPED RIPRAP CLASS A4 (13.0' x 14.5')

STONE DUMPED RIPRAP CLASS A4 (13.0' x 25.0')

35— STA 77+00.0 24.0' RT
PIPE CULVERT, CLASS D, TY 1, 18" Ø, 50'
USFL = 660.31 (77+24.4, 24.0' RT)
DSFL = 660.00 (76+74.4, 24.0' RT)

37— STA 8+92.3
PIPE CULVERT, CLASS A, TY 2, 54" Ø, 116'
USFL = 653.00 (56.9' LT)
DSFL = 652.76 (59.1' RT)
CONC FLARED END SECTION 54" Ø, 2 EACH
TRENCH BACKFILL, 90.1 CU YD

SERVICE DRIVE 451 CURVE #1 DATA
PI STA. = 84+96.46 =
445+96.15 183.43' RT FAP 322
Δ = 86° 14' 55" (RT)
D = 57° 17' 45"
R = 100.00'
T = 93.66'
L = 150.53'
E = 37.01'
SE = NONE
P.C. STA. = 84+02.81 =
455+02.55 180.09' RT FAP 322
P.T. STA. = 85+53.34 =
455+98.94 277.05' RT FAP 322

END IMPROVEMENT
STA 85+60.00 SERVICE DRIVE 451
455+99.13 283.71' RT FAP 322

36— STA 83+70.0 24.0' RT
PIPE CULVERT, CLASS D, TY 1, 18" Ø, 54'
USFL = 666.97 (83+96.0, 24.0' RT)
DSFL = 666.26 (83+42.0, 24.0' RT)

EX US 51 CURVE #617 DATA
PI STA = 329+99.19
Δ = 0° 27' 58" (RT)
D = 0° 2' 48"
R = 122,929.92'
T = 500.00'
L = 999.99'
E = 1.02'
PC STA = 324+99.19
PT STA = 334+99.18

PARCEL NO 6069117
MICHAEL L. SWINEY

NW 1/4 SEC 25, T12N, R1E, 3RD PM

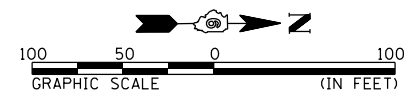

REVISIONS	
NAME	DATE

ILLINOIS DEPARTMENT OF TRANSPORTATION

FAP 322 (US 51)
SECTION 11-13
CHRISTIAN COUNTY

SCALE: DRAWN BY
DATE: CHECKED BY

FAP 322 (US 51) STA 448+00 TO STA 463+00

D:\01\files\010325\1\SO\TH PLANS NEW\CA00_Sheets\05\2\051-sh1-r-plan.dwg 10/26/2012